



# **BUSHFIRE THREAT ASSESSMENT**

**FOR  
A PROPOSED MULTI DWELLING  
DEVELOPMENT AND STRATA TITLE  
SUBDIVISION**

**AT  
28 BLACKETT CLOSE, EAST  
MAITLAND NSW 2320**

Prepared by:

**Firebird ecoSultants Pty Ltd**

ABN – 16 105 985 993

PO Box 354

Newcastle NSW 2300

Mob: 0414 465 990

Ph: 02 4910 3939

Fax: 02 4929 2727

Email: [sarah@firebirdeco.com.au](mailto:sarah@firebirdeco.com.au)



<b>Site Details:</b>	28 Blackett Close, East Maitland NSW 2320
<b>Prepared by:</b>	<b><i>Sarah Jones B.Env.Sc.,G.Dip.DBPA (Design in Bushfire Prone Areas)</i></b> <b><i>Firebird ecoSultants Pty Ltd</i></b> ABN – 16 105 985 993 PO Box 354, Newcastle NSW 2300 M: 0414 465 990 Email: <a href="mailto:sarah@firebirdeco.com.au">sarah@firebirdeco.com.au</a> T: 02 4910 3939 Fax: 02 4929 2727
<b>Prepared for:</b>	Brown Commercial Building
<b>Reference No.</b>	East Maitland – Brown Commercial Building – February 2023
<b>Document Status &amp; Date:</b>	13/02/2023

### Disclaimer

*Notwithstanding the precautions adopted within this report, it should always be remembered that bushfires burn under a wide range of conditions. An element of risk, no matter how small always remains, and although the standard is designed to improve the performance of such buildings, there can be no guarantee, because of the variable nature of bushfires, that any one building will withstand bushfire attack on every occasion.*

## Executive Summary

A Bushfire Threat Assessment Report (BTA) has been prepared by Firebird ecoSultants Pty Ltd at the request of Brown Commercial Building for a proposed multi dwelling development and strata title subdivision at 28 Blackett Close, East Maitland NSW 2320. The report forms part of the supporting documentation for a DA to be submitted to Maitland City Council (MCC).

The report demonstrates compliance with Planning for Bushfire Protection 2019 (NSW RFS, 2019) and AS3959-2018 Construction of Buildings in Bush Fire Prone Areas.

This assessment aims to consider and assess the bushfire hazard and associated potential threats relevant to the proposal. Recommendations are provided with regard to fuel management, access, provision of emergency services, building protection and construction standards to facilitate an acceptable level of bushfire protection.

In summary, the following is recommended to enable the proposal to meet the relevant legislative requirements for the proposed multi dwelling development and strata title subdivision:

- The proposed multi dwelling development has been assessed as BAL-12.5 from all elevations.
- APZs to achieve the above BALs are already established and maintained on site.
- An assessment of the existing access has identified no specific access requirements because the site is in an urban area where an unobstructed path (no greater than 70m) is provided between the most distant external part of the proposed dwelling and the nearest part of the public access road (where the road speed limit is not greater than 70kph) that supports the operational use of emergency firefighting vehicles.
- Fencing – All new fencing and gates shall be constructed in accordance with the NSW Rural Fire Service Guideline: Fast Fact – Fences or Gates in Bushfire Prone Areas.
- Home owners should prepare a Bush Fire Survival Plan refer to the RFS Website [http://www.rfs.nsw.gov.au/file\\_system/attachments/Attachment\\_BushFireSurvivalPlan.pdf](http://www.rfs.nsw.gov.au/file_system/attachments/Attachment_BushFireSurvivalPlan.pdf)

**I certify the development conforms to the relevant specifications and requirements of  
Planning for Bushfire Protection 2019**



Sarah Jones

B.Env.Sc., G.Dip.DBPA (Design for Bushfire Prone Areas)

**FPA BPAD-A Certified Practitioner (Certification Number BPD-26512)**

Ecologist / Bushfire Planner



## Terms & Abbreviations

Abbreviation	Meaning
APZ	Asset Protection Zone
AS2419 -2017	Australian Standard – Fire Hydrant Installations
AS3959-2018	Australian Standard – Construction of Buildings in Bush Fire Prone Areas
BCA	Building Code of Australia
BPA	Bush Fire Prone Area (Also Bushfire Prone Land)
BFPL Map	Bush Fire Prone Land Map
BPMs	Bush Fire Protection Measures
BFSA	Bush Fire Safety Authority
CC	Construction Certificate
<i>EPA Act</i>	<i>NSW Environmental Planning and Assessment Act 1979</i>
FFDI	Forest Fire Danger Index
FMP	Fuel Management Plan
ha	hectare
IPA	Inner Protection Area
LGA	Local Government Area
MCC	Maitland City Council
OPA	Outer Protection Area
PBP	Planning for Bushfire Protection 2019
PoM	Plan of Management
RF Act	Rural Fires Act 1997
RF Regulation	Rural Fires Regulation



## CONTENTS

<b>1</b>	<b>INTRODUCTION</b>	<b>1</b>
1.1	Site Particulars	1
1.2	Description of the Proposal	3
1.3	Legislative Requirements	3
1.4	Objectives of Assessment	3
<b>2</b>	<b>METHODOLOGY</b>	<b>4</b>
2.1	Vegetation Assessment	4
2.2	Slope Assessment	4
<b>3</b>	<b>SITE ASSESSMENT</b>	<b>5</b>
3.1	Vegetation & Slope Assessment	5
<b>4</b>	<b>BUSHFIRE ATTACK ASSESSMENT</b>	<b>6</b>
4.1	Determination of Bushfire Attack Levels	7
<b>5</b>	<b>COMPLIANCE</b>	<b>9</b>
<b>6</b>	<b>CONCLUSION &amp; RECOMMENDATIONS</b>	<b>23</b>
<b>7</b>	<b>BIBLIOGRAPHY</b>	<b>24</b>
<b>APPENDIX A</b>	<b>PROPOSED SITE PLANS</b>	<b>A-1</b>
<b>APPENDIX B</b>	<b>ASSET PROTECTION ZONES</b>	<b>B-1</b>
<b>APPENDIX C</b>	<b>SITE PHOTOS</b>	<b>C-2</b>

## TABLES

Table 3-1: Vegetation Classification	5
Table 4-1: Determination of BALs for the Proposed Multi Dwelling Development	7
Table 5-1: Proposed Multi Dwelling Development Compliance with Development Standards	9
Table 5-2: Proposed Strata Title Subdivision Compliance with Development Standards	15

## FIGURES

Figure 1-1: Site Location	2
Figure 4-1: Vegetation Map	8



# I INTRODUCTION

A Bushfire Threat Assessment Report (BTA) has been prepared by Firebird ecoSultants Pty Ltd at the request of Brown Commercial Building for a proposed multi dwelling development and strata title subdivision at 28 Blackett Close, East Maitland NSW 2320, hereafter referred to as the “site” (refer to Figure 1-1 for site locality). Refer to Appendix A for Proposed Site Plans.

This BTA is suitable for submission with a Development Application (DA) and provides information on measures that will enable the development to comply with ‘Planning for Bushfire Protection’ (NSW RFS, 2019), hereafter referred to as PBP (RFS, 2019).

This assessment aims to consider and assess the bushfire hazard and associated potential threats relevant to such a proposal, and to outline the minimum mitigative measures which would be required in accordance with the provisions of the Environmental Planning and Assessment Amendment (Planning for Bushfire Protection) Regulation 2007 and the Rural Fires Amendment Regulation 2007 (RF Amendment Regulation 2007).

## I.1 Site Particulars

<b>Locality:</b>	28 Blackett Close, East Maitland NSW 2320
<b>LGA:</b>	Maitland City Council
<b>Lot/DP:</b>	Lot 25 in DP243010
<b>Current Land Use:</b>	Vacant lot
<b>Forest Danger Index:</b>	100 FFDI

**Figure 1-1: Site Location**

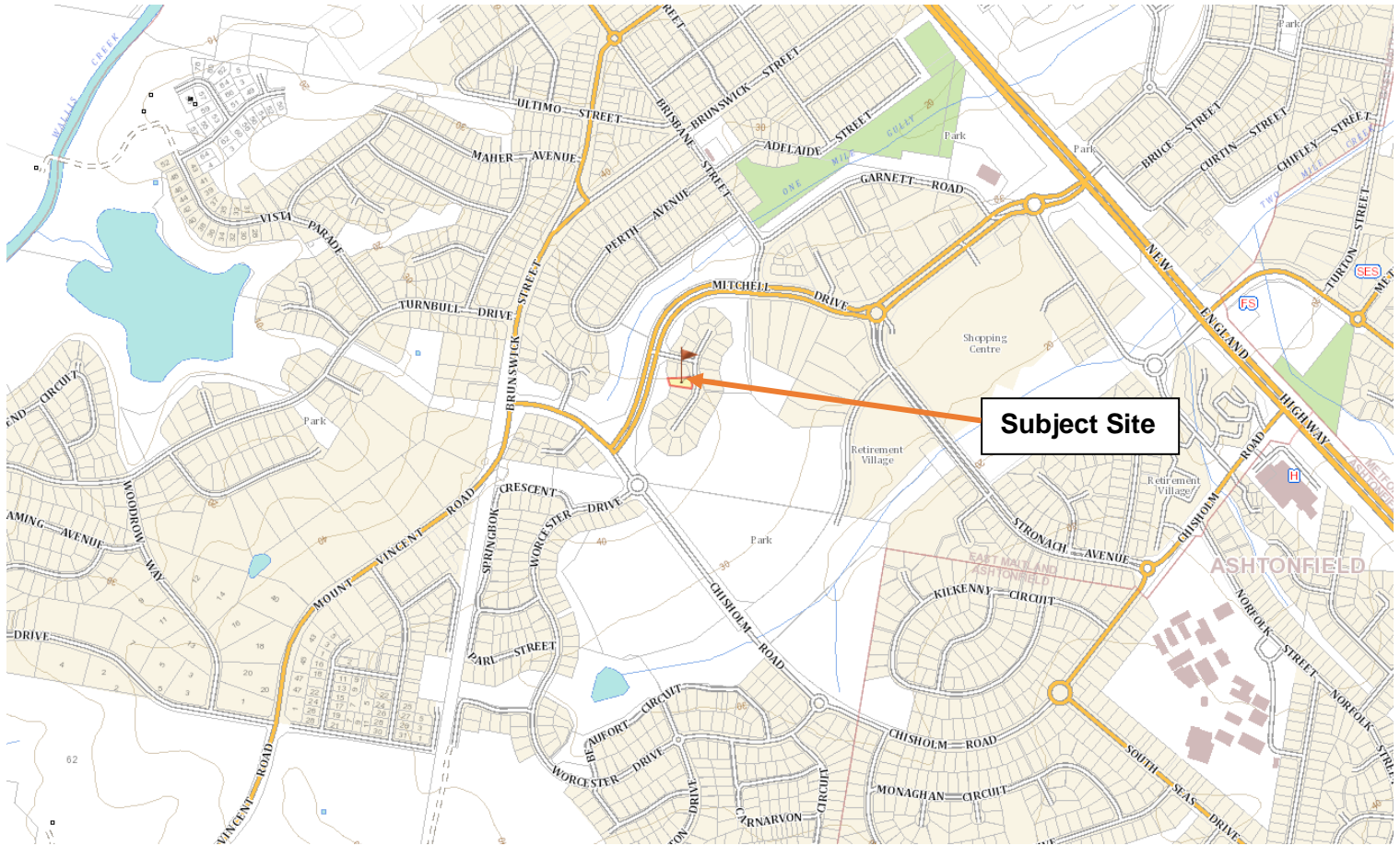



## **I.2 Description of the Proposal**

This DA relates to the proposal for a multi dwelling development and strata title subdivision at 28 Blackett Close, East Maitland NSW 2320. Refer to Appendix A for proposed plans.

## **I.3 Legislative Requirements**

The Site has been mapped as Bush Fire Prone Land Map (BFPLM) by MCC.

This report forms part of the supporting documentation for a Development Application (DA) to be submitted to MCC.

This BTA has been prepared using current legislative requirements and associated guidelines for assessment of bushfire protection, these being:

- PBP (RRS, 2019); and
- AS3959-2018 Construction of Buildings in Bushfire Prone Area.

## **I.4 Objectives of Assessment**

This report has been prepared to address the requirements of Clause 44 of the Rural Fires Regulation. This BTA also addresses the six key Bush Fire Protection Measures (BFRMs) in a development assessment context being:

- The provision of clear separation of buildings and bush fire hazards, in the form of fuel-reduced APZ (and their components being Inner Protection Areas (IPA's) and Outer Protection Areas (OPA's);
- Sitting and design of the proposal;
- Construction standards;
- Appropriate access standards for residents, fire-fighters, emergency workers and those involved in evacuation;
- Adequate water supply and pressure, and utility services; and
- Suitable landscaping, to limit fire spreading to a building.





---

## 2 METHODOLOGY

### 2.1 Vegetation Assessment

Vegetation surveys and vegetation mapping carried out on the site has been undertaken as follows:

- Aerial Photograph Interpretation to map vegetation cover and extent
- Confirmation of the vegetation assemblage typology present.

### 2.2 Slope Assessment

Slope assessment has been undertaken as follows:

- Aerial Photograph Interpretation in conjunction with analysis of electronic contour maps with a contour interval of 2m.



### 3 SITE ASSESSMENT

The following assessment has been undertaken in accordance with the requirements of PBP (RFS, 2019).

#### 3.1 Vegetation & Slope Assessment

In accordance with PBP (RFS 2019), an assessment of the vegetation over a distance of 140m in all directions from the site was undertaken. Vegetation that may be considered a bushfire hazard was identified in all directions from the site. This assessment is depicted in Table 3-1.

In accordance with PBP (RFS 2019), an assessment of the slope underneath the vegetation considered a bushfire hazard was undertaken and the results are presented in Table 3-1 below.

**Table 3-1: Vegetation Classification**

Proposed Multi Dwelling Development and Strata Title Subdivision		
Direction	Vegetation Type <sup>1</sup>	Slope
North	Managed Land	N/A
East	Forest Vegetation	Downslope (0-5°)
South	Managed Land	N/A
West	Managed Land followed by Forest Vegetation	Upslope

<sup>1</sup> Land adjacent to the West of the site is managed land. Refer to Appendix C for photos showing management.



## 4 BUSHFIRE ATTACK ASSESSMENT

Building design and the materials used for construction of future dwellings should be chosen based on the information contained within AS3959-2018, and accordingly the designer / architect should be made aware of this recommendation. It may be necessary to have dwelling plans checked by the architect involved to ensure that the proposed dwellings meet the relevant Bushfire Attack Level (BAL) as detailed in AS3959-2018.

The determinations of the appropriate BAL are based upon parameters such as weather modelling, fire-line intensity, flame length calculations, as well as vegetation and fuel load analysis. The determination of the construction level is derived by assessing the:

- Relevant FFDI = 100
- Flame temperature
- Slope
- Vegetation classification; and
- Building location.

The following BAL, based on heat flux exposure thresholds, are used in the standard:

(a) **BAL – LOW**      The risk is considered to be **VERY LOW**

There is insufficient risk to warrant any specific construction requirements but there are still some risks.

(b) **BAL – 12.5**      The risk is considered to be **LOW**

There is a risk of ember attack.

The construction elements are expected to be exposed to a heat flux not greater than 12.5 kJ/m<sup>2</sup>.

(c) **BAL – 19** The risk is considered to be **MODERATE**

There is a risk of ember attack and burning debris ignited by wind borne embers and a likelihood of exposure to radiant heat.

The construction elements are expected to be exposed to a heat flux not greater than 19 kW/m<sup>2</sup>.

(d) **BAL-29** The risk is considered to be **HIGH**

There is an increased risk of ember attack and burning debris ignited by windborne embers and a likelihood of exposure to an increased level of radiant heat.



The construction elements are expected to be exposed to a heat flux no greater than 29 kW/m<sup>2</sup>.

(e) **BAL-40** The risk is considered to be **VERY HIGH**

There is much increased risk of ember attack and burning debris ignited by windborne embers, a likelihood of exposure to a high level of radiant heat and some likelihood of direct exposure to flames from the fire front.

The construction elements are expected to be exposed to a heat flux no greater than 40 kW/m<sup>2</sup>.

(f) **BAL-FZ** The risk is considered to be **EXTREME**

There is an extremely high risk of ember attack and burning debris ignited by windborne embers, a likelihood of exposure to an extreme level of radiant heat and direct exposure to flames from the fire front.

The construction elements are expected to be exposed to a heat flux greater than 40 kW/m<sup>2</sup>.

#### 4.1 Determination of Bushfire Attack Levels

As the site lies within an LGA designated an FFDI of 100, the information relating to vegetation and slope was applied to Table A1.12.5 of PBP 2019 to determine the appropriate BAL rating. The results from this bush fire risk assessment are detailed below in Table 4-1–Bush Fire Attack Assessment and Figure 4-1 shows the vegetation.

**Table 4-1: Determination of BALs for the Proposed Multi Dwelling Development**

Direction	Vegetation Type	Slope	Separation Distance from Vegetation	Bushfire Attack Level (BAL)
North	Managed Land	N/A	>100m	BAL-12.5
East	Forest Vegetation	Downslope (0-5°)	>65m	BAL-12.5
South	Managed Land	N/A	>100m	BAL-12.5
West	Managed Land followed by Forest Vegetation	Upslope	>65m	BAL-12.5

Given the information in Table 4-1, the proposed multi dwelling development has been assessed as **BAL-12.5**.



Figure 4-1: Vegetation Map





## 5 COMPLIANCE

The proposal is for a multi dwelling development and strata title subdivision and therefore development standards apply. Table 5-1 details the proposed compliance with Development Standards for Infill development.

**Table 5-1: Proposed Multi Dwelling Development Compliance with Development Standards**

Acceptable Solutions	Performance Criteria	Compliance
ASSET PROTECTION ZONES		
› an APZ is provided in accordance with Table A1.12.2 or A1.12.3 in Appendix 1.	› APZs are provided commensurate with the construction of the building; and › A defensible space is provided.	<b>Complies with Acceptable Solution –</b> The entire site is to be managed as an APZ.
› APZs are managed in accordance with the requirements of Appendix 4 of PBP.	› APZs are managed and maintained to prevent the spread of a fire to the building.	<b>Complies with Acceptable Solution –</b> the site is to be managed to the requirements of PBP Appendix 4 (summarised in Appendix B here)
› APZs are wholly within the boundaries of the development site. › APZ are located on lands with a slope less than 18 degrees.	› the APZ is provided in perpetuity. › APZ maintenance is practical, soil stability is not compromised and the potential for crown fires is minimised.	<b>Complies with Acceptable Solution –</b> APZs are on site and do not occur on steep land.
› property access roads are two-wheel drive, all-weather roads.	› firefighting vehicles are provided with safe, all-weather access to structures and hazard vegetation.	<b>Complies with Acceptable Solution –</b> the site has direct access to Blackett Close.
› the capacity of road surfaces and any bridges/causeways is sufficient to carry fully loaded	› the capacity of access roads is adequate for firefighting vehicles.	<b>Complies with Acceptable Solution –</b> Road access is adequate for emergency vehicles.





firefighting vehicles (up to 23 tonnes), bridges and causeways are to clearly indicate load rating.		
<ul style="list-style-type: none"> <li>› hydrants are provided in accordance with the relevant clauses of AS 2419.1:2017;</li> <li>› There is suitable access for a Category 1 fire appliance to within 4m of the static water supply where no reticulated supply is available.</li> </ul>	› there is appropriate access to water supply.	<b>Complies with Acceptable Solution –</b> the site is connected to reticulated water.
<ul style="list-style-type: none"> <li>› at least one alternative property access road is provided for individual dwellings or groups of dwellings that are located more than 200 metres from a public through road;</li> <li>› There are no specific access requirements in an urban area where an unobstructed path (no greater than 70m) is provided between the most distant external part of the proposed dwelling and the nearest part of the public access road (where the road speed limit is not greater than 70kph) that supports the operational use of emergency firefighting vehicles.</li> </ul>	› firefighting vehicles can access the dwelling and exit the property safely.	<b>N/A</b> – the site is adjacent to Blackett Close and as such has an unobstructed path <10m long
<b>WATER SUPPLIES</b>		
<ul style="list-style-type: none"> <li>› reticulated water is to be provided to the development, where available; and</li> <li>› a static water supply is provided where no reticulated water is available.</li> </ul>	› an adequate water supply is provided for firefighting purposes.	<b>Complies with Acceptable Solution –</b> the site is connected to reticulated water



<ul style="list-style-type: none"> <li>› fire hydrant spacing, design and sizing comply with the relevant clauses of AS 2419.1:2017;</li> <li>› hydrants are not located within any road carriageway; and</li> <li>› reticulated water supply to urban subdivisions uses a ring main system for areas with perimeter roads.</li> </ul>	<ul style="list-style-type: none"> <li>› water supplies are located at regular intervals; and</li> <li>› the water supply is accessible and reliable for firefighting operations.</li> </ul>	<b>Complies with Acceptable Solution –</b> a hydrant is located within 70m
<ul style="list-style-type: none"> <li>› fire hydrant flows and pressures comply with the relevant clauses of AS 2419.1:2017.</li> </ul>	<ul style="list-style-type: none"> <li>› flows and pressure are appropriate.</li> </ul>	<b>Complies with Acceptable Solution –</b> Flow and pressure assumed compliant
<ul style="list-style-type: none"> <li>› all above-ground water service pipes external to the building are metal, including and up to any taps.</li> </ul>	<ul style="list-style-type: none"> <li>› the integrity of the water supply is maintained.</li> </ul>	<b>Complies with Acceptable Solution –</b> All above ground pipes will meet the specifications of the acceptable solution
<ul style="list-style-type: none"> <li>› where no reticulated water supply is available, water for firefighting purposes is provided in accordance with Table 5.3d.</li> </ul>	<ul style="list-style-type: none"> <li>› a static water supply is provided for firefighting purposes in areas where reticulated water is not available.</li> </ul>	<b>N/A</b> - the site is connected to reticulated water
<b>ELECTRICITY SERVICES</b>		





<p>› where practicable, electrical transmission lines are underground; and</p> <p>› where overhead, electrical transmission lines are proposed as follows:</p> <ul style="list-style-type: none"><li>○ lines are installed with short pole spacing (30m), unless crossing gullies, gorges or riparian areas; and</li><li>○ no part of a tree is closer to a power line than the distance set out in accordance with the specifications in ISSC3 Guideline for Managing Vegetation Near Power Lines.</li></ul>	<p>› location of electricity services limits the possibility of ignition of surrounding bush land or the fabric of buildings.</p>	<p><b>Complies with Acceptable Solution –</b> Electrical services to the site will meet the requirements of the acceptable solution</p>
GAS SERVICES		



<ul style="list-style-type: none"> <li>› reticulated or bottled gas is installed and maintained in accordance with AS/NZS 1596:2014 and the requirements of relevant authorities, and metal piping is used;</li> <li>› all fixed gas cylinders are kept clear of all flammable materials to a distance of 10m and shielded on the hazard side;</li> <li>› connections to and from gas cylinders are metal;</li> <li>› polymer-sheathed flexible gas supply lines are not used; and</li> <li>› above-ground gas service pipes are metal, including and up to any outlets.</li> </ul>	<ul style="list-style-type: none"> <li>› location and design of gas services will not lead to ignition of surrounding bushland or the fabric of buildings.</li> </ul>	<p><b>Complies with Acceptable Solution –</b> Gas services to the site will meet the requirements of the acceptable solution</p>
<b>CONSTRUCTION STANDARDS</b>		
<ul style="list-style-type: none"> <li>› BAL is determined in accordance with Tables A1.12.5 to A1.12.7; and</li> <li>› construction provided in accordance with the LMCC and as modified by section 7.5 (please see advice on construction in the flame zone).</li> </ul>	<ul style="list-style-type: none"> <li>› the proposed building can withstand bush fire attack in the form of embers, radiant heat and flame contact.</li> </ul>	<p><b>Complies with Acceptable Solution –</b> the site has been assessed as BAL-12.5</p>
<ul style="list-style-type: none"> <li>› fencing and gates are constructed in accordance with section 7.6.</li> </ul>	<ul style="list-style-type: none"> <li>› proposed fences and gates are designed to minimise the spread of bush fire.</li> </ul>	<p><b>Can Comply –</b> Fencing on site will meet the requirements of the acceptable solution</p>
<ul style="list-style-type: none"> <li>› Class 10a buildings are constructed in accordance with section 8.3.2.</li> </ul>	<ul style="list-style-type: none"> <li>› proposed Class 10a buildings are designed to minimise the spread of bush fire.</li> </ul>	<p><b>N/A –</b> the proposed dwelling is not classed as 10a.</p>
<b>LANDSCAPING</b>		



---

<ul style="list-style-type: none"><li>› compliance with the NSW RFS 'Asset protection zone standards' (see Appendix 4);</li><li>› a clear area of low-cut lawn or pavement is maintained adjacent to the house;</li><li>› fencing is constructed in accordance with section 7.6; and</li><li>› trees and shrubs are located so that:<ul style="list-style-type: none"><li>○ the branches will not overhang the roof;</li><li>○ the tree canopy is not continuous; and</li><li>○ any proposed windbreak is located on the elevation from which fires are likely to approach.</li></ul></li></ul>	<ul style="list-style-type: none"><li>› landscaping is designed and managed to minimise flame contact and radiant heat to buildings, and the potential for wind-driven embers to cause ignitions.</li></ul>	<b>Complies with Acceptable Solution –</b> the site is to be managed to the requirements of PBP Appendix 4 (summarised in Appendix B here)
---	---	---



**Table 5-2: Proposed Strata Title Subdivision Compliance with Development Standards**

Acceptable Solutions	Performance Criteria	Compliance
<b>Asset Protection Zones</b>		
› APZs are provided in accordance with Tables A1.12.2 and A1.12.3 based on the FFDI.	potential building footprints must not be exposed to radiant heat levels exceeding 29 kW/m <sup>2</sup> on each proposed lot.	<b>Complies with Acceptable Solution –</b> APZs for the site have been provided in accordance with Table A1.12.2 of PBP 2019.
› APZs are managed in accordance with the requirements of Appendix 4.	APZs are managed and maintained to prevent the spread of a fire towards the building.	<b>Complies with Acceptable Solution –</b> APZs on site are to be managed in accordance with Appendix 4 of PBP 2019.
› APZs are wholly within the boundaries of the development site	the APZs is provided in perpetuity	<b>Complies with Acceptable Solution –</b> APZs are on site.
› APZs are located on lands with a slope less than 18 degrees.	APZ maintenance is practical, soil stability is not compromised and the potential for crown fires is minimised.	<b>Complies with Acceptable Solution –</b> APZs on site occur over land with slope <18°.
<b>Landscaping</b>		
› landscaping is in accordance with Appendix 4; and fencing is constructed in accordance with section 7.6.	landscaping is designed and managed to minimise flame contact and radiant heat to buildings, and the potential for wind-driven embers to cause ignitions.	<b>Complies with Acceptable Solution –</b> All landscaping within the site will meet the requirements of the acceptable solution.
<b>Access (General Requirements)</b>		
› property access roads are two-wheel drive, all-weather roads;	firefighting vehicles are provided with safe, all-weather access to structures.	<b>Complies with Acceptable Solution –</b> all property access roads are to comply with the acceptable solution.
› perimeter roads are provided for residential subdivisions of three or more allotments;		



<ul style="list-style-type: none"><li>› subdivisions of three or more allotments have more than one access in and out of the development;</li><li>› traffic management devices are constructed to not prohibit access by emergency services vehicles;</li><li>› maximum grades for sealed roads do not exceed 15 degrees and an average grade of not more than 10 degrees or other gradient specified by road design standards, whichever is the lesser gradient;</li><li>› all roads are through roads;</li><li>› dead end roads are not recommended, but if unavoidable, are not more than 200 metres in length, incorporate a minimum 12 metres outer radius turning circle, and are clearly sign posted as a dead end;</li><li>› where kerb and guttering is provided on perimeter roads, roll top kerbing should be used to the hazard side of the road;</li><li>› where access/egress can only be achieved through forest, woodland and heath vegetation, secondary access shall be provided to an alternate point on the existing public road system; and</li></ul> <p>one way only public access roads are no less than 3.5 metres wide and have designated parking bays with hydrants</p>		
--	--	--



located outside of these areas to ensure accessibility to reticulated water for fire suppression.		
<ul style="list-style-type: none"> <li>the capacity of perimeter and non-perimeter road surfaces and any bridges/causeways is sufficient to carry fully loaded firefighting vehicles (up to 23 tonnes); bridges/causeways are to clearly indicate load rating.</li> </ul>	the capacity of access roads is adequate for firefighting vehicles.	<b>Complies with Acceptable Solution –</b> All roads within the site are designed to meet the requirements of the acceptable solution.
<ul style="list-style-type: none"> <li>hydrants are located outside of parking reserves and road carriageways to ensure accessibility to reticulated water for fire suppression;</li> <li>hydrants are provided in accordance with the relevant clauses of AS 2419.1:2017 - Fire hydrant installations System design, installation and commissioning; and</li> </ul> <p>there is suitable access for a Category 1 fire appliance to within 4m of the static water supply where no reticulated supply is available.</p>	there is appropriate access to water supply.	<b>Complies with acceptable solution –</b> hydrants are to comply.
<b>Perimeter Roads</b>		
<ul style="list-style-type: none"> <li>are two-way sealed roads;</li> <li>minimum 8m carriageway width kerb to kerb;</li> <li>parking is provided outside of the carriageway width;</li> </ul>	access roads are designed to allow safe access and egress for firefighting vehicles while residents are evacuating as well as providing a safe operational environment for emergency service	<b>N/A –</b> perimeter roads are not required for this development.



<ul style="list-style-type: none"> <li>› hydrants are located clear of parking areas;</li> <li>› are through roads, and these are linked to the internal road system at an interval of no greater than 500m;</li> <li>› curves of roads have a minimum inner radius of 6m;</li> <li>› the maximum grade road is 15 degrees and average grade of not more than 10 degrees;</li> <li>› the road crossfall does not exceed 3 degrees; and</li> </ul> <p style="padding-left: 40px;">a minimum vertical clearance of 4m to any overhanging obstructions, including tree branches, is provided.</p>	<p>personnel during firefighting and emergency management on the interface.</p>	
<h2 style="margin: 0;">Non-Perimeter Roads</h2>		
<ul style="list-style-type: none"> <li>› minimum 5.5m carriageway width kerb to kerb;</li> <li>› parking is provided outside of the carriageway width;</li> <li>› hydrants are located clear of parking areas;</li> <li>› roads are through roads, and these are linked to the internal road system at an interval of no greater than 500m;</li> <li>› curves of roads have a minimum inner radius of 6m;</li> </ul>	<p>access roads are designed to allow safe access and egress for firefighting vehicles while residents are evacuating.</p>	<p><b>N/A</b> – no roads exist as part of the proposal.</p>



<p>› the road crossfall does not exceed 3 degrees; and</p> <p>a minimum vertical clearance of 4m to any overhanging obstructions, including tree branches, is provided.</p>		
<b>Property Access</b>		
<p>› There are no specific access requirements in an urban area where an unobstructed path (no greater than 70m) is provided between the most distant external part of the proposed dwelling and the nearest part of the public access road (where the road speed limit is not greater than 70kph) that supports the operational use of emergency firefighting vehicles.</p> <p><b>In circumstances where this cannot occur, the following requirements apply:</b></p> <p>› minimum 4m carriageway width;</p> <p>› in forest, woodland and heath situations, rural property access roads have passing bays every 200m that are 20m long by 2m wide, making a minimum trafficable width of 6m at the passing bay;</p> <p>› a minimum vertical clearance of 4m to any overhanging obstructions, including tree branches;</p> <p>› provide a suitable turning area in accordance with Appendix 3;</p>	<p>firefighting vehicles can access the dwelling and exit the property safely.</p>	<p><b>Complies with Acceptable Solution –</b></p> <p>All future lots are to be connected to a public road by a driveway &lt;70m.</p>





<ul style="list-style-type: none"> <li>› curves have a minimum inner radius of 6m and are minimal in number to allow for rapid access and egress;</li> <li>› the minimum distance between inner and outer curves is 6m;</li> <li>› the crossfall is not more than 10 degrees;</li> <li>› maximum grades for sealed roads do not exceed 15 degrees and not more than 10 degrees for unsealed roads; and</li> <li>› a development comprising more than three dwellings has access by dedication of a road and not by right of way.</li> </ul> <p><b>Note: Some short constrictions in the access may be accepted where they are not less than 3.5m wide, extend for no more than 30m and where the obstruction cannot be reasonably avoided or removed. The gradients applicable to public roads also apply to community style development property access roads in addition to the above.</b></p>		
Water Supplies		
<ul style="list-style-type: none"> <li>› reticulated water is to be provided to the development where available;</li> <li>› a static water and hydrant supply is provided for non-reticulated developments or where</li> </ul>	adequate water supplies are provided for firefighting purposes.	<b>Complies with Acceptable Solution</b> – all proposed lots are to be connected to reticulated water.



reticulated water supply cannot be guaranteed; and  static water supplies shall comply with Table 5.3d.		
<ul style="list-style-type: none"> <li>› fire hydrant, spacing, design and sizing complies with the relevant clauses of Australian Standard AS 2419.1:2017;</li> <li>› hydrants are not located within any road carriageway; and</li> <li>› reticulated water supply to urban subdivisions uses a ring main system for areas with perimeter roads.</li> </ul>	Water supplies are located at regular intervals; and  the water supply is accessible and reliable for firefighting operations.	<b>Complies with Acceptable Solution</b> – hydrants are to be appropriately located.
<ul style="list-style-type: none"> <li>› fire hydrant flows and pressures comply with the relevant clauses of AS 2419.1:2017.</li> </ul>	flows and pressure are appropriate.	<b>Complies with Acceptable Solution</b> – fire hydrant pressures and flows are assumed to be compliant.
<ul style="list-style-type: none"> <li>› all above-ground water service pipes are metal, including and up to any taps; and</li> </ul> <p>above-ground water storage tanks shall be of concrete or metal.</p>	the integrity of the water supply is maintained.	<b>Complies with Acceptable Solution</b> – All above ground water service pipes will meet the requirements.
<b>Electricity Services</b>		
<ul style="list-style-type: none"> <li>› where practicable, electrical transmission lines are underground;</li> <li>› where overhead, electrical transmission <ul style="list-style-type: none"> <li>› lines are proposed as follows: lines are installed with short pole spacing of</li> </ul> </li> </ul>	location of electricity services limits the possibility of ignition of surrounding bush land or the fabric of buildings.	<b>Complies with Acceptable Solution</b> – All future dwellings are able to meet the requires for electricity services.



<p>30m, unless crossing gullies, gorges or riparian areas; and</p> <p>no part of a tree is closer to a power line than the distance set out in ISSC3 Guideline for Managing Vegetation Near Power Lines.</p>		
<b>Gas Services</b>		
<ul style="list-style-type: none"><li>› reticulated or bottled gas is installed and maintained in accordance with AS/NZS 1596:2014 - The storage and handling of LP Gas, the requirements of relevant authorities, and metal piping is used;</li><li>› all fixed gas cylinders are kept clear of all flammable materials to a distance of 10m and shielded on the hazard side;</li><li>› connections to and from gas cylinders are metal;</li><li>› polymer-sheathed flexible gas supply lines are not used; and</li><li>› above-ground gas service pipes are metal, including and up to any outlets.</li></ul>	<p>location and design of gas services will not lead to ignition of surrounding bushland or the fabric of buildings.</p>	<p><b>Can Complies with Acceptable Solution –</b></p> <p>All future dwellings are able to meet the requirements for gas services.</p>



## 6 CONCLUSION & RECOMMENDATIONS

In summary, a Bushfire Risk Assessment has been undertaken for a proposed multi dwelling development and strata title subdivision at 28 Blackett Close, East Maitland NSW 2320. The report forms part of the supporting documentation for a Development Application (DA) to be submitted to MCC.

If the recommendations contained within this report are duly considered and incorporated, it is considered that the fire hazard present is containable to a level necessary to provide an adequate level of protection to life and property on the subdivision. In summary, the following is recommended to enable the proposal to meet the relevant legislative requirements for the proposed subdivision:

- The proposed multi dwelling development has been assessed as BAL-12.5 from all elevations.
- APZs to achieve the above BALs are already established and maintained on site.
- An assessment of the existing access has identified no specific access requirements because the site is in an urban area where an unobstructed path (no greater than 70m) is provided between the most distant external part of the proposed dwelling and the nearest part of the public access road (where the road speed limit is not greater than 70kph) that supports the operational use of emergency firefighting vehicles.
- Fencing – All new fencing and gates shall be constructed in accordance with the NSW Rural Fire Service Guideline: Fast Fact – Fences or Gates in Bushfire Prone Areas.
- Home owners should prepare a Bush Fire Survival Plan refer to the RFS Website [http://www.rfs.nsw.gov.au/file\\_system/attachments/Attachment\\_Bush\\_FireSurvivalPlan.pdf](http://www.rfs.nsw.gov.au/file_system/attachments/Attachment_Bush_FireSurvivalPlan.pdf)



## 7 BIBLIOGRAPHY

Department of Bush Fire Services (undated). *Bush Fire Readiness Checklist*.

NSWFB (1988). *Hazard Reduction for the Protection of Buildings in Bushland Areas*. New South Wales Fire Brigades.

NSW Rural Fire Service (1997). *Bush Fire Protection for New and Existing Rural Properties*. September 1997, NSW Government.

NSW Rural Fire Service (2006). *Planning for Bushfire Protection – A Guide for Councils, Planners, Fire Authorities, Developers and Home Owners*.

NSW Rural Fire Service (2019). *Planning for Bushfire Protection – A Guide for Councils, Planners, Fire Authorities, Developers and Home Owners*.

NSW Rural Fire Service (2005). Standards for Asset Protection Zones. NSW Rural Fire Service.

NSW Rural Fire Service (2002). *Circular 16/2002: Amendments to the Rural Fires Act 1997 – hazard reduction and planning requirements*.

Planning NSW & NSW Rural Fire Service (2001). *Planning for Bushfire Protection – A Guide for Councils, Planners, Fire Authorities, Developers and Home Owners*.

Ramsay, GC and Dawkins, D (1993). *Building in Bushfire-prone Areas – Information and Advice*. CSIRO and Standards Australia.

*Rural Fires and Environmental Assessment Legislation Amendment Act 2002*.

Standards Australia (2018). *AS 3959 – 2018: Construction of Buildings in Bushfire-prone Areas*.

# APPENDIX A      PROPOSED SITE PLANS



\* WRITTEN DIMENSIONS TO TAKE  
PREFERENCE OVER SCALE

M.G.A.

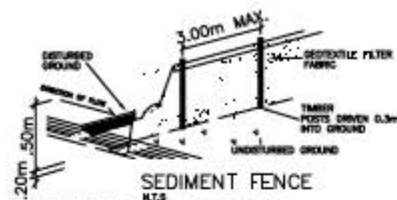

### SEDIMENT CONTROL NOTES

1. ALL EROSION AND SEDIMENTATION CONTROL MEASURES, INCLUDING REVEGETATION AND STORAGE OF SOIL AND TOPSOIL, SHALL BE IMPLEMENTED TO THE STANDARDS OF THE SOIL CONSERVATION OF NSW.
2. ALL DRAINAGE WORKS SHALL BE CONSTRUCTED AND STABILIZED AS EARLY AS POSSIBLE DURING DEVELOPMENT.
3. SEDIMENT TRAPS SHALL BE CONSTRUCTED AROUND ALL INLET PITS, CONSISTING OF 500mm WIDE x 300mm DEEP TRENCH.
4. ALL SEDIMENT BASINS AND TRAPS SHALL BE CLEARED WHEN THE STRUCTURES ARE A MAXIMUM OF 80% FULL OF SOIL MATERIALS, INCLUDING THE MAINTENANCE PERIOD.
5. ALL DISTURBED AREAS SHALL BE REVEGETATED AS SOON AS THE RELEVANT WORKS ARE COMPLETED.
6. SOIL AND TOPSOIL STOCKPILES SHALL BE LOCATED AWAY FROM DRAINAGE LINES AND AREAS WHERE WATER MAY CONCENTRATE.
7. FILTER SHALL BE CONSTRUCTED BY STRETCHING A FILTER FABRIC (TYPICALLY ON APPROVED JOURNALIST BETWEEN POSTS AT 2.0m CENTRES). FABRIC SHALL BE BURIED 150mm ALONG ITS LOWER EDGE.

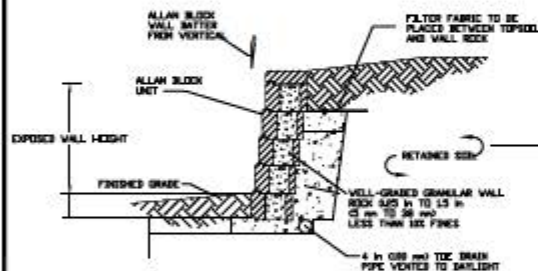

## SITE PLAN

NOTE: ALL GROUND LINES ARE APPROXIMATE. EXTENT OF FILL & BATTER WILL BE DETERMINED ON SITE.

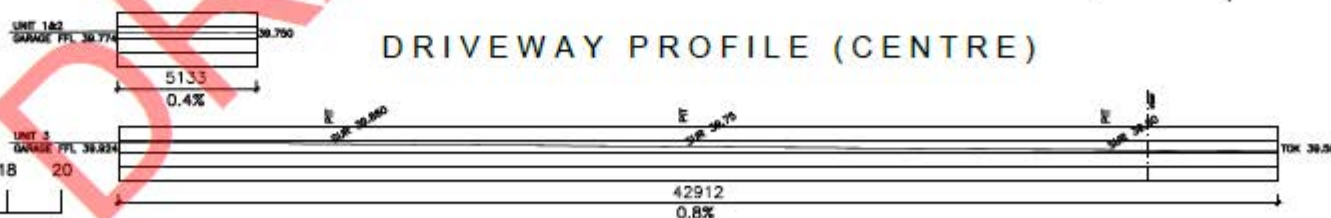

SCALE 1:200 @ A3

## DRIVEWAY PROFILE (CENTRE)



PO Box 948 Maitland NSW 2320 - Tel 0491 021 020 - Email info@urbanliving.com.au  
DESIGNED BY URBANLIVING SOLUTIONS

REV.	DRAWN	DATE	DESCRIPTION	REV.	DRAWN	DATE	DESCRIPTION
1	0.0	00.00.00	ORIGINAL ISSUE				

CLIENT RED McDONALD	DESIGN CUSTOM
SITE ADDRESS LOT 25 DP 243010 28 BLACKETT CLOSE, EAST MAITLAND 2320	SHEET S 03
	REV. 1
	JOB No. 22/126
	SCALE 1:200

## **APPENDIX B      ASSET PROTECTION ZONES**



# APPENDIX 4

## ASSET PROTECTION ZONE REQUIREMENTS

In combination with other BPMS, a bush fire hazard can be reduced by implementing simple steps to reduce vegetation levels. This can be done by designing and managing landscaping to implement an APZ around the property.

Careful attention should be paid to species selection, their location relative to their flammability, minimising continuity of vegetation (horizontally and vertically), and ongoing maintenance to remove flammable fuels (leaf litter, twigs and debris).

This Appendix sets the standards which need to be met within an APZ.

### A4.1 Asset Protection Zones

An APZ is a fuel-reduced area surrounding a building or structure. It is located between the building or structure and the bush fire hazard.

For a complete guide to APZs and landscaping, download the NSW RFS document *Standards for Asset Protection Zones* at the NSW RFS Website [www.rfs.nsw.gov.au](http://www.rfs.nsw.gov.au).

An APZ provides:

- a buffer zone between a bush fire hazard and an asset;
- an area of reduced bush fire fuel that allows for suppression of fire;
- an area from which backburning or hazard reduction can be conducted; and
- an area which allows emergency services access and provides a relatively safe area for firefighters and home owners to defend their property.

Bush fire fuels should be minimised within an APZ. This is so that the vegetation within the zone does not provide a path for the spread of fire to the building, either from the ground level or through the tree canopy.

An APZ, if designed correctly and maintained regularly, will reduce the risk of:

- direct flame contact on the building;
- damage to the building asset from intense radiant heat; and
- ember attack.

The methodology for calculating the required APZ distance is contained within Appendix 1. The width of the APZ required will depend upon the development type and bush fire threat. APZs for new development are set out within Chapters 5, 6 and 7 of this document.

In forest vegetation, the APZ can be made up of an Inner Protection Area (IPA) and an Outer Protection Area (OPA).

**Figure A4.1**

Typical Inner and Outer Protection Areas.

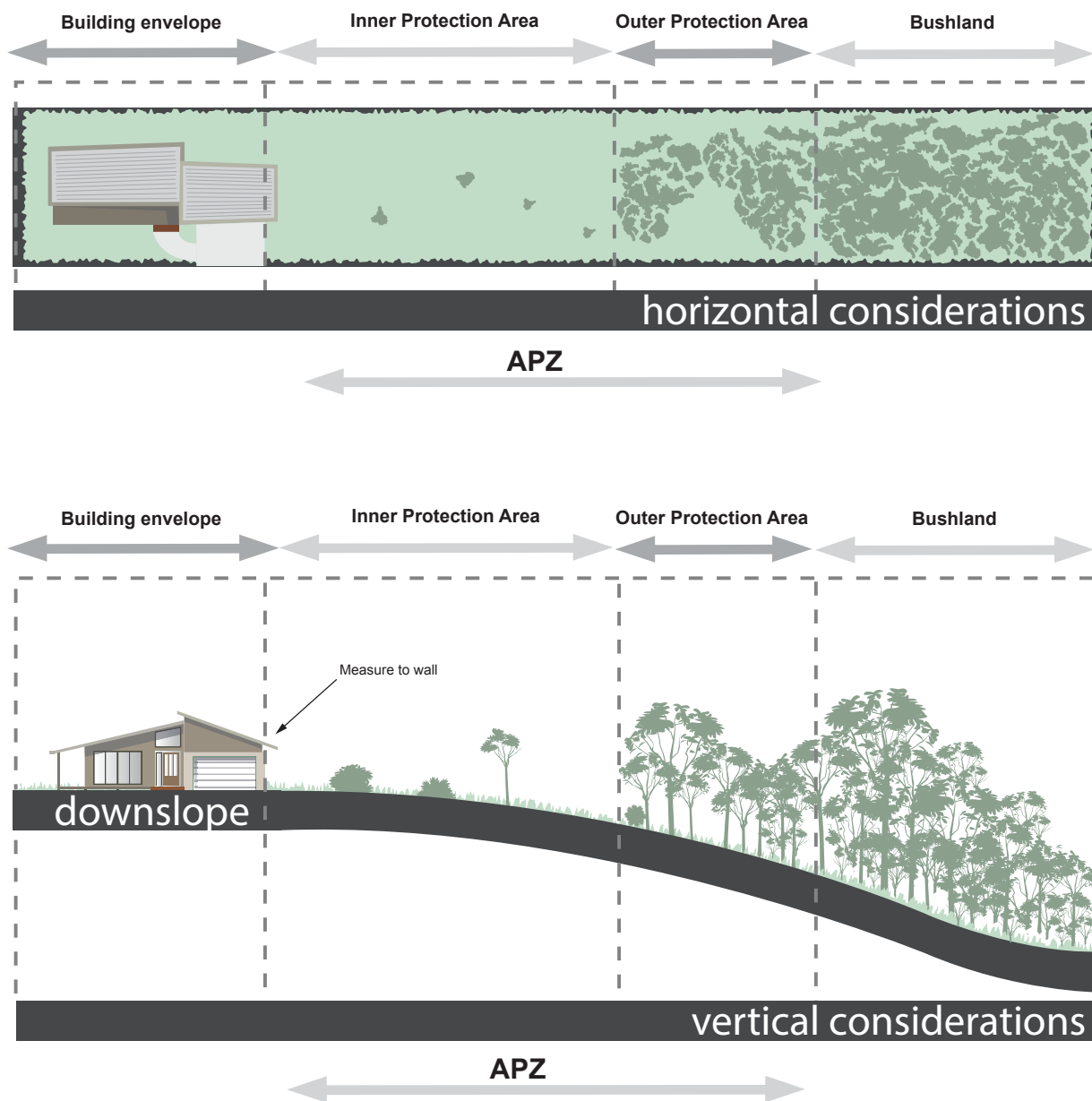

#### A4.1.1 Inner Protection Areas (IPAs)

The IPA is the area closest to the building and creates a fuel-managed area which can minimise the impact of direct flame contact and radiant heat on the development and act as a defensible space. Vegetation within the IPA should be kept to a minimum level. Litter fuels within the IPA should be kept below 1cm in height and be discontinuous.

In practical terms the IPA is typically the curtilage around the building, consisting of a mown lawn and well maintained gardens.

When establishing and maintaining an IPA the following requirements apply:

##### Trees

- tree canopy cover should be less than 15% at maturity;
- trees at maturity should not touch or overhang the building;
- lower limbs should be removed up to a height of 2m above the ground;
- tree canopies should be separated by 2 to 5m; and
- preference should be given to smooth barked and evergreen trees.

##### Shrubs

- create large discontinuities or gaps in the vegetation to slow down or break the progress of fire towards buildings should be provided;
- shrubs should not be located under trees;
- shrubs should not form more than 10% ground cover; and
- clumps of shrubs should be separated from exposed windows and doors by a distance of at least twice the height of the vegetation.

##### Grass

- grass should be kept mown (as a guide grass should be kept to no more than 100mm in height); and
- leaves and vegetation debris should be removed.

#### A4.1.2 Outer Protection Areas (OPAs)

An OPA is located between the IPA and the unmanaged vegetation. It is an area where there is maintenance of the understorey and some separation in the canopy. The reduction of fuel in this area aims to decrease the intensity of an approaching fire and restricts the potential for fire spread from crowns; reducing the level of direct flame, radiant heat and ember attack on the IPA.

Because of the nature of an OPA, they are only applicable in forest vegetation.

When establishing and maintaining an OPA the following requirements apply:

##### Trees

- tree canopy cover should be less than 30%; and
- canopies should be separated by 2 to 5m.

##### Shrubs

- shrubs should not form a continuous canopy; and
- shrubs should form no more than 20% of ground cover.

##### Grass

- grass should be kept mown to a height of less than 100mm; and
- leaf and other debris should be removed.

An APZ should be maintained in perpetuity to ensure ongoing protection from the impact of bush fires. Maintenance of the IPA and OPA as described above should be undertaken regularly, particularly in advance of the bush fire season.



## APPENDIX C      SITE PHOTOS



**Photo 1: Managed Vegetation to the West of the site on Mitchell Drive, facing South**





**Photo 2: Managed Vegetation adjacent to the site on Mitchell Drive, facing South-East**





**Photo 3: Managed Vegetation to the West along Mitchell Drive, facing South-East**