

BEFORE
YOU DIG
www.bydda.com.au

1. REFER TO SHEET 1021 FOR LEGEND
2. REFER TO EXISTING UTILITY PLANS FOR UTILITY LOCATIONS AND IMPACTS
3. REFER TO SHEETS C1111 TO C1114 FOR ROAD LONGITUDINAL SECTIONS
4. REFER TO SHEET C1211 TO C1219 FOR DRAINAGE PROFILES
5. REFER TO EDGE DETAIL 7.8, 15, & 16 FOR SUBSOIL LOCATION IN SHARED STORMWATER TRENCH UNDER ALL KERBS AND MEDIANS AS REQUIRED.

UTILITY INFORMATION SHOWN ON THESE PLANS DOES NOT DEPICT ANY MORE THAN THE PRESENCE OF A SERVICE, BASED ON AVAILABLE DOCUMENTARY EVIDENCE. RELEVANT UTILITY PLANS ARE TO BE OBTAINED FROM BEFORE YOU DIG AUSTRALIA, AND THE PRESENCE OF A UTILITY SERVICE, SIZE AND LOCATION, TO BE CONFIRMED BY FIELD INSPECTION PRIOR TO THE COMMENCEMENT OF WORKS. CAUTION SHOULD BE EXERCISED WHEN WORKING IN THE VICINITY OF ALL UTILITY SERVICES.

PLAN
SCALE 1:500

CONSTRUCTION

[illegible]

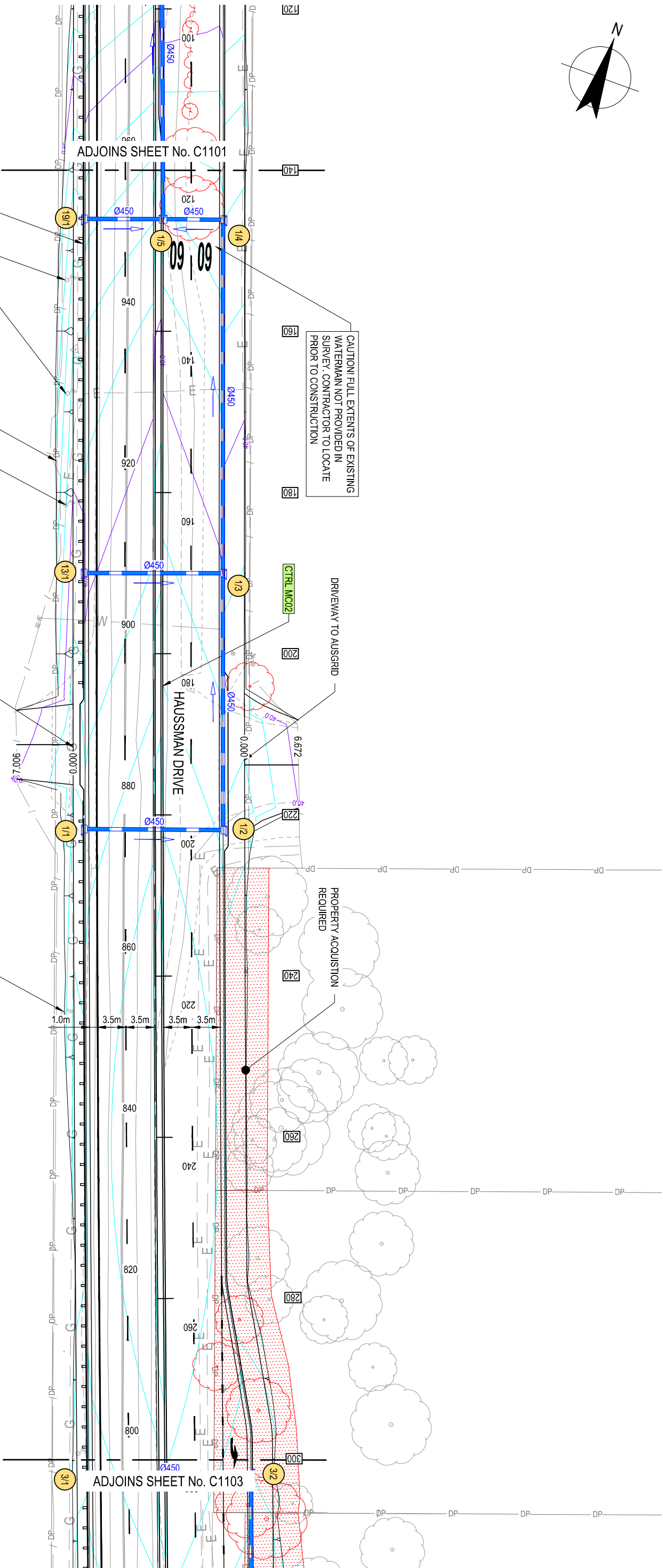
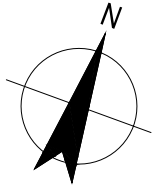

- NOTE**
1. REFER TO SHEET 1021 FOR LEGEND
 2. REFER TO EXISTING UTILITY PLANS FOR UTILITY LOCATIONS AND IMPACTS
 3. REFER TO SHEETS C1111 TO C1114 FOR ROAD LONGITUDINAL SECTIONS
 4. REFER TO SHEET C1211 TO C1219 FOR DRAINAGE PROFILES
 5. REFER TO EDGE DETAIL 7.8.15 & 16 FOR SUBSOIL LOCATION IN SHARED STORMWATER TRENCH UNDER ALL KERBS AND MEDIANS AS REQUIRED.
- FILL REQUIRED AROUND EXISTING ELECTRICAL POSTS. CONTRACTOR TO LAISE WITH AUSGRID PRIOR TO CONSTRUCTION.
- LOCALLY STEEPEN BATTER AS REQUIRED TO CONTAIN WORKS WITHIN ROAD CORRIDOR.
- FILL REQUIRED AROUND EXISTING ELECTRICAL POSTS. CONTRACTOR TO LAISE WITH AUSGRID PRIOR TO CONSTRUCTION.

UTILITY INFORMATION SHOWN ON THESE PLANS DOES NOT DEPICT ANY MORE THAN THE PRESENCE OF A SERVICE, BASED ON AVAILABLE DOCUMENTARY EVIDENCE. RELEVANT UTILITY PLANS ARE TO BE OBTAINED FROM BEFORE YOU DIG AUSTRALIA AND THE PRESENCE OF A UTILITY SERVICE, SIZE AND LOCATION TO BE CONFIRMED BY FIELD INSPECTION PRIOR TO THE COMMENCEMENT OF WORKS. CAUTION SHOULD BE EXERCISED WHEN WORKING IN THE VICINITY OF ALL UTILITY SERVICES.

PLAN
SCALE 1:500

CONSTRUCTION

0	FOR CONSTRUCTION	JM	GM	AS	16.04.24
No	Revision	Note:	Indicates signatures on original issue of drawing or last revision of drawing		

SCALE 1:500 AT ORIGINAL SIZE

GHD Tower, Level 3 24 Homestead Drive
Newcastle NSW 2300 Australia
P 61 2 4879 9999
F 61 2 4879 9998
E info@ghd.com
W www.ghd.com

DO NOT SCALE			
Xref GHD_11031_GHD.dwg	Drawn	J.MAATOM	Designer
Conditions of Use: This document may only be used by GHD's client (and any other person who GHD's client has authorised) for the purposes for which it was prepared and must not be used by any other person or for any other purpose.	Design	N.HINCKS	Check
Approved (Project Director) Date 16.04.24	Design	A.SNEDDON	Check

Client
Project
Title

MAITLAND CITY COUNCIL
HAUSSMAN DRIVE - STAGE 2
DETAIL PLAN
SHEET 2 OF 5

Original Size
Drawing No:
Rev:

A3
22-12542622-C1102
0

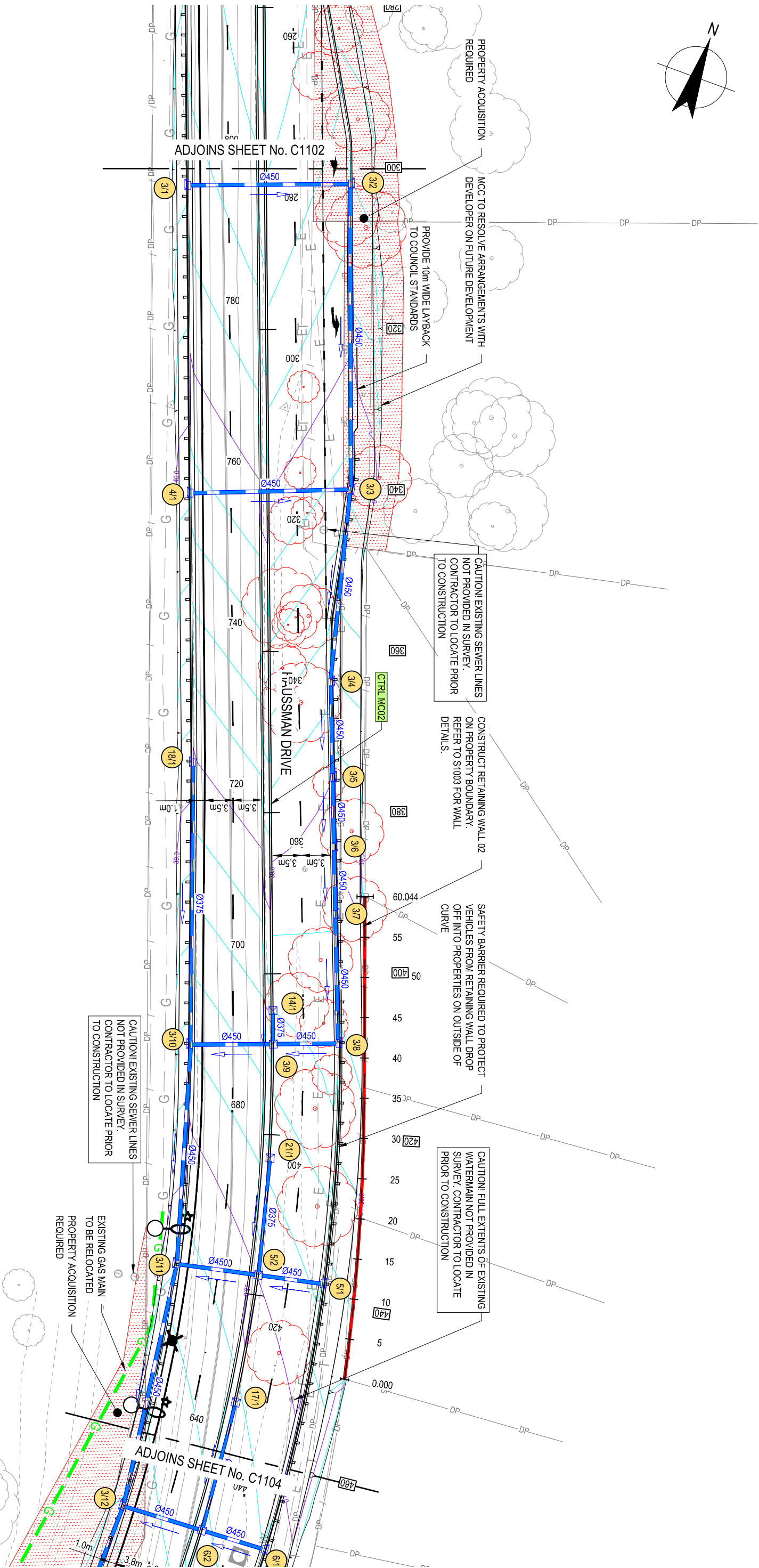
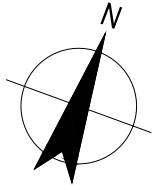

NOTE

1. REFER TO SHEET 1021 FOR LEGEND
2. REFER TO EXISTING UTILITY PLANS FOR UTILITY LOCATIONS AND IMPACTS
3. REFER TO SHEETS C1111 TO C1114 FOR ROAD LONGITUDINAL SECTIONS
4. REFER TO SHEET C1211 TO C1219 FOR DRAINAGE PROFILES
5. REFER TO EDGE DETAIL 7.8.15 & 16 FOR SUBSOIL LOCATION IN SHARED STORMWATER TRENCH UNDER ALL KERBS AND MEDIANS AS REQUIRED.



UTILITY INFORMATION SHOWN ON THESE PLANS DOES NOT DEPICT ANY MORE THAN THE PRESENCE OF A SERVICE, BASED ON AVAILABLE DOCUMENTARY EVIDENCE. RELEVANT UTILITY PLANS ARE TO BE OBTAINED FROM BEFORE YOU DIG AUSTRALIA AND THE PRESENCE OF A UTILITY SERVICE, SIZE AND LOCATION TO BE CONFIRMED BY FIELD INSPECTION PRIOR TO THE COMMENCEMENT OF WORKS. CAUTION SHOULD BE EXERCISED WHEN WORKING IN THE VICINITY OF ALL UTILITY SERVICES.

PLAN
SCALE 1:500

CONSTRUCTION

0	FOR CONSTRUCTION	JM	GM	AS	16.04.24
No	Revision	Note:	Indicates signatures on original issue of drawing or last revision of drawing	Drawn	Manager

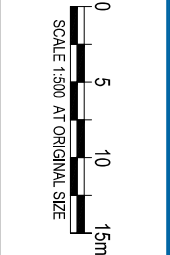

GHD
GHD Tower, Level 3/24 Homestead Drive
Newcastle NSW 2300 Australia
P 61 2 4279 9999
F 61 2 4279 9998
E info@ghd.com
W www.ghd.com

DO NOT SCALE			
Xref GHD_1031_GH.LWG	Drawn	J.MAYTOM	Designer N.HINCKS
Conditions of Use: This document may only be used by GHD's client (and any other person who GHD has authorised) for the purpose for which it was prepared and must not be used by any other person or for any other purpose.	Drafting Checked	B.DREW	Design Checked
Approved (Project Director)	Date	16.04.24	Scale
			AS SHOWN

Client	Maitland City Council
Project	HAUSSMAN DRIVE - STAGE 2
Title	DETAIL PLAN SHEET 3 OF 5
Original Size	A3
Drawing No:	22-12542622-C1103
Rev:	0

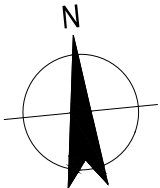

COUNCIL TO RESOLVE REAR ACCESS
REQUIREMENTS TO EXISTING
PROPERTY PRIOR TO CONSTRUCTION

LOCALLY ADJUST BATTER
AS REQUIRED TO AVOID
PROPERTY IMPACT

TRANSITION TO ROLL
KERB OVER 3m PRIOR
TO LIMIT OF WORKS

EXISTING ELECTRICAL
TO BE RELOCATED

TRANSITION TO SM KERB
FOR PEDESTRIAN REFUGE

ADJOINS SHEET No. C1103

ADJOINS SHEET No. C1105

NOTE

1. REFER TO SHEET 1021 FOR LEGEND
2. REFER TO EXISTING UTILITY PLANS FOR UTILITY LOCATIONS AND IMPACTS
3. REFER TO SHEETS C1111 TO C1114 FOR ROAD LONGITUDINAL SECTIONS
4. REFER TO SHEET C1211 TO C1219 FOR DRAINAGE PROFILES
5. REFER TO EDGE DETAIL 7.8.15 & 16 FOR SUBSOIL LOCATION IN SHARED STORMWATER TRENCH UNDER ALL KERBS AND MEDIANS AS REQUIRED.

CAUTION! EXISTING SEWER LINES
NOT PROVIDED IN SURVEY.
CONTRACTOR TO LOCATE PRIOR
TO CONSTRUCTION

EXISTING GAS MAIN
TO BE RELOCATED.

PROPERTY ACQUISITION
REQUIRED.

INDICATIVE UNDERGROUND ELECTRICAL
ALIGNMENT. DESIGN TO BE UPDATED TO
SUIT STORMWATER DRAINAGE NETWORK.

PROPOSED GAS REALIGNMENT TO
BE CONSTRUCTED WITH REQUIRED
AUTHORITY DESIGN SEPARATION

BATTER TO EXISTING AT 1:4 IF WORKS
CONSTRUCTED PRIOR TO DEVELOPMENT

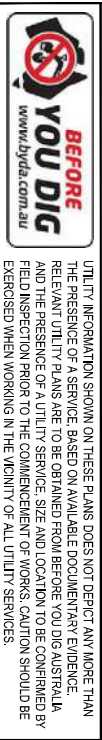

UTILITY INFORMATION SHOWN ON THESE PLANS DOES NOT DEFECT ANY MORE THAN
THE PRESENCE OF A SERVICE, BASED ON AVAILABLE DOCUMENTARY EVIDENCE.
RELEVANT UTILITY PLANS ARE TO BE OBTAINED FROM BEFORE YOU DIG AUSTRALIA
AND THE PRESENCE OF A UTILITY SERVICE, SIZE AND LOCATION TO BE CONFIRMED BY
FIELD INSPECTION PRIOR TO THE COMMENCEMENT OF WORKS. CAUTION SHOULD BE
EXERCISED WHEN WORKING IN THE VICINITY OF ALL UTILITY SERVICES.

PLAN
SCALE 1:500

CONSTRUCTION



GHD
GHD Tower, Level 3 24 Homestead Drive
Newcastle NSW 2300 Australia
T 61 2 4979 9999
F 61 2 4979 9998
E info@ghd.com
W www.ghd.com

DO NOT SCALE			
Xref GHD_11031_Grl.dwg Conditions of Use: This document may only be used by GHD's client (and any other person who GHD's client has authorised) for the purpose for which it was prepared and must not be used by any other person or for any other purpose.	Drawn	J.MAATOM	Designer N.HINCKS
	Drafting	B.DREW	Design A.SNEEDON
	Checked		
	Approved (Project Director)	Date 16.04.24	This Drawing must not be signed as Approved

Client
Project
Title
MAITLAND CITY COUNCIL
HAUSSMAN DRIVE - STAGE 2
DETAIL PLAN
SHEET 4 OF 5

Drawing No: 22-12542622-C1104

Rev: 0

