

ANAMBAH RESIDENTIAL COMMUNITY

STAGE 1

LANDSCAPE CONCEPT PACKAGE

DRAWING LIST	DRAWING TITLE	SCALE
DWG NO.		
LDA00	Cover Sheet	NTS @ A1
LDA01	Streetscape Strategy	1:500 @ A1
LDA02	Indicative Plant List - Stage 1	1:500 @ A1
LDA03	Landscape Concept Plan 1	1:500 @ A1
LDA04	Landscape Concept Plan 2	1:500 @ A1
LDA05	Landscape Concept Plan 3	1:500 @ A1
LDA06	Landscape Concept Plan 4	1:500 @ A1
LDA07	Section Elevations	1:200 @ A1
LDA08	Riparian Park Concept Plan	1:500 @ A1
LDA09	Riparian Park Cross Sections	1:200 @ A1
LDA10	Entry Concept Plan	1:200 @ A1
LDA11	Entry Cross Sections	1:500 @ A1



KEY PLAN

APPROACH

Landmark Trees



To be shown within the parks and in the roundabout to assist with way-finding



Brachychiton acerifolius



Ficus rubiginosa

Entry

A collection of native canopy trees providing a strong green funnel into the site



Corymbia maculata 'Gamai'



Eucalyptus molucanna



Pistacia chinensis

Riparian Edge

A collection of native canopy trees that connects into the Entry and forms a native edge that ties into the Riparian corridor



Corymbia maculata 'Gamai'



Eucalyptus molucanna



Lophostemon confertus

Central Spine

Blocks of deciduous species create a sense of formality along the road that offer seasonal colour



Pyrus Calleryana 'Cleveland Select'



Pistacia chinensis



Lagerstroemia indica 'Natchez'

Streetscape East West

A mixture of small native trees bring year round colour and shade to the streets drawing on the native character of the parallel Entry and Riparian Edge



Brachychiton populaneus



Melia azedarach



Tristaniopsis laurina

Streetscape North South

The north south streets bring together tree species from across the different street types



Brachychiton populaneus



Pyrus Calleryana 'Cleveland Select'



Pistacia chinensis



Tristaniopsis laurina



INDICATIVE PLANTING LISTS

LANDMARK TREES

CODE	BOTANICAL NAME	COMMON NAME	HEIGHT (M)	WIDTH (M)
BAC	Brachychiton acerifolius	Illawarra Flame Tree	10-20	5-15
FRU	Ficus rubiginosa	Port jackson Fig	10-20	20

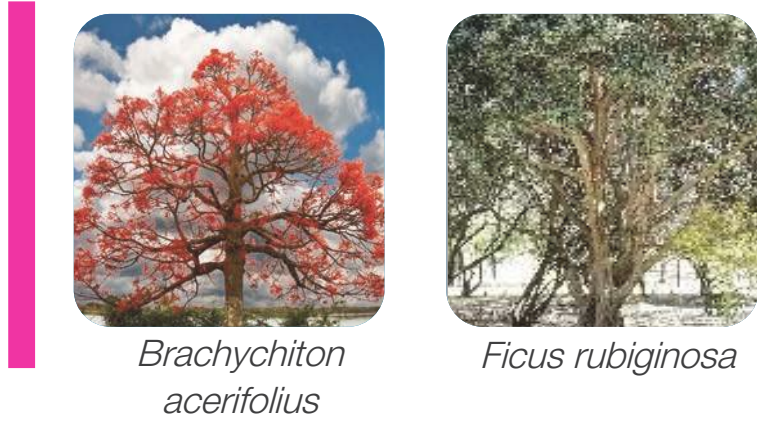

Brachychiton acerifolius

Ficus rubiginosa

ENTRY

CODE	BOTANICAL NAME	COMMON NAME	HEIGHT (M)	WIDTH (M)
CMA	Corymbia maculata ‘gamai’	Spotted Gum	12	4
EMO	Eucalyptus moluccana	Grey Box	20-25	10-15



Corymbia maculata ‘Gamai’

Eucalytpus molucanna

Pistacia chinensis

RIPARIAN EDGE

CODE	BOTANICAL NAME	COMMON NAME	HEIGHT (M)	WIDTH (M)
CMA	Corymbia maculata ‘gamai’	Spotted Gum	12	4
EMO	Eucalyptus moluccana	Grey Box	15-20	10-15
LCO	Lophostemon confertus	Brush Box	10-15	6-12



Corymbia maculata ‘Gamai’

Eucalytpus molucanna

Lophostemon confertus

CENTRAL SPINE

CODE	BOTANICAL NAME	COMMON NAME	HEIGHT (M)	WIDTH (M)
PCA	Pyrus calleryana ‘cleveland	Chanticleer Pear	8-11	6
PCH	Pistacia chinensis	Chinese Pistache	10-15	6
LIN	Lagerstroemia indica	White Crepe Myrtle	8	6



Pyrus Calleryana ‘Cleveland Select’

Pistacia chinensis

Lagerstroemia indica ‘Natchez’

STREETSCAPE EAST WEST

CODE	BOTANICAL NAME	COMMON NAME	HEIGHT (M)	WIDTH (M)
BPO	Brachychiton populneus	Kurrajong Tree	10-20	5-10
MAZ	Melia azedarach	Chinaberry	6-12	5-8
TLA	Tristaniopsis laurina	Water Gum	5-15	2-7



Brachychiton populaneus

Melia azedarach

Tristaniopsis laurina

STREETSCAPE NORTH SOUTH

CODE	BOTANICAL NAME	COMMON NAME	HEIGHT (M)	WIDTH (M)
BPO	Brachychiton populneus	Kurrajong Tree	10-20	5-10
PCA	Pyrus calleryana ‘cleveland	Chanticleer Pear	8-11	6
PCH	Pistacia chinensis	Chinese Pistache	10-15	6
TLA	Tristaniopsis laurina	Water Gum	5-15	2-7



Brachychiton populaneus

Pyrus Calleryana ‘Cleveland Select’

Pistacia chinensis

Tristaniopsis laurina

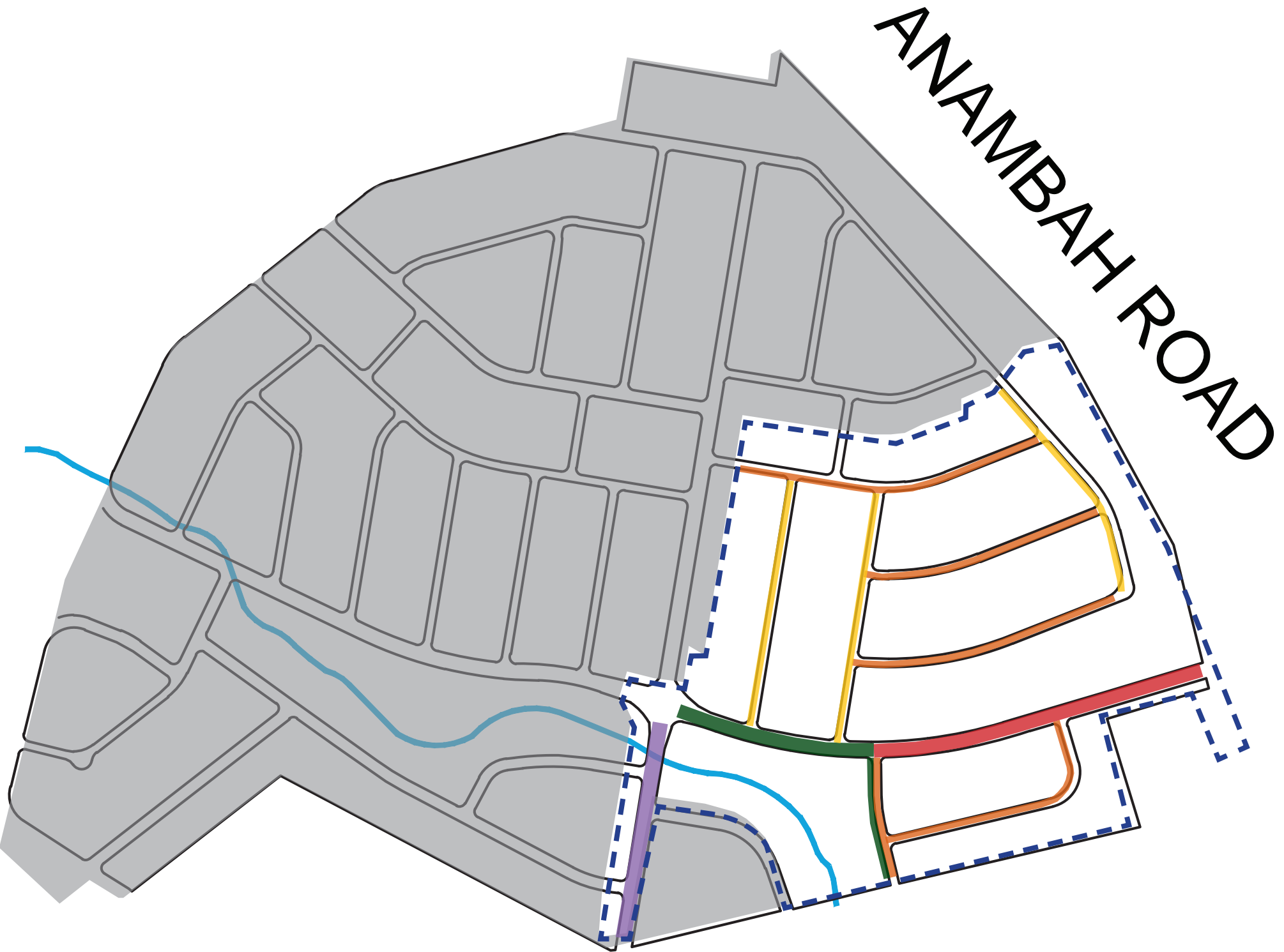

KEY PLAN



LEGEND

Boundaries & services

	SITE BOUNDARY
	STAGE 1: EXTENT OF WORK
	LOT BOUNDARIES
	EXISTING CONTOUR
	PROPOSED NEW CONTOUR

Hardscape

	CONCRETE PATH
--	---------------

Softscape

	EXISTING TREE TO BE REMOVED
	EXISTING TREE TO BE RETAINED
	PROPOSED DECIDUOUS TREES
	PROPOSED EVERGREEN TREES
	TURF VERGE

DIALOGUE

- 1 THE STREET TREES HAVE BEEN SELECTED ALONG THE NORTH SOUTH STREETS TO PROVIDE A MIX OF LOCAL SPECIES AND DECIDUOUS TREES TO PROVIDE SHADE AND COLOUR ACROSS THE SEASONS
- 2 THE STREET TREES HAVE BEEN SELECTED ALONG THE EAST WEST STREETS FOR THEIR SIZE AND COLOUR. THE SPECIES HAVE BEEN SELECTED TO RELATE TO THE NATIVE CHARACTER OF THE AREA



KEY PLAN



LEGEND

Boundaries & services

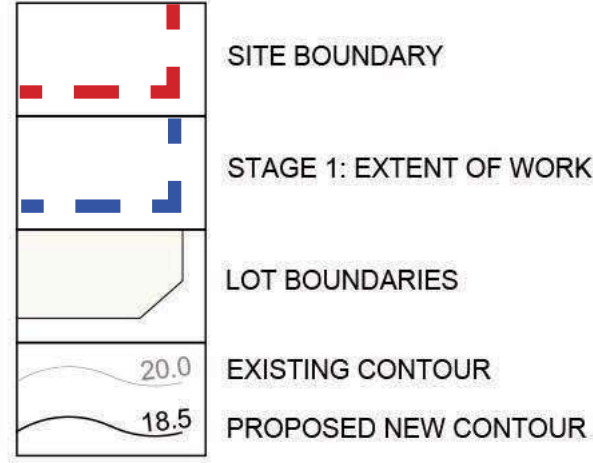

Hardscape

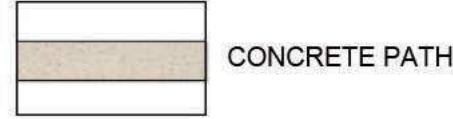

Softscape

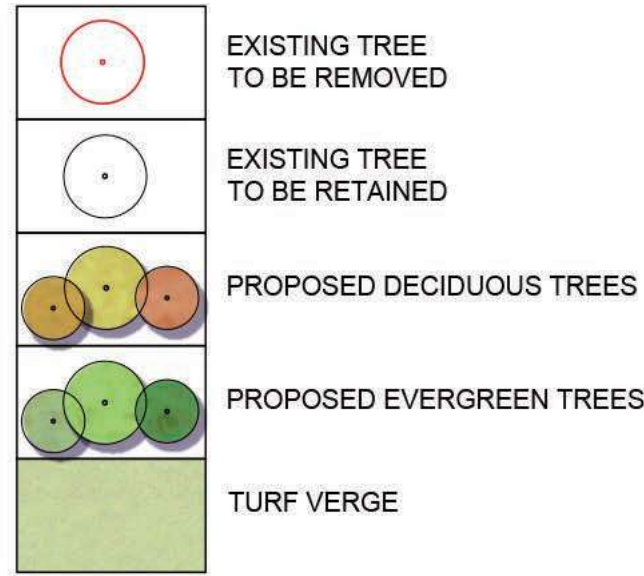

DIALOGUE

- 1 THE STREET TREES HAVE BEEN SELECTED ALONG THE NORTH SOUTH STREETS TO PROVIDE A MIX OF LOCAL SPECIES AND DECIDUOUS TREES TO PROVIDE SHADE AND COLOUR ACROSS THE SEASONS
- 2 THE STREET TREES HAVE BEEN SELECTED ALONG THE EAST WEST STREETS FOR THEIR SIZE AND COLOUR. THE SPECIES HAVE BEEN SELECTED TO RELATE TO THE NATIVE CHARACTER OF THE AREA

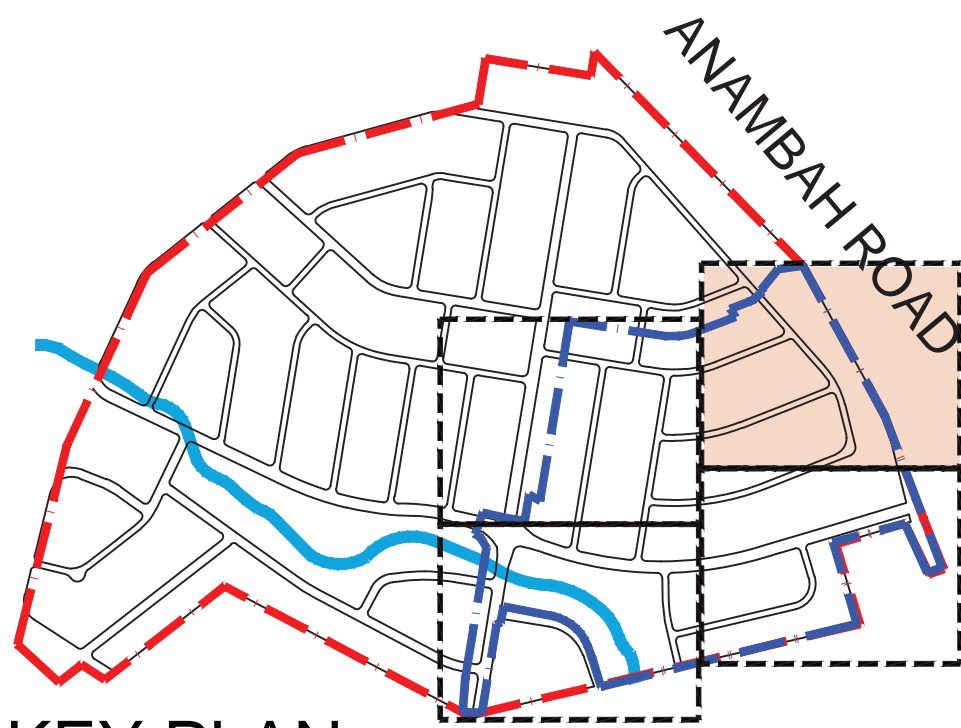

KEY PLAN



LEGEND

Boundaries & services

	SITE BOUNDARY
	STAGE 1: EXTENT OF WORK
	LOT BOUNDARIES
	EXISTING CONTOUR
	PROPOSED NEW CONTOUR

Hardscape

	CONCRETE PATH
--	---------------

Softscape

	EXISTING TREE TO BE REMOVED
	EXISTING TREE TO BE RETAINED
	PROPOSED DECIDUOUS TREES
	PROPOSED EVERGREEN TREES
	TURF VERGE

DIALOGUE

- 1 TREET TREES ALONG THE EDGES OF THE RIPARIAN ZONE COMPRISE A MIX OF LARGE NATIVE SPECIES. THESE SPECIES HAVE BEEN SELECTED TO CREATE A SEAMLESS CONNECTION BETWEEN THE RIPARIAN ZONE AND THE STREETScape, STRENGTHENING THE ECOLOGICAL CORRIDOR AND ENHANCING THE LOCAL CHARACTER
- 2 LANDMARK TREES WILL BE PLANTED WITHIN THE RIPARIAN PARK TO PROVIDE SHADE AND REINFORCE THE IDENTITY OF THE OPEN SPACES. THESE TREES WILL CREATE FOCAL POINTS WITHIN THE LANDSCAPE AND CONTRIBUTE TO THE OVERALL AMENITY OF THE PARK THE RIPARIAN PARK HAS BEEN DESIGNED
- 3 THE RIPARIAN PARK HAS BEEN DESIGNED TO PROVIDE A MIX OF OPEN TURF AREAS FOR INFORMAL ACTIVITIES AND STRUCTURED PLAY SPACES. BBQ FACILITIES AND SEATING AREAS ARE STRATEGICALLY LOCATED TO OVERLOOK THE RIPARIAN ZONE, ENSURING BOTH ACTIVE AND PASSIVE USES ARE SUPPORTED WHILE CELEBRATING THE NATURAL LANDSCAPE.



KEY PLAN



LEGEND

Boundaries & services

	SITE BOUNDARY
	STAGE 1: EXTENT OF WORK
	LOT BOUNDARIES
	EXISTING CONTOUR
	PROPOSED NEW CONTOUR

Hardscape

	CONCRETE PATH
--	---------------

Softscape

	EXISTING TREE TO BE REMOVED
	EXISTING TREE TO BE RETAINED
	PROPOSED DECIDUOUS TREES
	PROPOSED EVERGREEN TREES
	TURF VERGE

DIALOGUE

- 1 STREET TREES HAVE BEEN SELECTED TO RELATE TO THE EXISTING TREE PLANTING AT THE HOMESTEAD
- 2 A MIX OF NATIVE TREES TO BE PLANTED AS STREET TREES. THE LARGER EUCALYPTUS SPECIES WILL BE PLANTED ON THE CREEK SIDE OF THE PATHWAY. THE STREET TREES BLEND WITH THE FUTURE RIPARIAN PLANTING



KEY PLAN



SECTION AA



SECTION CC

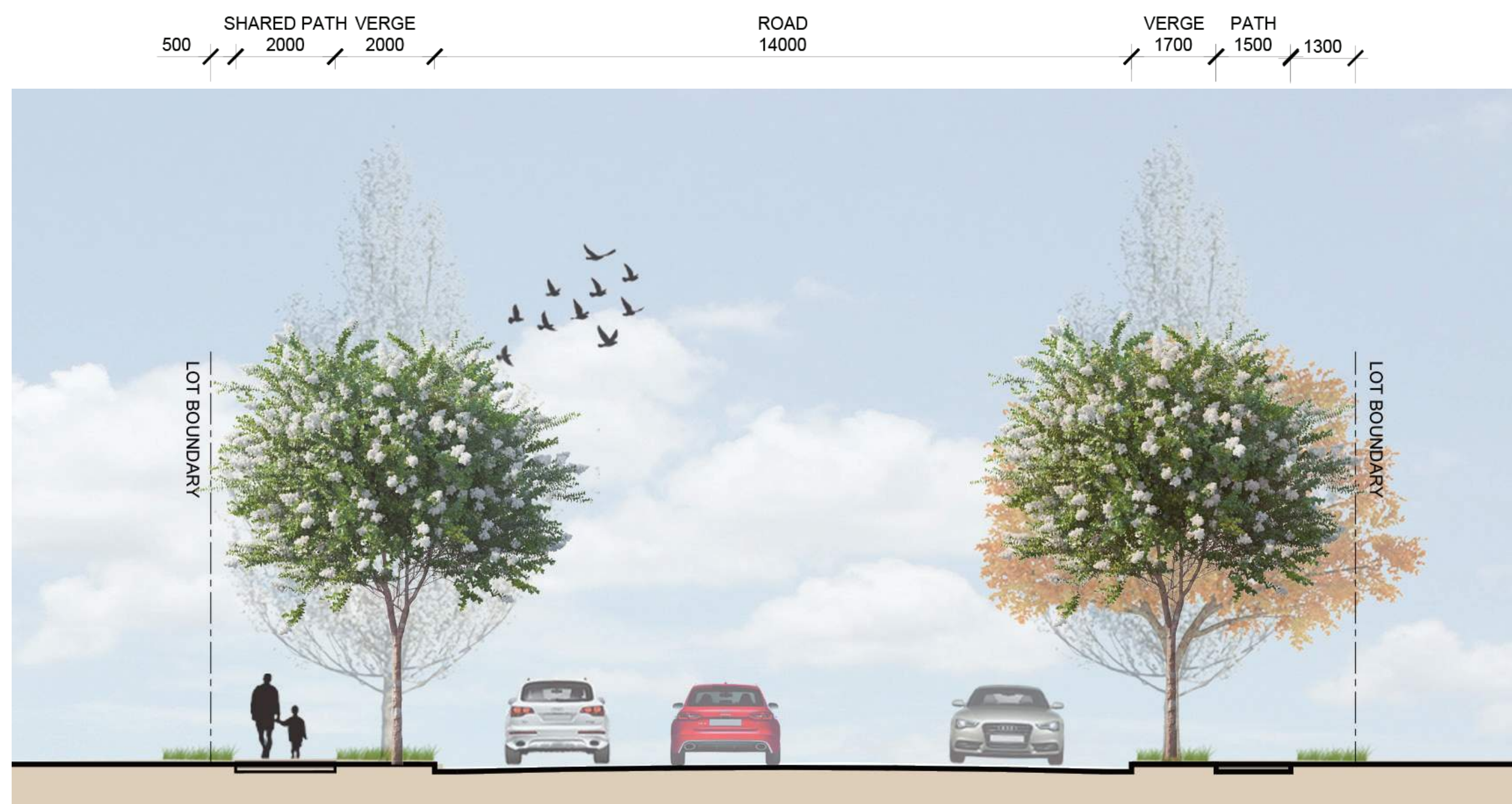

SECTION BB

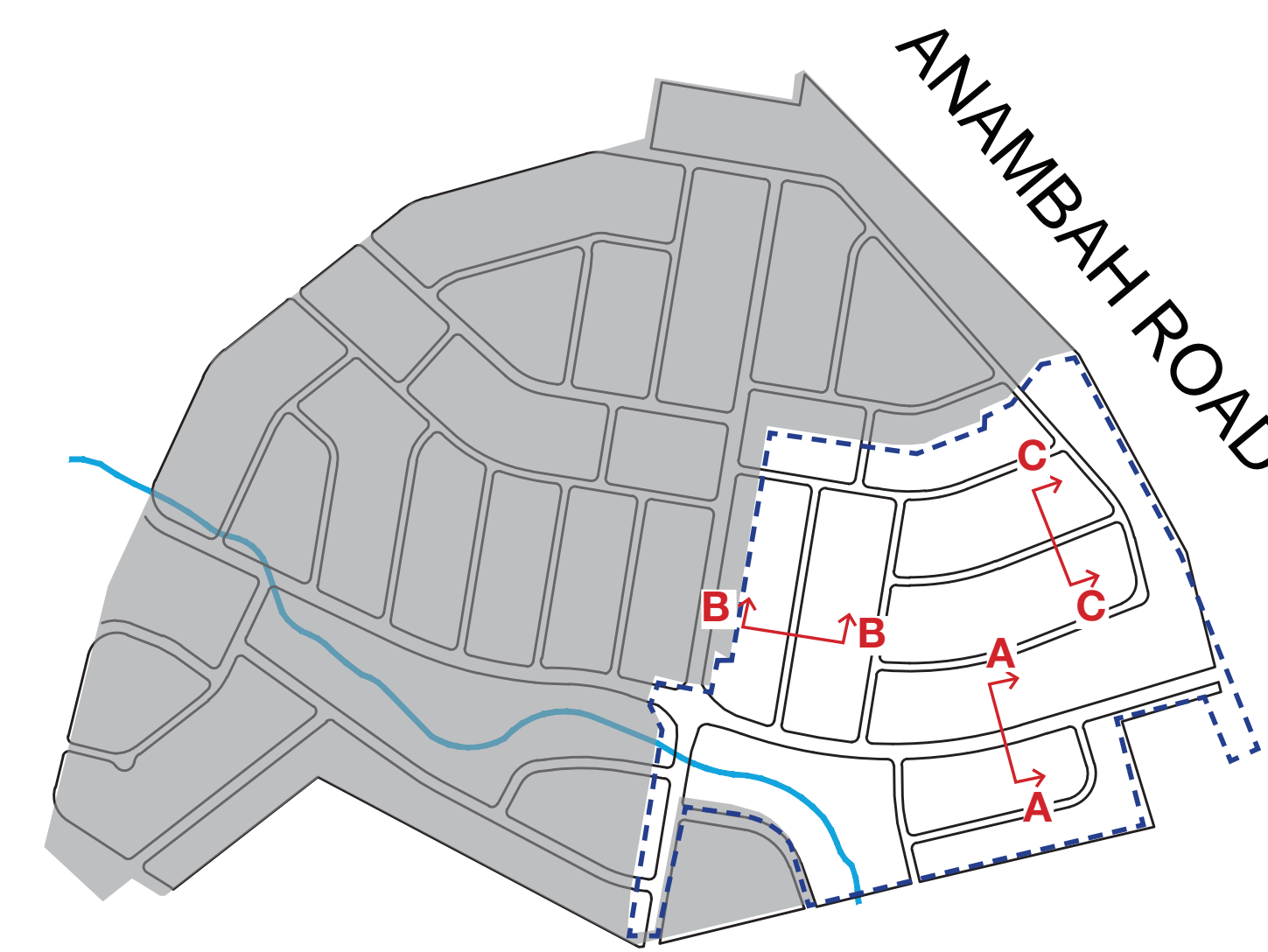

KEY PLAN



INSPIRATION



DIALOGUE

- 1 THE LARGE OPEN TURF AREA AT THE CORNER OF THE SITE HAS BEEN DESIGNED WITH A 1:5 GRASSED BATTER. THIS NATURAL SLOPE CREATES AN AMPHITHEATRE-LIKE SPACE FOR VIEWING ACTIVITIES ON THE TURF, OFFERING SHADED VANTAGE POINTS BENEATH THE SURROUNDING TREES
- 2 THE FOOTPATH CONNECTIONS EXTEND INTO THE PARK, INTEGRATING WITH THE EXISTING FOOTPATH NETWORK TO PROVIDE EASY ACCESS FOR USERS. THESE PATHS HAVE BEEN DESIGNED TO INCLUDE A MAINTAINABLE EDGE ALONG THE RIPARIAN ZONE, SUPPORTING LONG-TERM LANDSCAPE HEALTH AND FUNCTIONALITY. IMPORTANTLY, ALL FOOTPATHS HAVE BEEN DESIGNED TO COMPLY WITH EVERYONE CAN PLAY PRINCIPLES
- 3 LANDMARK TREES ARE INTEGRATED THROUGHOUT THE PARK TO PROVIDE SHADE, SEASONAL COLOUR, AND A DISTINCTIVE IDENTITY FOR THE SPACE. THESE TREES CREATE FOCAL POINTS AND CONTRIBUTE TO A WELCOMING AND VIBRANT PARK EXPERIENCE.

THE PLAYGROUND HAS BEEN DESIGNED TO OFFER A MIX OF PLAY EXPERIENCES CATERING TO DIFFERENT AGES AND ABILITIES. IT INCLUDES EQUIPMENT FOR SWINGING, SLIDING, AND CLIMBING, ENSURING INCLUSIVE AND ENGAGING OPPORTUNITIES FOR ALL USERS
- 4 A CENTRAL PAVILION EQUIPPED WITH BBQ FACILITIES AND SEATING ENCOURAGES VISITORS TO STAY LONGER AND ENJOY THE PARK. THIS FEATURE ALIGNS WITH THE EVERYONE CAN PLAY PRINCIPLES

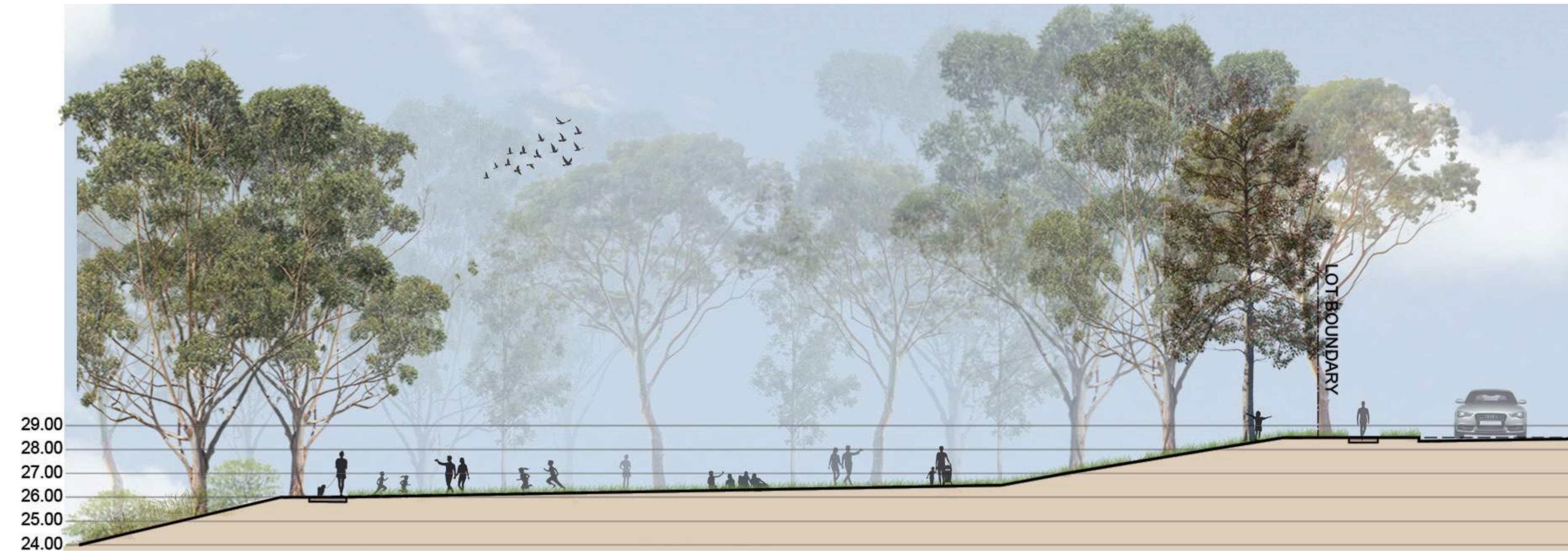

SECTION AA



SECTION CC



SECTION BB

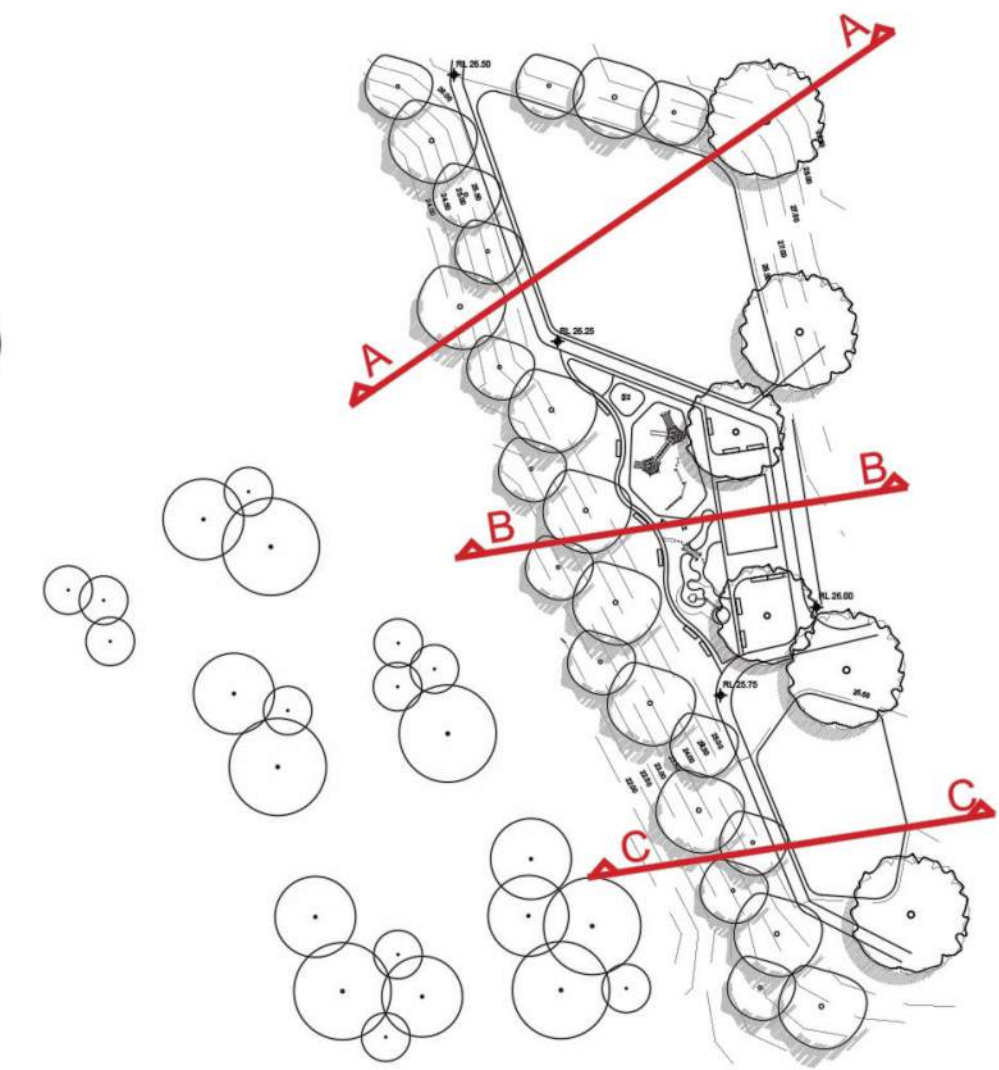

KEY PLAN

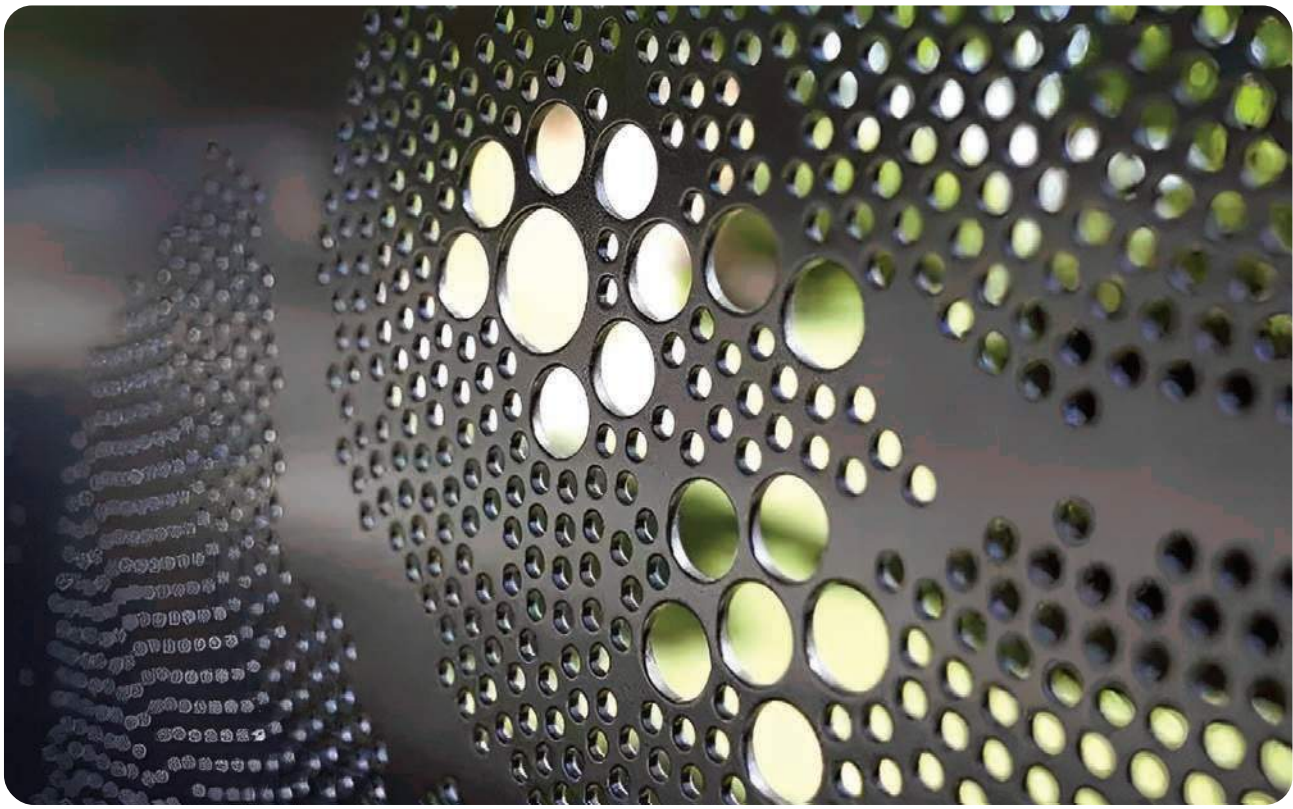

PERFORATED STEEL TO BE ATTACHED TO THE FRONT OF THE GABION



PERFORATED STEEL TO BE ATTACHED TO THE FRONT OF THE GABION

DIALOGUE

- 1 THE ENTRY WALLS ARE DESIGNED AS SANDSTONE-FILLED GABIONS, LINKING THE SITE TO THE LOCAL STONE MATERIALS. PERFORATED STEEL PANELS WILL BE APPLIED TO THE FRONT OF THE WALLS, WITH A DESIGN THAT REFLECTS THE MEANDERING FORM OF THE HUNTER RIVER, ADDING BOTH TEXTURE AND VISUAL INTEREST TO THE ENTRY EXPERIENCE.
- 2 THE DOUBLE ROW OF DECIDUOUS TREES AT THE ENTRY CREATES A STRONG ARRIVAL POINT, EASILY RECOGNISABLE TO THOSE TRAVELLING ALONG ANAMBAH ROAD. THIS PLANTING ARRANGEMENT ENHANCES THE SENSE OF PLACE AND MARKS THE ENTRY

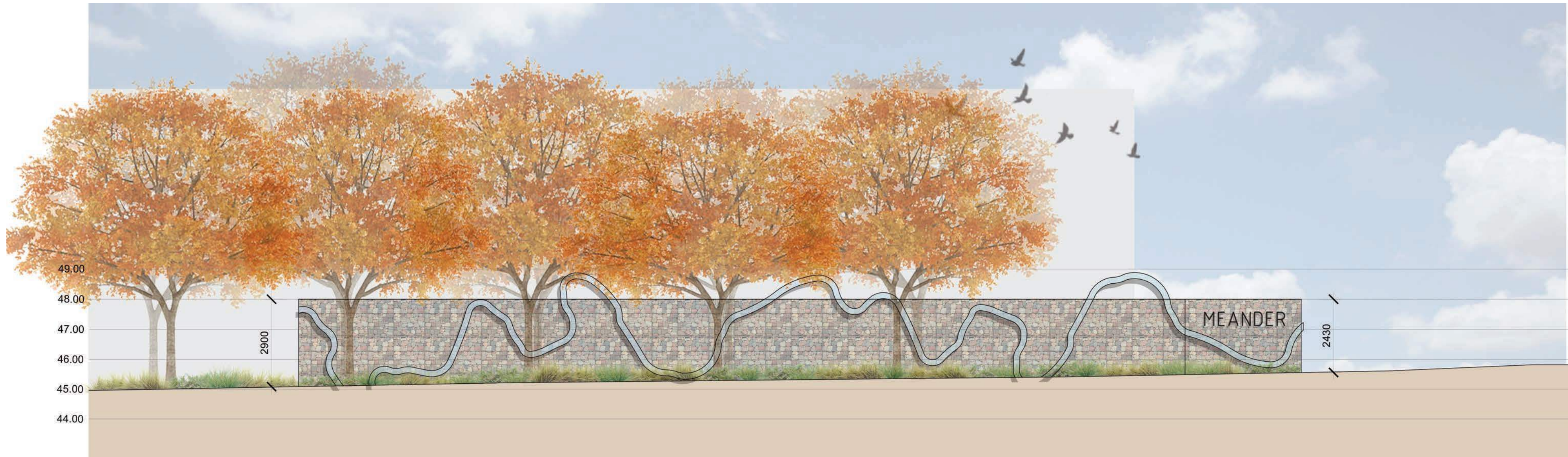

SECTION AA - 1:100

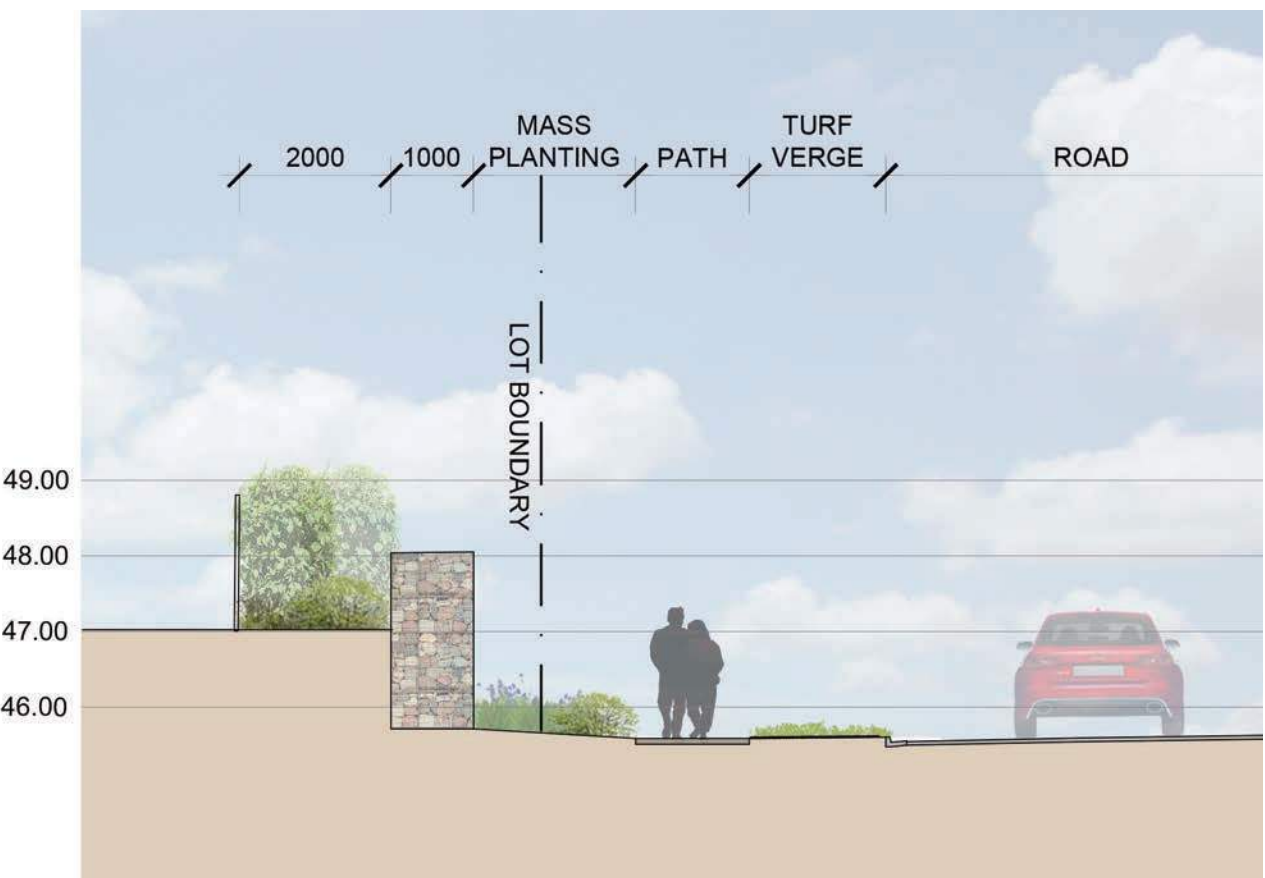

SECTION BB - 1:100

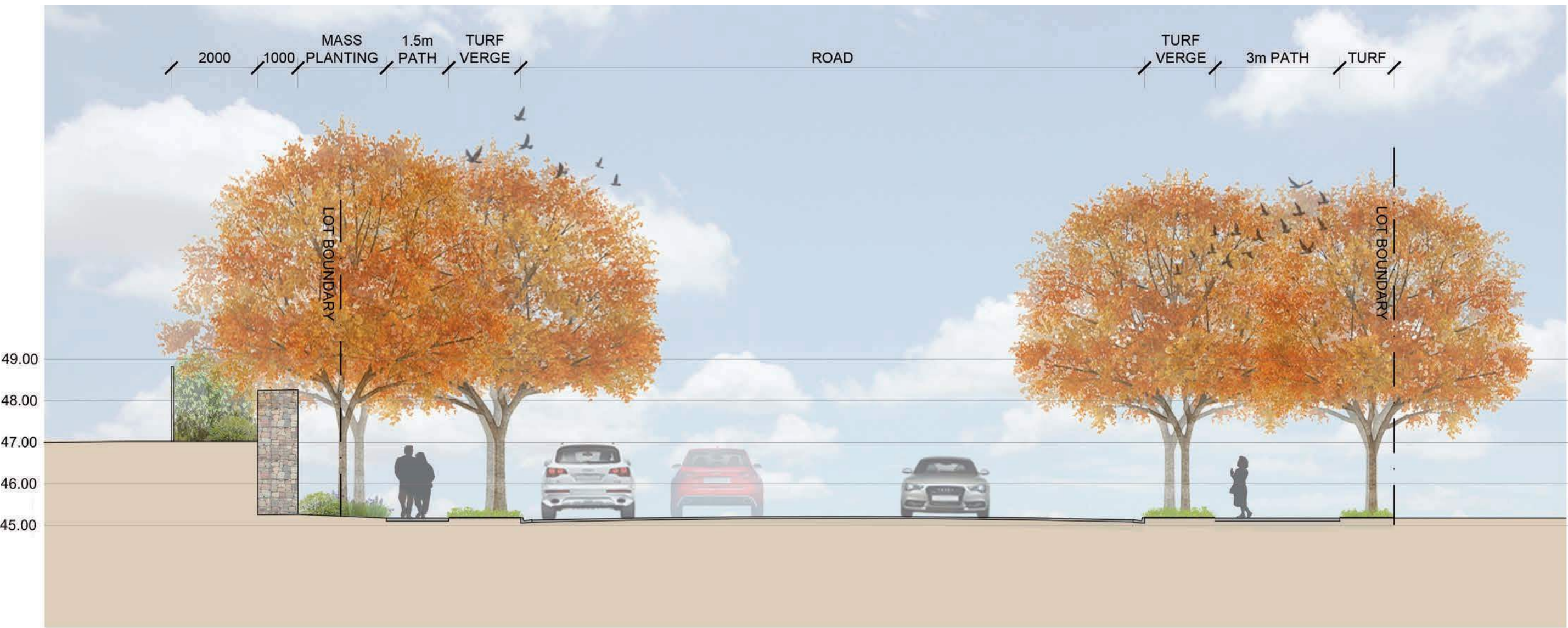

SECTION CC - 1:100

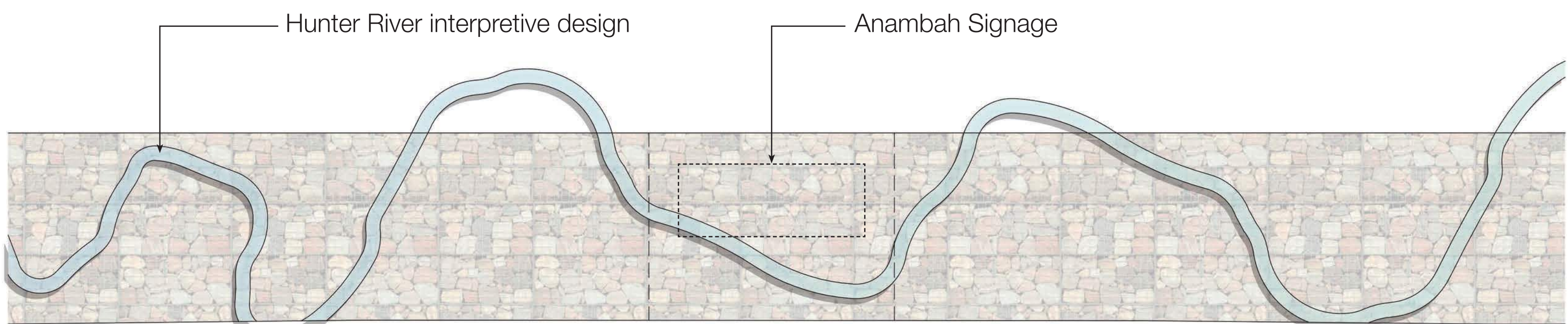

ENTRY WALL - 1:50

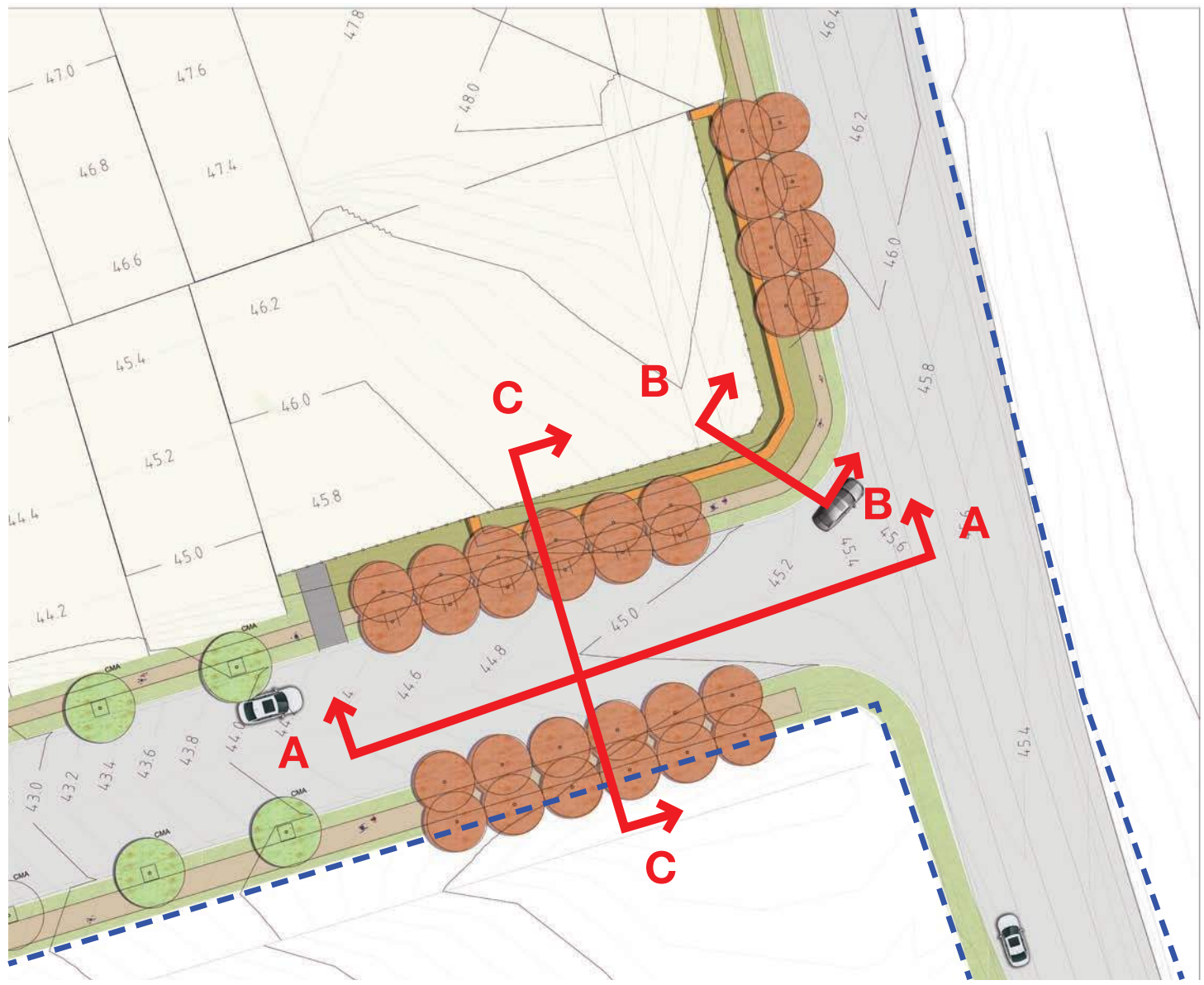

KEY PLAN