

STAGE No.	No. RESIDENTIAL LOTS PROPOSED
1	89
2	50
TOTAL	139

EXISTING EASEMENTS

- (A) - EASEMENT FOR WATER SUPPLY AND SEWERAGE PIPELINES 10 WIDE (AH31420, DP 1137872)
- (B) - EASEMENT FOR PIPELINE 10 WIDE (AH908180, DP 1238395)

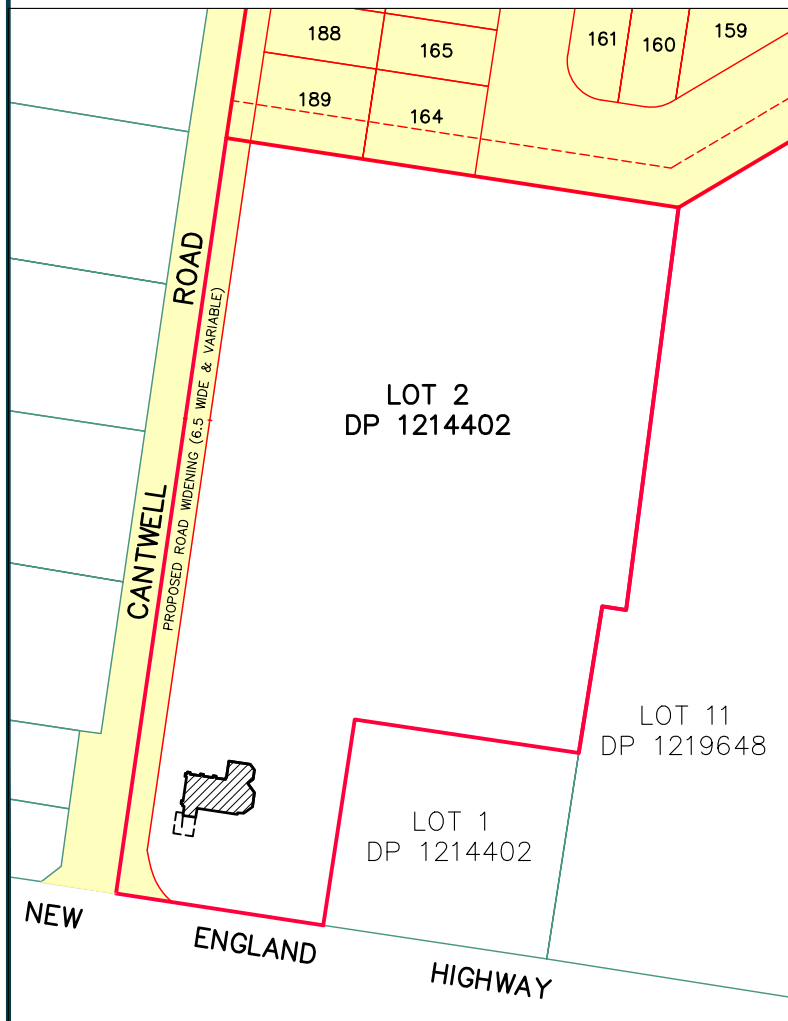

INSET

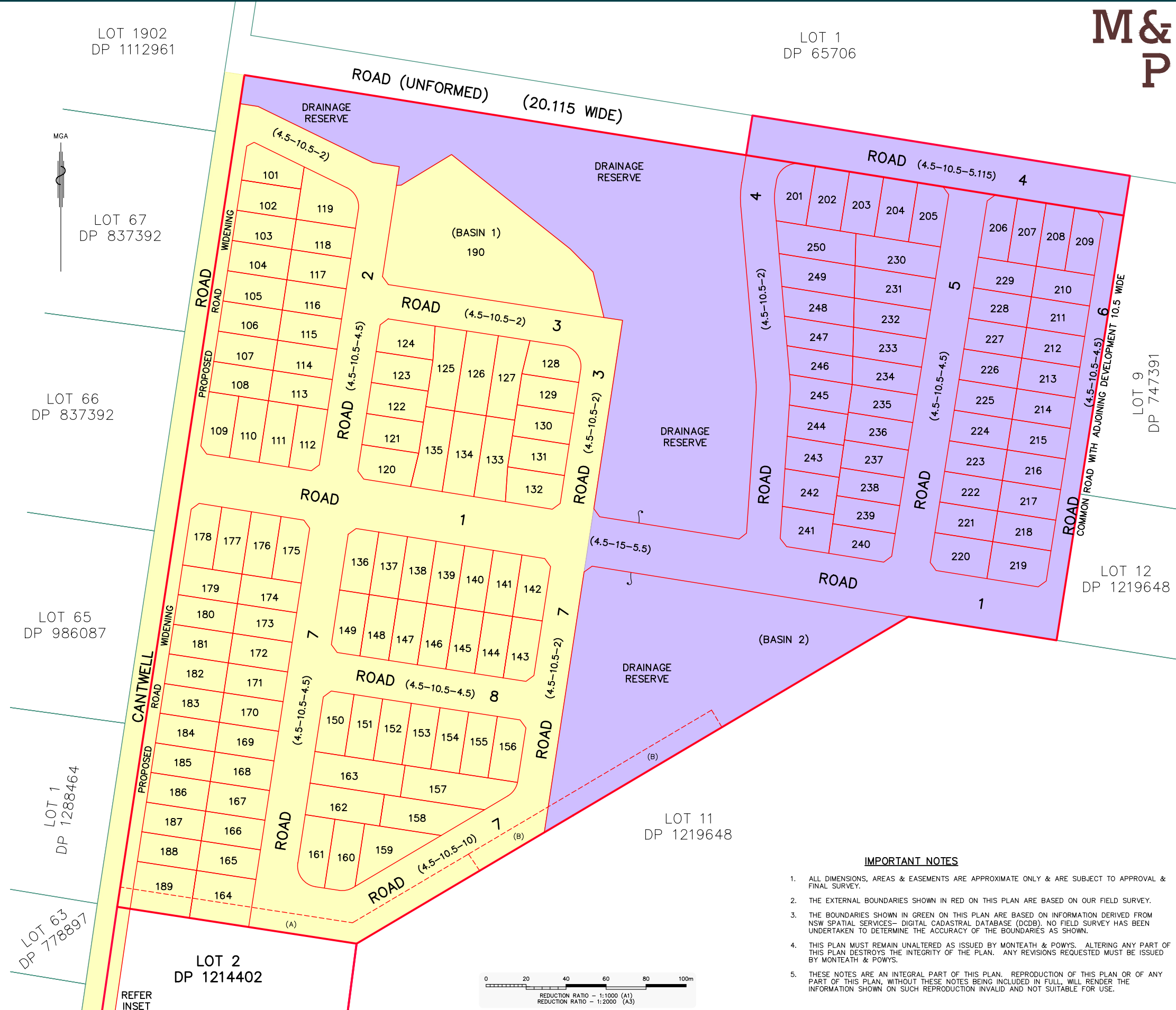

IMPORTANT NOTES

- ALL DIMENSIONS, AREAS & EASEMENTS ARE APPROXIMATE ONLY & ARE SUBJECT TO APPROVAL & FINAL SURVEY.
- THE EXTERNAL BOUNDARIES SHOWN IN RED ON THIS PLAN ARE BASED ON OUR FIELD SURVEY.
- THE BOUNDARIES SHOWN IN GREEN ON THIS PLAN ARE BASED ON INFORMATION DERIVED FROM NSW SPATIAL SERVICES- DIGITAL CADASTRAL DATABASE (DCDB). NO FIELD SURVEY HAS BEEN UNDERTAKEN TO DETERMINE THE ACCURACY OF THE BOUNDARIES AS SHOWN.
- THIS PLAN MUST REMAIN UNALTERED AS ISSUED BY MONTEATH & POWYS. ALTERING ANY PART OF THIS PLAN DESTROYS THE INTEGRITY OF THE PLAN. ANY REVISIONS REQUESTED MUST BE ISSUED BY MONTEATH & POWYS.
- THESE NOTES ARE AN INTEGRAL PART OF THIS PLAN. REPRODUCTION OF THIS PLAN OR ANY PART OF THIS PLAN, WITHOUT THESE NOTES BEING INCLUDED IN FULL, WILL RENDER THE INFORMATION SHOWN ON SUCH REPRODUCTION INVALID AND NOT SUITABLE FOR USE.

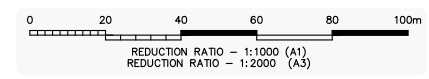

REVISIONS	No	REVISION	SVY	DFT	CHK	DATE
	1	ISSUE TO CLIENT	DCW	MAK	GR	20/01/26

COPYRIGHT NOTICE
THIS DOCUMENT REMAINS THE PROPERTY OF MONTEATH & POWYS PTY LTD. ©

CONDITIONS OF USE.
THIS DOCUMENT MAY ONLY BE USED BY THE CLIENT FOR THE PURPOSE FOR WHICH IT WAS COMMISSIONED. USE OF THE DOCUMENT FOR ANY OTHER PURPOSE IS NOT PERMITTED UNLESS PRIOR WRITTEN APPROVAL HAS BEEN OBTAINED FROM MONTEATH & POWYS PTY LTD.



PLANNING PROJECT MANAGEMENT SURVEYING 3D SPATIAL

monteathpowys.com.au
P (02) 4926 1388

NEWCASTLE SYDNEY GUNNDAH MUSWELLBROOK

Surveyed DCW	Drafted MAK	Checked GR
REGISTERED SURVEYOR		
@A1 : 1:1000 @A3 : 1:2000		Original Size
DO NOT SCALE		A1

Client EXP CAPITAL	Sheet No. 1/1
Title STAGING PLAN OF SUBDIVISION OF LOTS 1 & 2 DP1299958 AND LOT 2 DP 1214402 CANTWELL ROAD, LOCHINVAR	Revision 1
CAD File: A250603AB_01	Date: 20/01/2026