

STAGE No.	No. RESIDENTIAL LOTS PROPOSED
1	89
2	50
TOTAL	139



LOT 1902
DP 1112961

LOT 1
DP 65706

LOT 67
DP 837392

LOT 66
DP 837392

LOT 65
DP 986087

LOT 1
DP 1288464

LOT 63
DP 778897

LOT 2
DP 1214402

LOT 11
DP 1219648

LOT 9
DP 747391

LOT 12
DP 1219648

EXISTING EASEMENTS
(A) - EASEMENT FOR WATER SUPPLY AND SEWERAGE PIPELINES 10 WIDE (AH31420, DP 1137872)
(B) - EASEMENT FOR PIPELINE 10 WIDE (AH908180, DP 1238395)

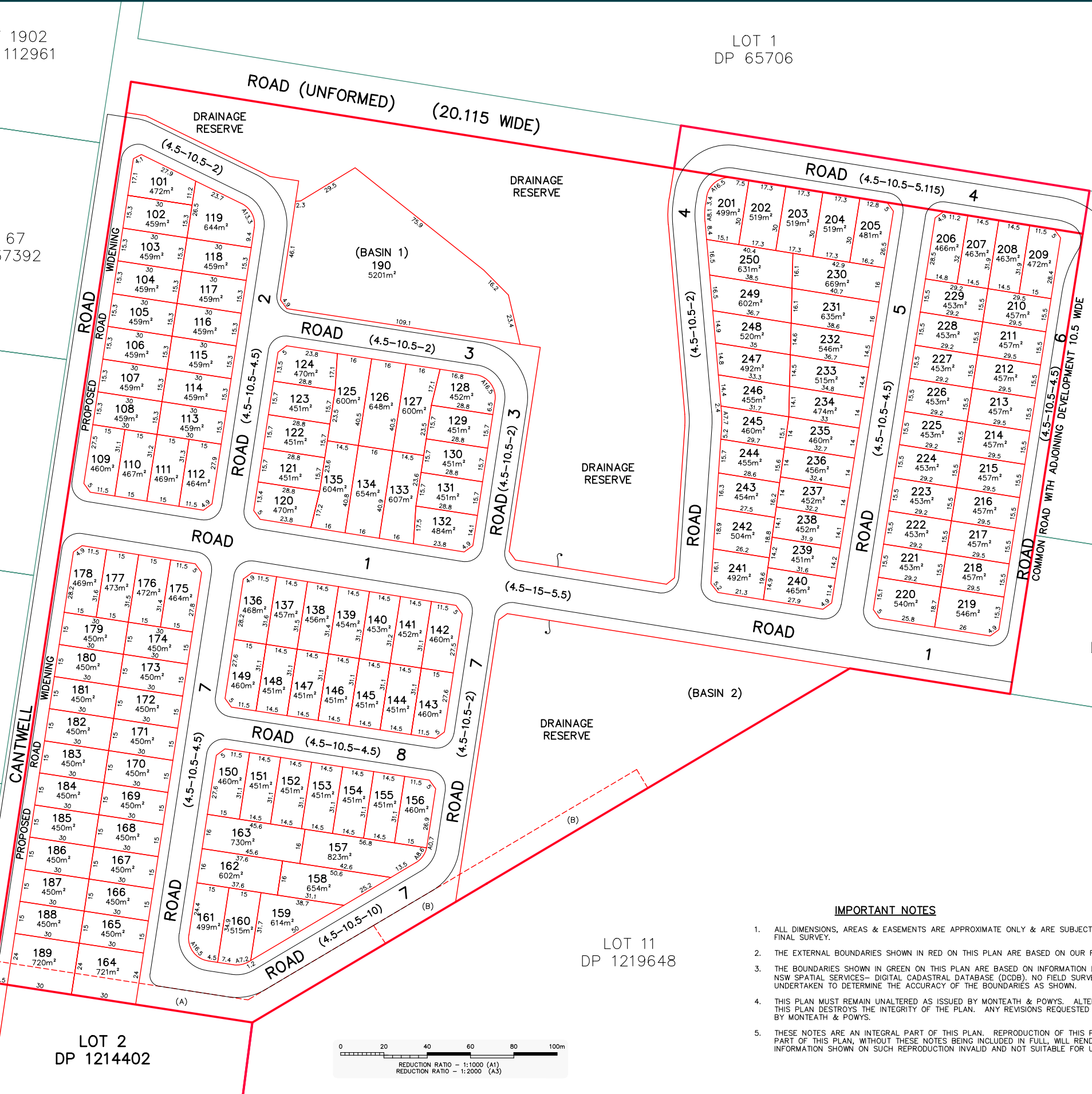

IMPORTANT NOTES

- ALL DIMENSIONS, AREAS & EASEMENTS ARE APPROXIMATE ONLY & ARE SUBJECT TO APPROVAL & FINAL SURVEY.
- THE EXTERNAL BOUNDARIES SHOWN IN RED ON THIS PLAN ARE BASED ON OUR FIELD SURVEY.
- THE BOUNDARIES SHOWN IN GREEN ON THIS PLAN ARE BASED ON INFORMATION DERIVED FROM NSW SPATIAL SERVICES- DIGITAL CADASTRAL DATABASE (DCDB). NO FIELD SURVEY HAS BEEN UNDERTAKEN TO DETERMINE THE ACCURACY OF THE BOUNDARIES AS SHOWN.
- THIS PLAN MUST REMAIN UNALTERED AS ISSUED BY MONTEATH & POWYS. ALTERING ANY PART OF THIS PLAN DESTROYS THE INTEGRITY OF THE PLAN. ANY REVISIONS REQUESTED MUST BE ISSUED BY MONTEATH & POWYS.
- THESE NOTES ARE AN INTEGRAL PART OF THIS PLAN. REPRODUCTION OF THIS PLAN OR OF ANY PART OF THIS PLAN, WITHOUT THESE NOTES BEING INCLUDED IN FULL, WILL RENDER THE INFORMATION SHOWN ON SUCH REPRODUCTION INVALID AND NOT SUITABLE FOR USE.

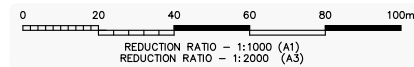

REVISIONS	No	REVISION	SVY	DFT	CHK	DATE
	2	ROAD WIDENING AMENDED	DCW	MAK	CB	04/02/26
	1	ISSUE TO CLIENT	DCW	MAK	MP	21/01/26
	No	REVISION	SVY	DFT	CHK	DATE

COPYRIGHT NOTICE
THIS DOCUMENT REMAINS THE PROPERTY OF MONTEATH & POWYS PTY LTD. ©

CONDITIONS OF USE.
THIS DOCUMENT MAY ONLY BE USED BY THE CLIENT FOR THE PURPOSE FOR WHICH IT WAS COMMISSIONED. USE OF THE DOCUMENT FOR ANY OTHER PURPOSE IS NOT PERMITTED UNLESS PRIOR WRITTEN APPROVAL HAS BEEN OBTAINED FROM MONTEATH & POWYS PTY LTD.



PLANNING PROJECT MANAGEMENT SURVEYING 3D SPATIAL

monteathpowys.com.au
P (02) 4926 1388

NEWCASTLE SYDNEY GUNNEDAH MUSWELLBROOK

Surveyed	Drafted	Checked	Client
DCW	MAK	MP	EXP CAPITAL

REGISTERED SURVEYOR		Title	Sheet No.
Original Size	A1	PROPOSED SUBDIVISION OF LOTS 1 & 2 DP1299958 AND LOT 2 DP 1214402 CANTWELL ROAD, LOCHINVAR	1/2
DO NOT SCALE		CAD File: A250603AC_02 Ref No: 25/0603 Date: 21/01/2026	Revision 2

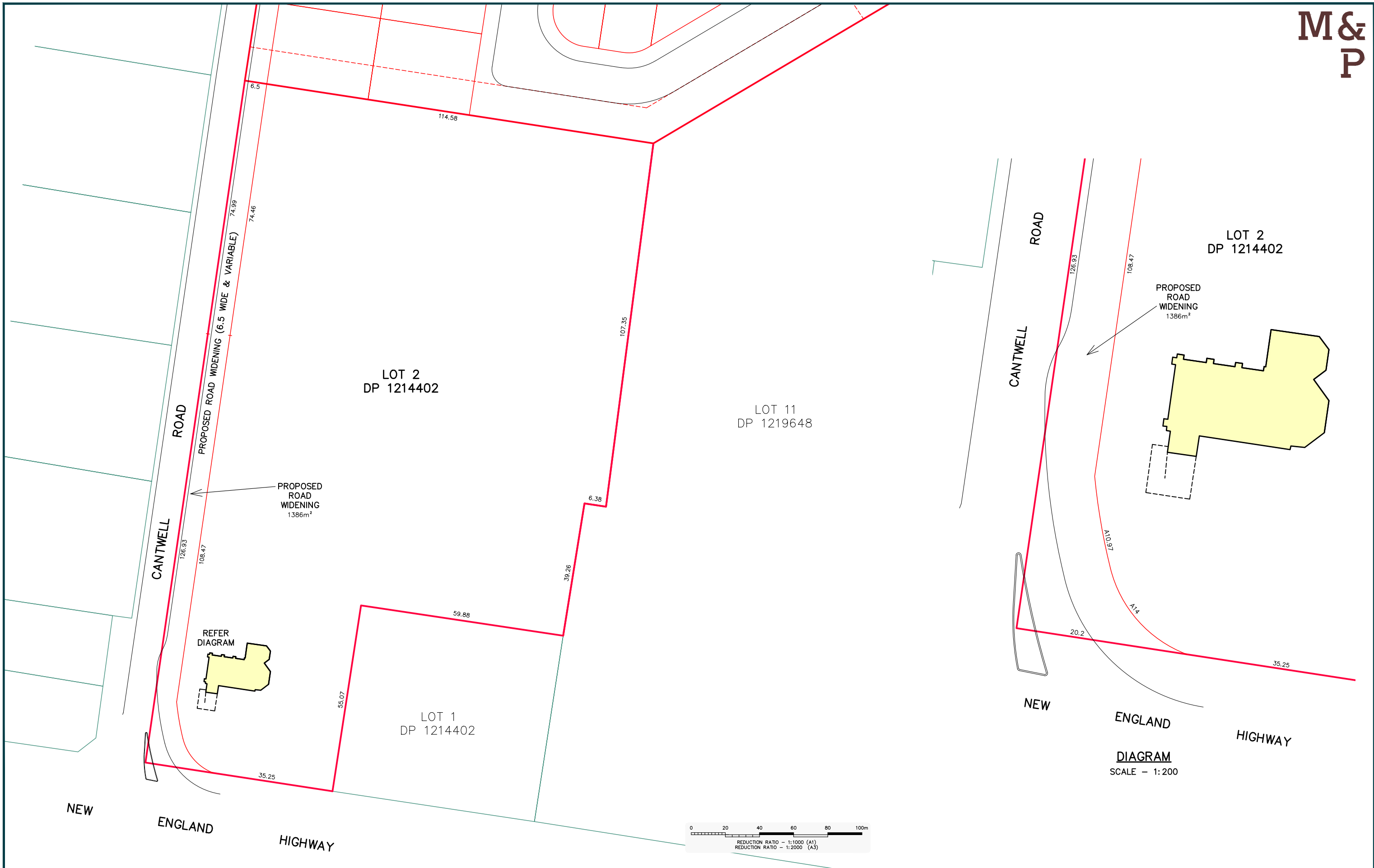
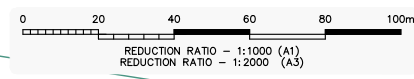

DIAGRAM
SCALE - 1:200



REVISIONS	No	REVISION	SVY	DFT	CHK	DATE
	2	ROAD WIDENING AMENDED	DCW	MAK	CB	04/02/26
	1	ISSUE TO CLIENT	DCW	MAK	MP	21/01/26

COPYRIGHT NOTICE
THIS DOCUMENT REMAINS THE PROPERTY OF MONTEATH & POWYS PTY LTD. ©

CONDITIONS OF USE.
THIS DOCUMENT MAY ONLY BE USED BY THE CLIENT FOR THE PURPOSE FOR WHICH IT WAS COMMISSIONED. USE OF THE DOCUMENT FOR ANY OTHER PURPOSE IS NOT PERMITTED UNLESS PRIOR WRITTEN APPROVAL HAS BEEN OBTAINED FROM MONTEATH & POWYS PTY LTD.



PLANNING PROJECT MANAGEMENT SURVEYING 3D SPATIAL
monteathpowys.com.au
P (02) 4926 1388
NEWCASTLE SYDNEY GUNNEDAH MUSWELLBROOK

Surveyed DCW	Drafted MAK	Checked MP	Client EXP CAPITAL
REGISTERED SURVEYOR @A1 : 1:500 @A3 : 1:2000			Title PROPOSED SUBDIVISION OF LOTS 1 & 2 DP1299958 AND LOT 2 DP 1214402 CANTWELL ROAD, LOCHINVAR
DO NOT SCALE		A1	CAD File: A250603AC_02 Ref No: 25/0603 Date: 21/01/2026

Sheet No. 2/2	Revision 2
------------------	---------------