

51 and 134 Station Lane, LOCHINVAR

Lot 3 / DP 564631 and Lot 4 / DP 634523

LANDSCAPE MASTERPLAN



SHEET INDEX		ISSUE	DESCRIPTION	DATE
L01	SITE PLAN	B	FOR SUBMISSION	22/04/2022
L02	STREET TREE MASTER PLAN	B	FOR SUBMISSION	22/04/2022
L03	PARK CONCEPT	B	FOR SUBMISSION	22/04/2022
L04	PLANT SCHEDULE	B	FOR SUBMISSION	22/04/2022
L05	LANDSCAPE BUFFER	B	FOR SUBMISSION	22/04/2022

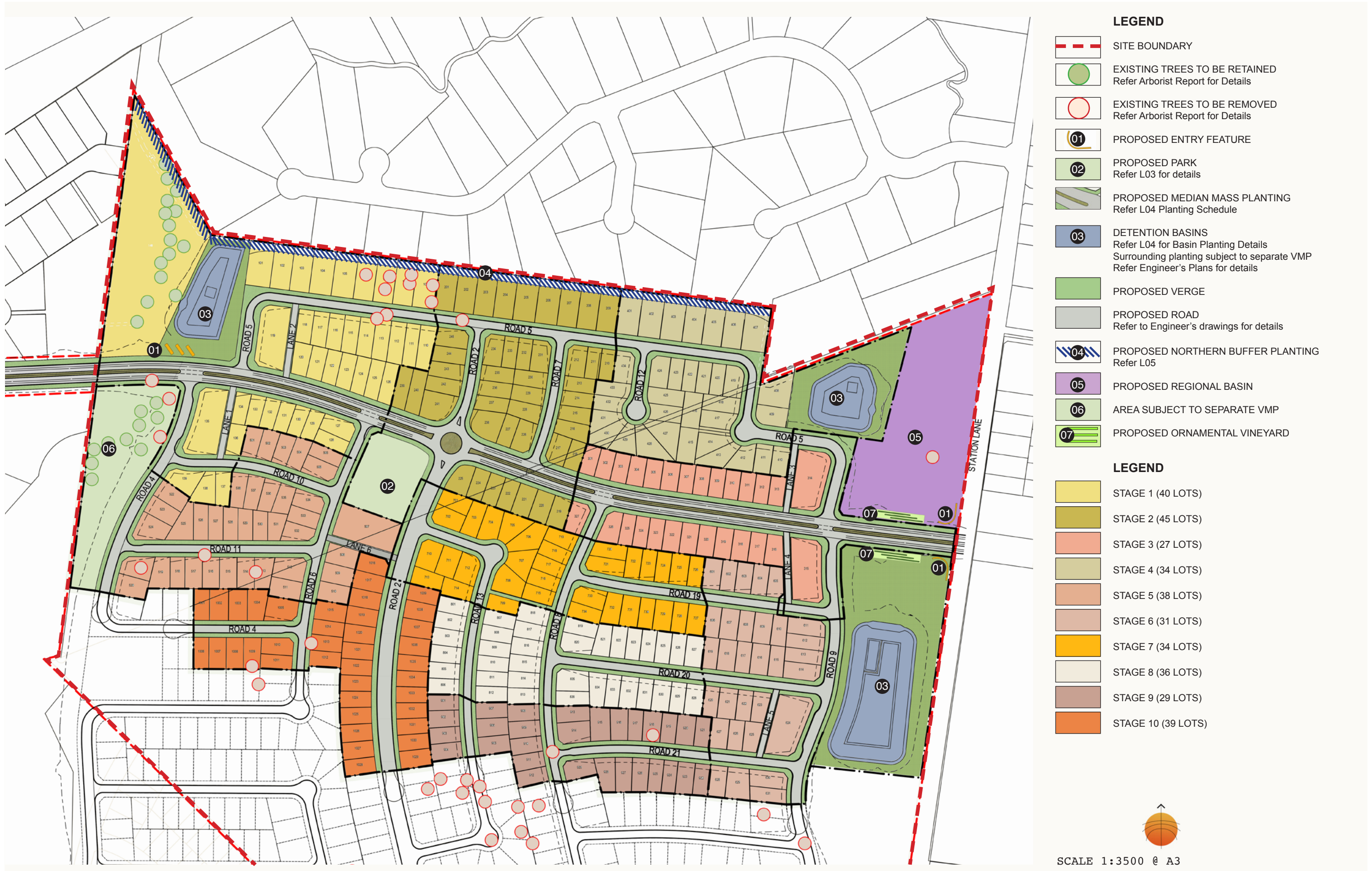

L01 Site Plan

51 and 134 STATION LANE,
LOCHINVAR, NSW

DATE:
APRIL 2022

CLIENT:
McCLOY
PROJECT MANAGEMENT

PROJECT NO.
GSP210301

SUBMISSION:
B - FOR SUBMISSION

GREEN SPACE PLANNING Co.
3/19 BOLTON STREET NEWCASTLE NSW 2300
PH 0423 684 382





LANDSCAPE NOTES

1. STREET TREE SPECIES CHOSEN FOR BEING SUITABLY HARDY, PROVEN PERFORMERS.
2. PROPOSED PLANTING DOWN CENTRAL MEDIAN OF STRIKING FEATURE TREE (ZELKOVA SP.) WITH MASS PLANTING BENEATH. EVERGREEN 'LUSCIOUS' TREES TO CREATE A VERDANT AVENUE EFFECT.
3. A SINGLE STREET TREE SPECIES IS INTENDED TO LINE EACH STREET IN ORDER TO CREATE A SENSE OF PLACE AND CHARACTER FOR EACH STREET.
4. DECIDUOUS TREE SPECIES HAVE BEEN CHOSEN TO LINE EAST-WEST ORIENTATED STREETS FOR SEASONAL VARIATION AND TO PERMIT SOLAR ACCESS TO RESIDENCES.
5. MIXED EVERGREEN SPECIES TO LINE NORTH-SOUTH ORIENTATED STREETS.

LEGEND

- SITE BOUNDARY
- EXISTING TREES TO BE RETAINED
Refer Arborist Report for Details
- EXISTING TREES TO BE REMOVED
Refer Arborist Report for Details
- 01 PROPOSED ENTRY FEATURE
- 02 PROPOSED PARK
Refer L03 for details
- PROPOSED MEDIAN MASS PLANTING
Refer L04 Planting Schedule
- 03 DETENTION BASINS
Refer L04 for Basin Planting Details
Surrounding planting subject to separate VMP
Refer Engineer's Plans for details
- PROPOSED VERGE
- PROPOSED ROAD
Refer to Engineer's drawings for details
- 04 PROPOSED NORTHERN BUFFER PLANTING
Refer L05
- 05 PROPOSED REGIONAL BASIN
- 06 AREA SUBJECT TO SEPARATE VMP
- 07 PROPOSED ORNAMENTAL VINEYARD

STREET TREE LEGEND

AVENUE TREES

- ZELKOVA SERRATA 'GREEN VASE'
- TRISTANIOPSIS LAURINA 'LUSCIOUS'
- EVERGREEN TREES**
 - BUCKINGHAMIA CELSISSIMA
 - CUPANIOPSIS ANARCARDIODES
 - HARPULLIA PENDULA
 - LOPHOSTEMON CONFERTUS
 - WATERHOUSEA FLORIBUNDA 'GREEN AVENUE'

DECIDUOUS TREES

- ACER NEGUNDO
- FRAXINUS PENNSYLVANICA 'CIMMAM CIMMARON'
- PISTACHIO CHINENSIS
- PRUNUS CERASIFERA 'NIGRA'
- SAPIUM SEBIFERUM



- KEY**
- 01 PARK ENTRY FEATURE
 - 02 PUBLIC ART LOCATION
 - 03 MINI VINEYARD AND COMMUNITY GARDEN OPPORTUNITY
 - 04 CHILDRENS' PLAYGROUND
 - 05 LOOP PATH FOR TRIKE TRACK
 - 06 PICNIC SHELTERS
 - 07 GYM STATION EQUIPMENT
 - 08 HALF BASKETBALL COURT
 - 09 CENTRAL PATHWAY
 - 10 OPEN GRASS PASSIVE RECREATION SPACE
 - 11 FEATURE PLANTING IN ACCORDANCE WITH CPTD PRINCIPLES - REFER PLANT SCHEDULE FOR SPECIES SELECTION RECOMMENDATIONS.



SUGGESTED PLANT SCHEDULE

Key	Botanical Name	Common Name	Pot Size	Mature Height	Mature Spread
STREET TREES					
01	<i>Acer negundo</i> ‘Sensation’	Box Elder	75L	10m	8m
02	<i>Buckinghamia celsissima</i>	Ivory Curl Tree	75L	10m	4m
03	<i>Cupaniopsis anarcardiodes</i>	Tuckeroo	75L	8m	5m
04	<i>Fraxinus pennsylvanica</i> ‘Cimmzan’	Cimmaron Ash	75L	13m	8m
05	<i>Harpullia pendula</i>	Tulipwood	75L	6m	4m
06	<i>Lophostemon confertus</i>	Brush Box	75L	5m	4m
07	<i>Pistacia chinensis</i>	Chinese Pistachio	75L	10m	6m
08	<i>Prunus cerasifera</i> ‘Oakvale Crimson Spire’	Purple-leaf Cherry Plum	75L	8m	4m
09	<i>Sapium sebiferum</i>	Chinese Tallow Tree	75L	7m	5m
10	<i>Tristaniopsis laurina</i> ‘Luscious’	Water Gum	75L	8m	4m
11	<i>Waterhousea floribunda</i> ‘Green Avenue’	Weeping LillyPilly	75L	15m	9m
12	<i>Zelkova serrata</i> ‘Green Vase’	Green Vase	75L	14m	10m
MASS PLANTED MEDIAN / ROUNDABOUT					
Feature Shrubs					
13	<i>Dietes grandiflora</i>	Wild Iris	140mm	1.2m	1.2m
14	<i>Nandina domestica</i> alba ‘lemon lime’	Coastal Rosemary	140mm	1m	1m
Groundcovers					
15	<i>Myoporum parvifolium</i> ‘Yareena’	Boobialla	140mm	0.1m	2m
PARK PLANTING					
Trees					
-	<i>Backhousia citriodora</i>	Lemon Myrtle	75L	8m	4m
-	<i>Elaeocarpus reticulatus</i>	Blueberry Ash	75L	8m	5m
-	<i>Eucalyptus sideroxylon</i> ‘Rosea’	Red Flowering Ironbark	75L	15m	6m
Low Shrubs					
16	<i>Liriope muscari</i> ‘Just Right’	Liriope	140mm	0.5m	0.5m
17	<i>Lomandra</i> ‘Lime Tuff’	Lime Tuff	140mm		
18	<i>Pennisteam</i> ‘Cream Lea’	Fountain Grass	140mm	1m	1m
19	<i>Westringia</i> ‘Zena’	Coastal Rosemary	140mm	1m	1m
Groundcovers					
20	<i>Carpobrotus glaucescens</i>	Pigface	140mm	0.2m	2.0m
-	<i>Hardenbergia</i> ‘Meema’	Meema	140mm	0.4m	2m
DETENTION BASIN					
-	<i>Austrodanthonia fulva</i>	Wallaby Grass	Tubestock		
-	<i>Dichelachne micranthe</i>	Plum Grass	Tubestock		
-	<i>Echinopogon caespitosus</i>	Hedgehog Grass	Tubestock		
-	<i>Poa labillardieri</i>	Tussock Grass	Tubestock		
-	<i>Themeda australis</i>	Kangaroo Grass	Tubestock		



KEY PLAN



PLANT SCHEDULE

Key	Botanical Name	Common Name	Mature Height	Mature Spread
Canopy Trees				
	<i>Angophoa costata</i>	Smoothbarked Apple Myrtle	20m	12m
	<i>Tristaniopsis laurina</i>	Kanooka Gum	15m	6m
Medium Trees				
	<i>Acacia dealbata</i>	Hickory Wattle	12m	8m
	<i>Acacia implexa</i>	Hickory Wattle	8m	7m
	<i>Elaeocarpus reticulatus</i>	Blueberry Ash	9m	4m
Groundcovers and Grasses				
	<i>Aristida ramosa</i>	Purple Wiregrass	0.9m	0.5m
	<i>Austrostipa aristiglumis</i>	Speargrass	2m	1.2m
	<i>Carpobrotus glaucescens</i>	Pigface	0.3m	2.0m
	<i>Correa alba</i>	White Correa	1.5m	1.5m
	<i>Cyperus gracilis</i>	Slender Flat-sedge	0.3m	0.3m
	<i>Dianella revoluta</i>	Flax Lily	1m	0.8m
	<i>Geranium solanderi</i>	Native Geranium	0.5m	0.5m
	<i>Lomandra filiformis</i>	Mat Rush	0.4m	0.4m
	<i>Themeda triandra</i>	Kangaroo Grass	1.5m	0.5m
	<i>Wahlenbergia communis</i>	Bluebell	0.7m	0.5m

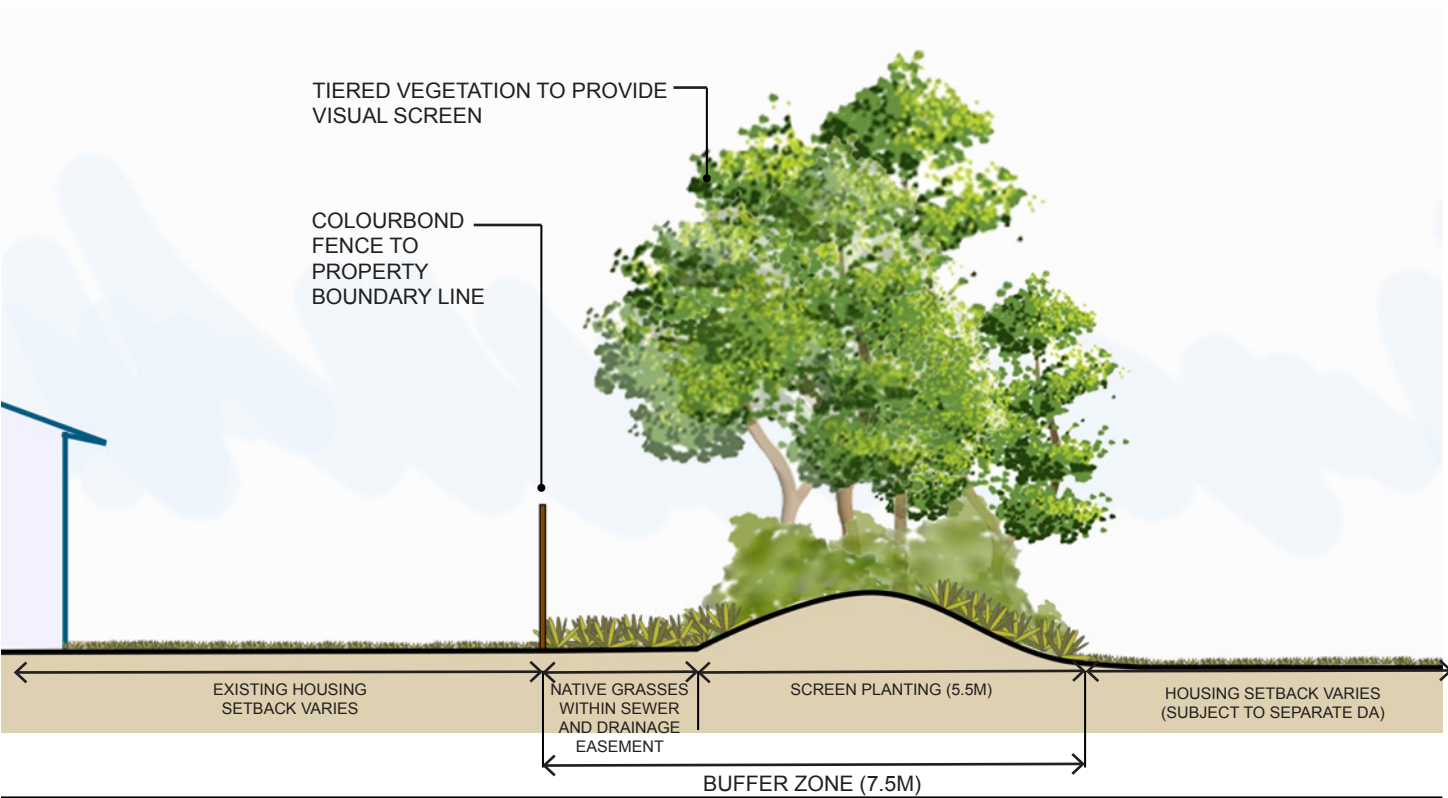

INDICATIVE ELEVATION

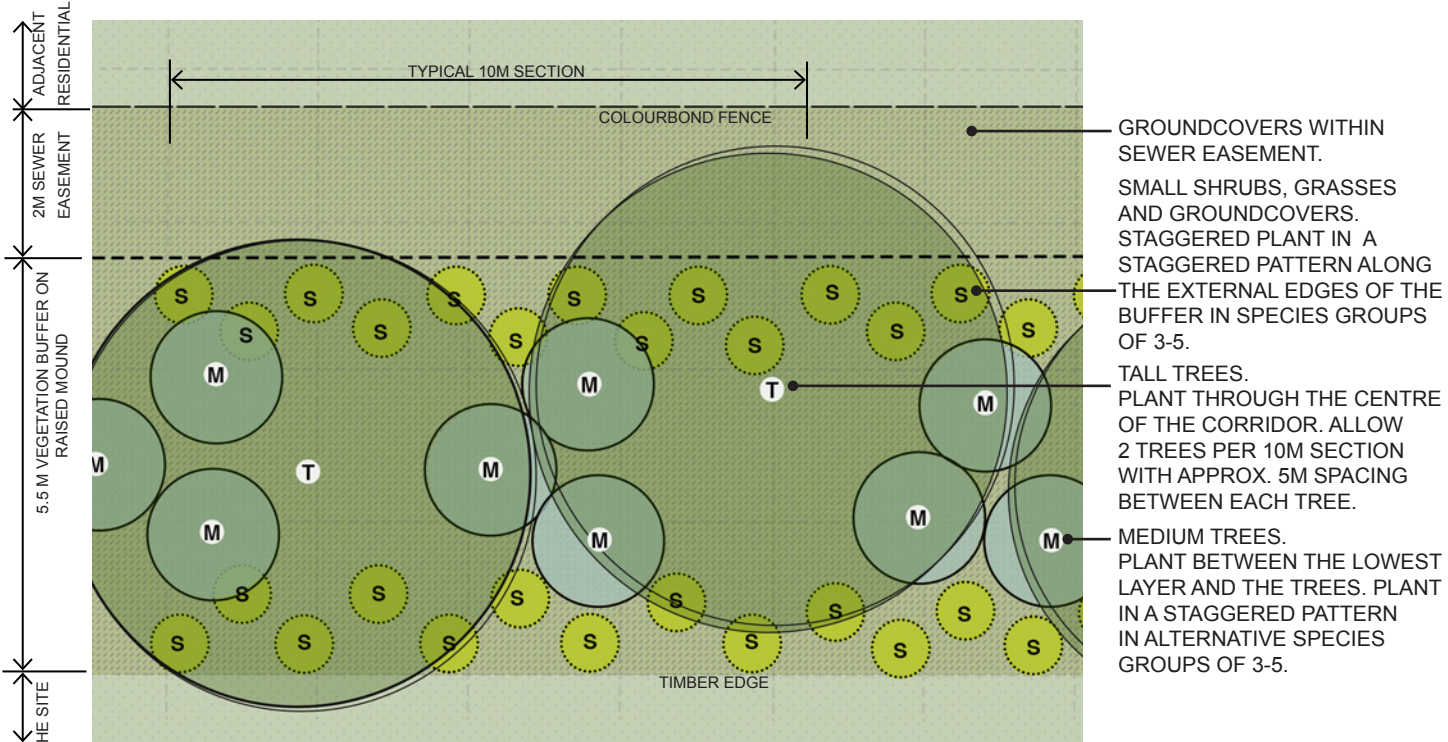

INDICATIVE PLANTING PLAN