

PROJECT
**MAITLAND CITY COUNCIL
ADMINISTRATION BUILDING**

CLIENT
MAITLAND CITY COUNCIL

CIVIL DRAWING LIST

DA-0001 GENERAL ARRANGEMENT PLAN & DRAWING LIST

DA-0002 SOIL & WATER MANAGEMENT PLAN & DETAILS

DA-0003 STORMWATER DRAINAGE PLAN - SHEET 1
DA-0004 STORMWATER DRAINAGE PLAN - SHEET 2
DA-0005 STORMWATER DRAINAGE PLAN - SHEET 3
DA-0006 STORMWATER DRAINAGE PLAN - SHEET 4
DA-0007 STORMWATER DRAINAGE PLAN - SHEET 5
DA-0008 STORMWATER DRAINAGE PLAN - SHEET 6
DA-0009 STORMWATER DRAINAGE PLAN - SHEET 7
DA-0010 STORMWATER DRAINAGE PLAN - SHEET 8
DA-0011 STORMWATER DRAINAGE PLAN - SHEET 9
DA-0012 STORMWATER DRAINAGE DETAILS

DA-0020 EXTERNAL WORKS PLAN

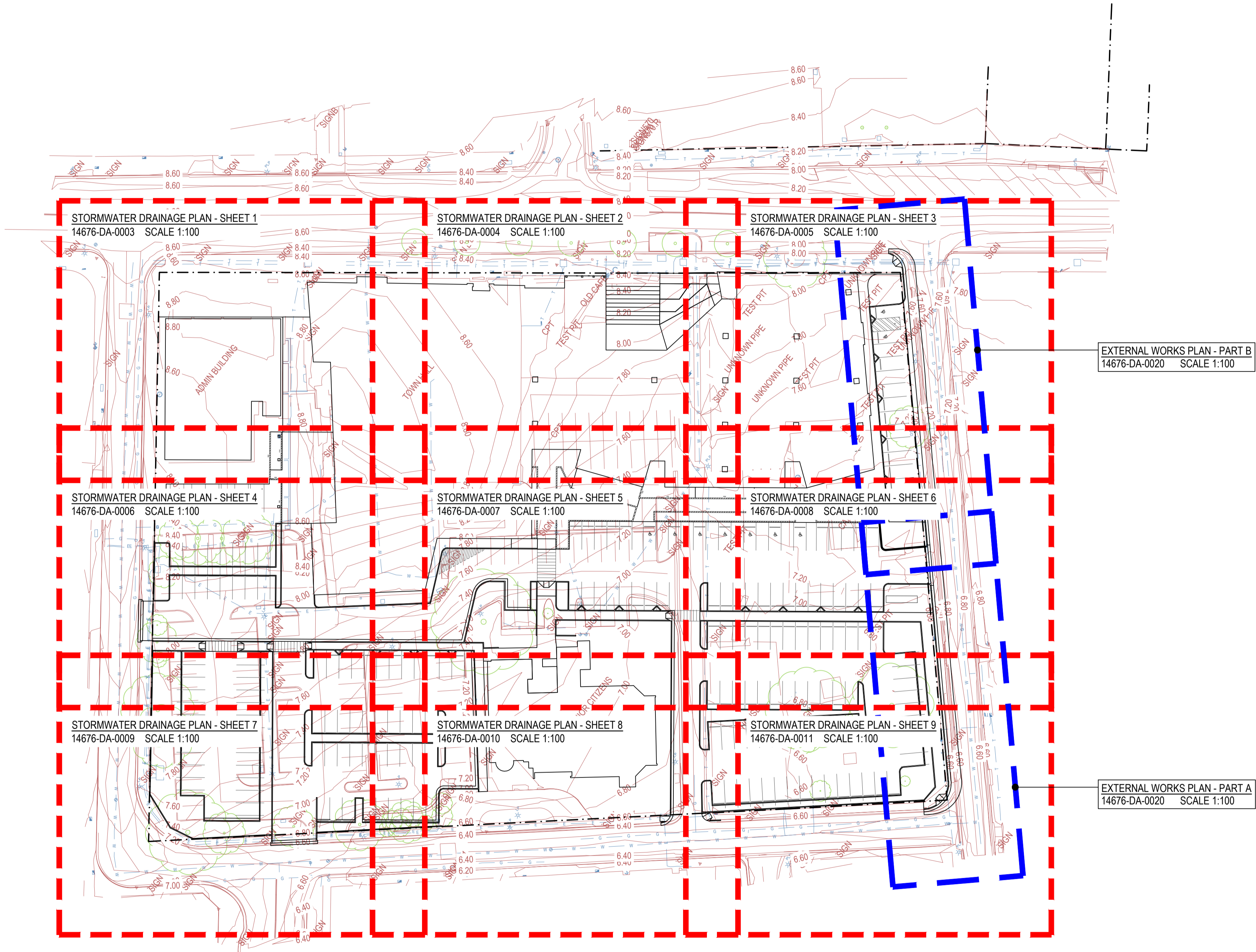

GENERAL ARRANGEMENT PLAN
SCALE 1:500

NOT FOR CONSTRUCTION

| | | | | |
|-----|----------|------------------------|------|------|
| B | 26/03/19 | ISSUED FOR DA APPROVAL | A.V. | A.T. |
| A | 21/03/19 | ISSUED FOR INFORMATION | A.V. | A.T. |
| REV | DATE | DRAWING STATUS | DRN | APP |

**GENERAL ARRANGEMENT PLAN
& DRAWING LIST**

| | | | |
|-----------------|------------------------|-----------------------|----------------|
| DRAWING STATUS | | | SHEET SIZE |
| FOR APPROVAL | | | A1 |
| DRAWN A.Vizl | DESIGNED A.Thompson | APPROVED B.Rodgers | SCALE 1:500 |
| PROJECT No. | DRAWING No. | REVISION | |

14676 DA-0001 B

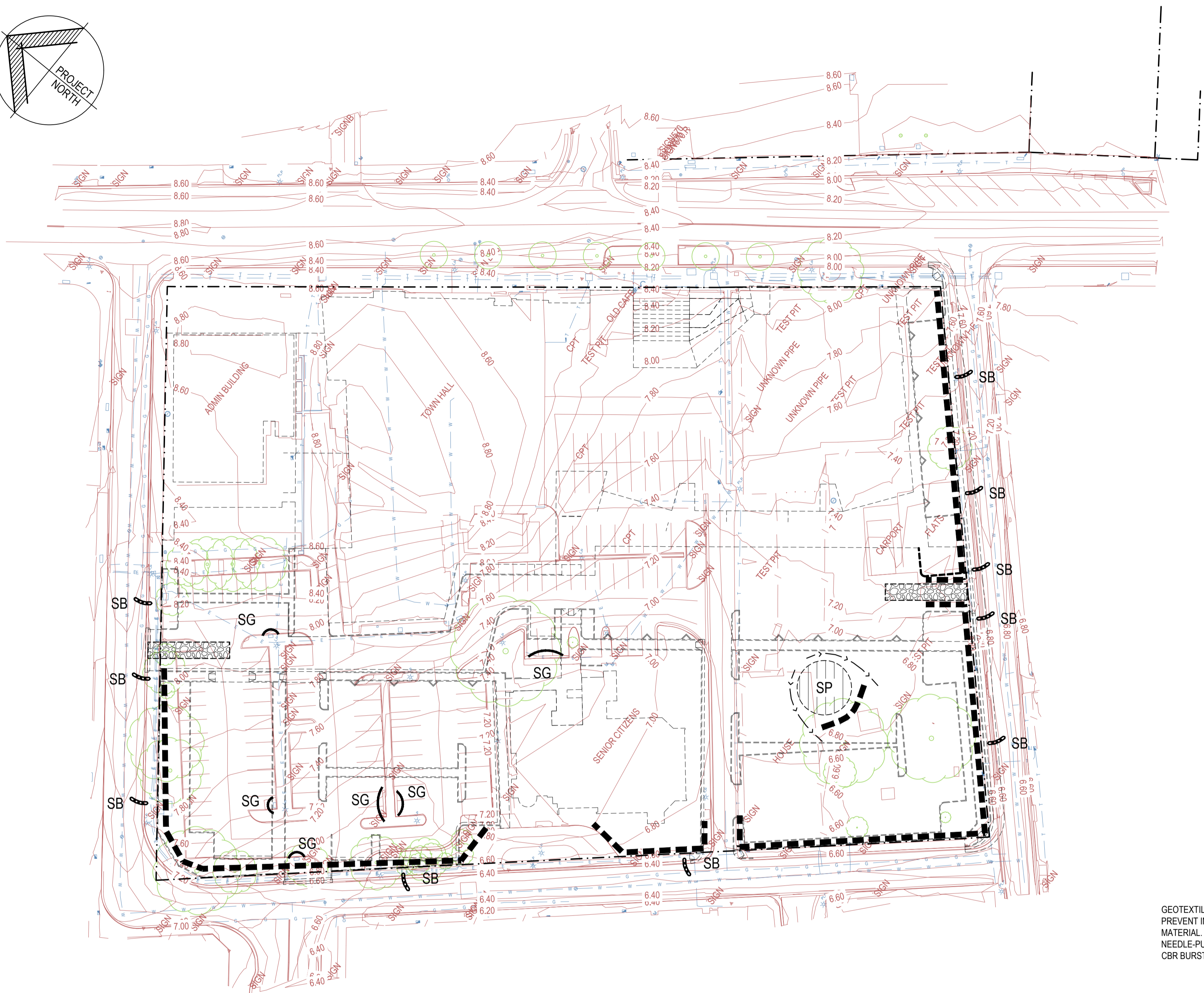
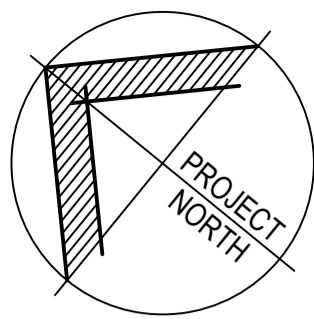

SOIL & WATER MANAGEMENT PLAN

SCALE 1:500

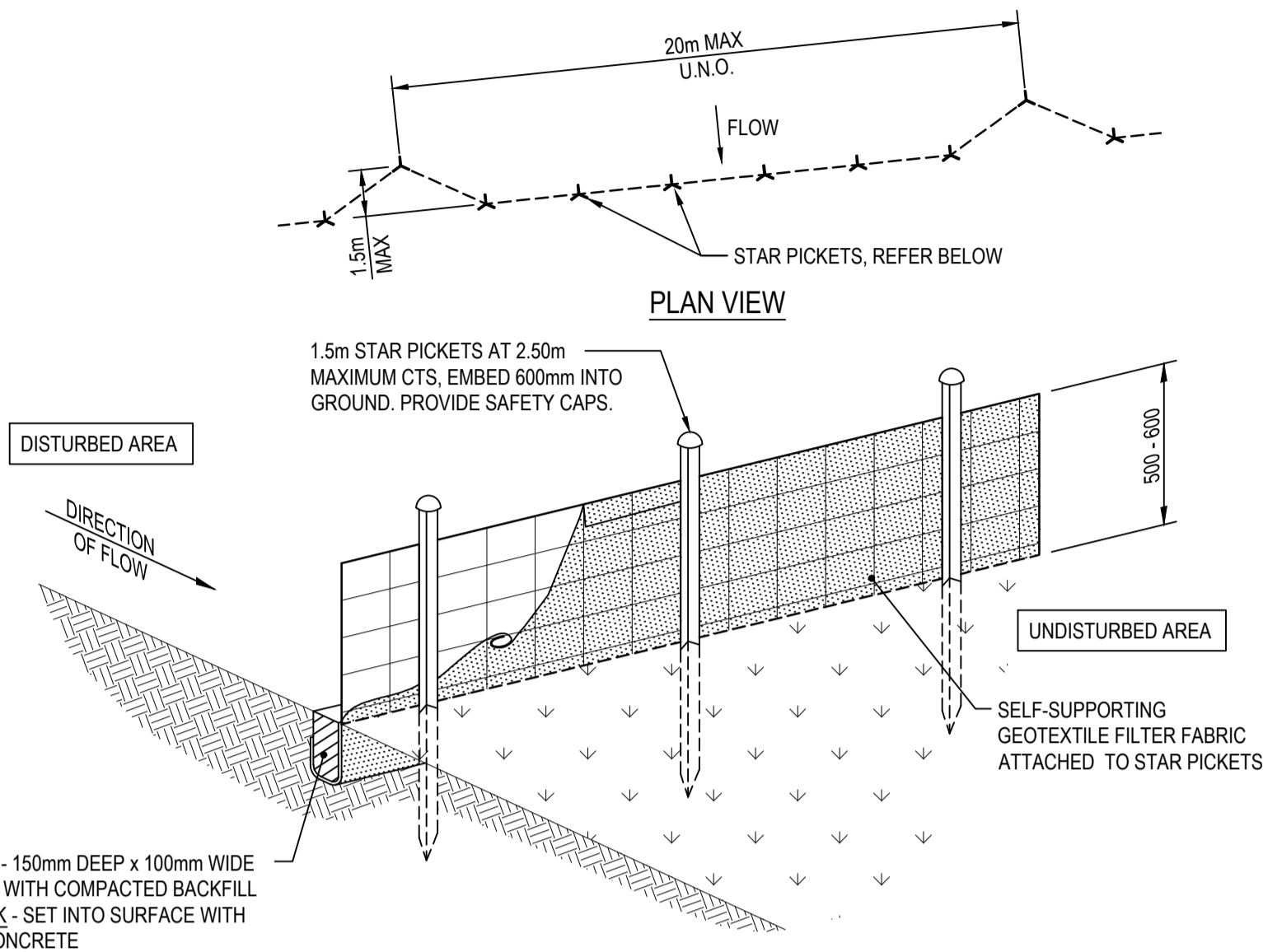

SEDIMENT CONTROL FENCE DETAIL

N.T.S.
IN ACCORDANCE WITH LANDCOM 'BLUE BOOK'
SD6-8 SEDIMENT FENCE

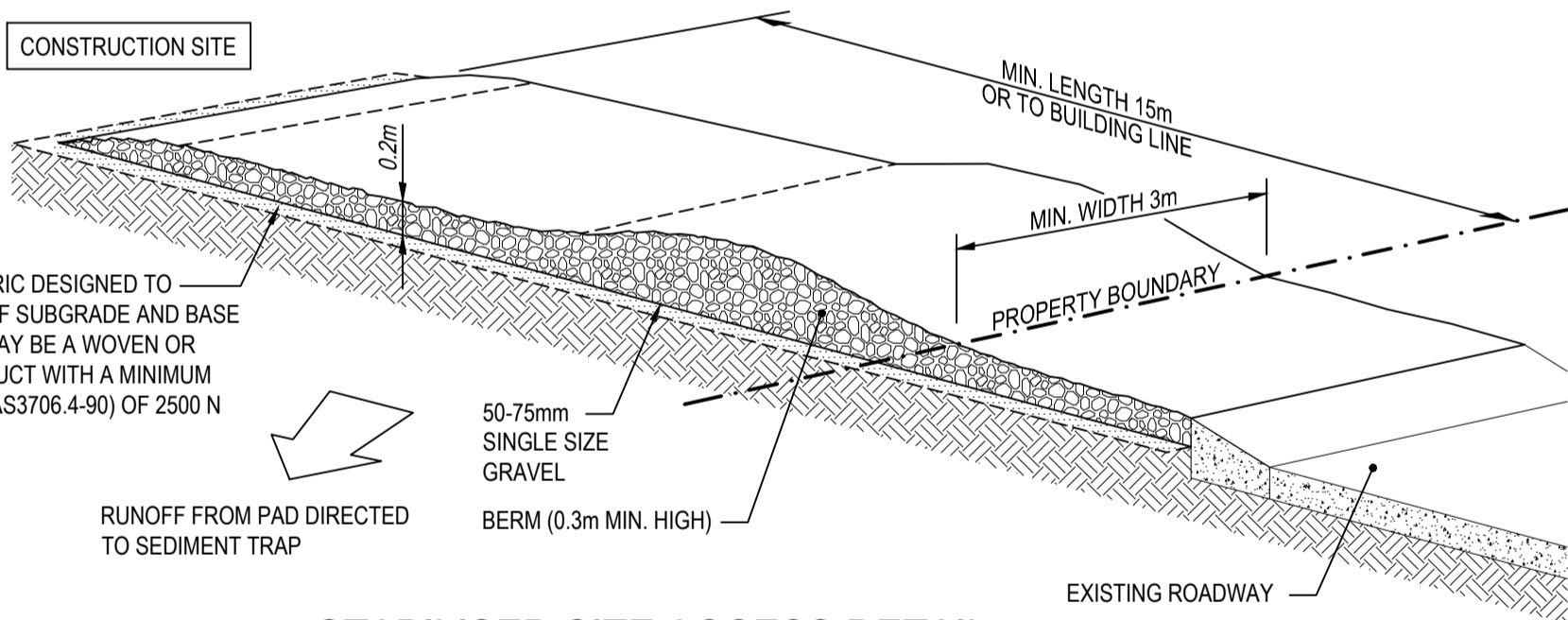

STABILISED SITE ACCESS DETAIL

N.T.S.
IN ACCORDANCE WITH LANDCOM 'BLUE BOOK'
SD6-14 STABILISED SITE ACCESS

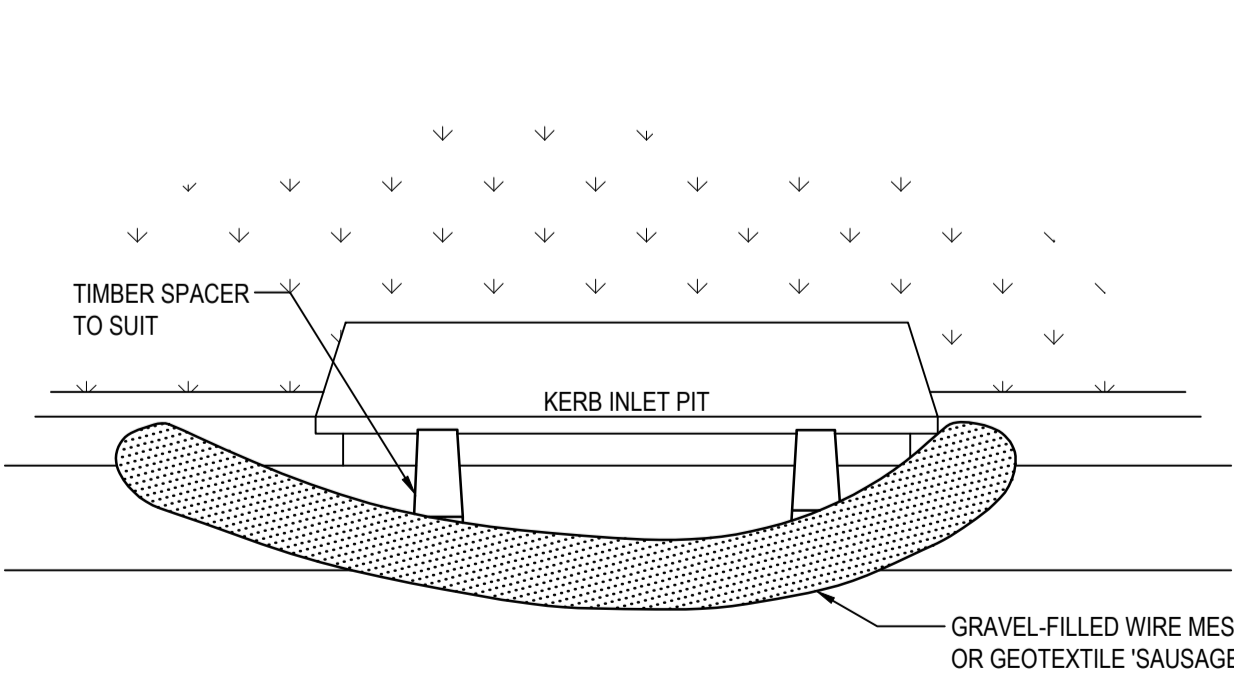

SAUSAGE INLET SEDIMENT TRAP DETAIL - SG

N.T.S.
IN ACCORDANCE WITH LANDCOM 'BLUE BOOK'
SD6-11 MESH AND GRAVEL INLET FILTER

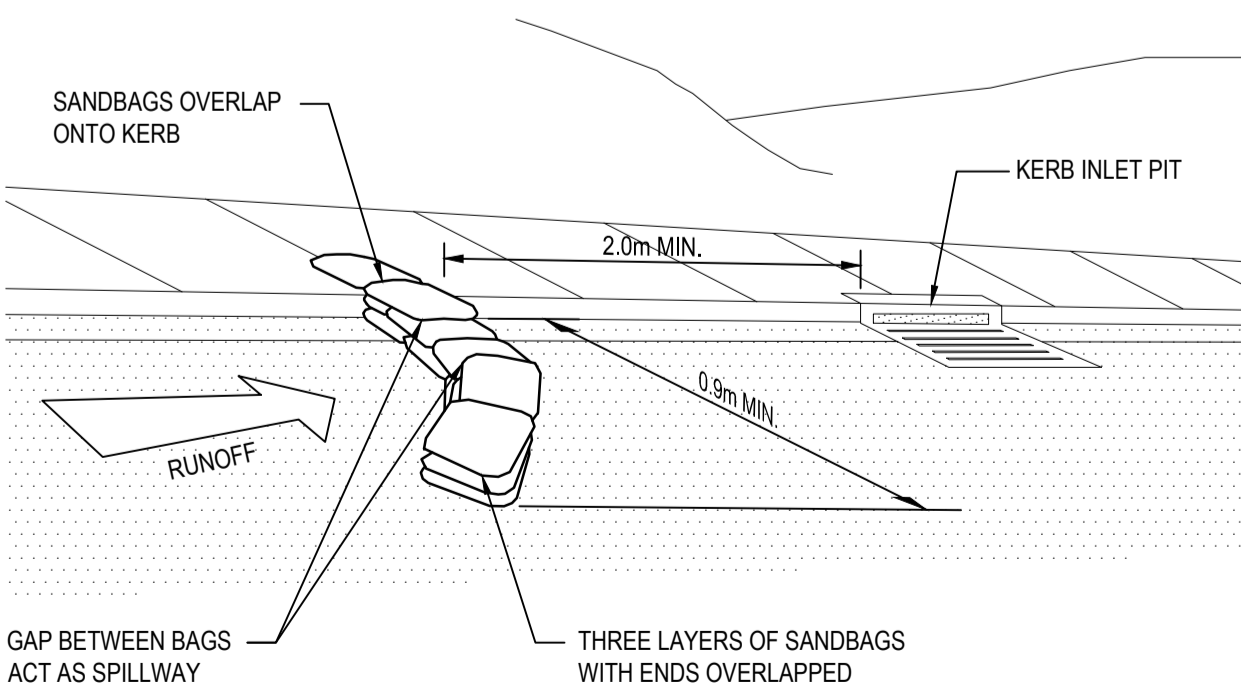

SANDBAG INLET SEDIMENT TRAP DETAIL - SB

N.T.S.

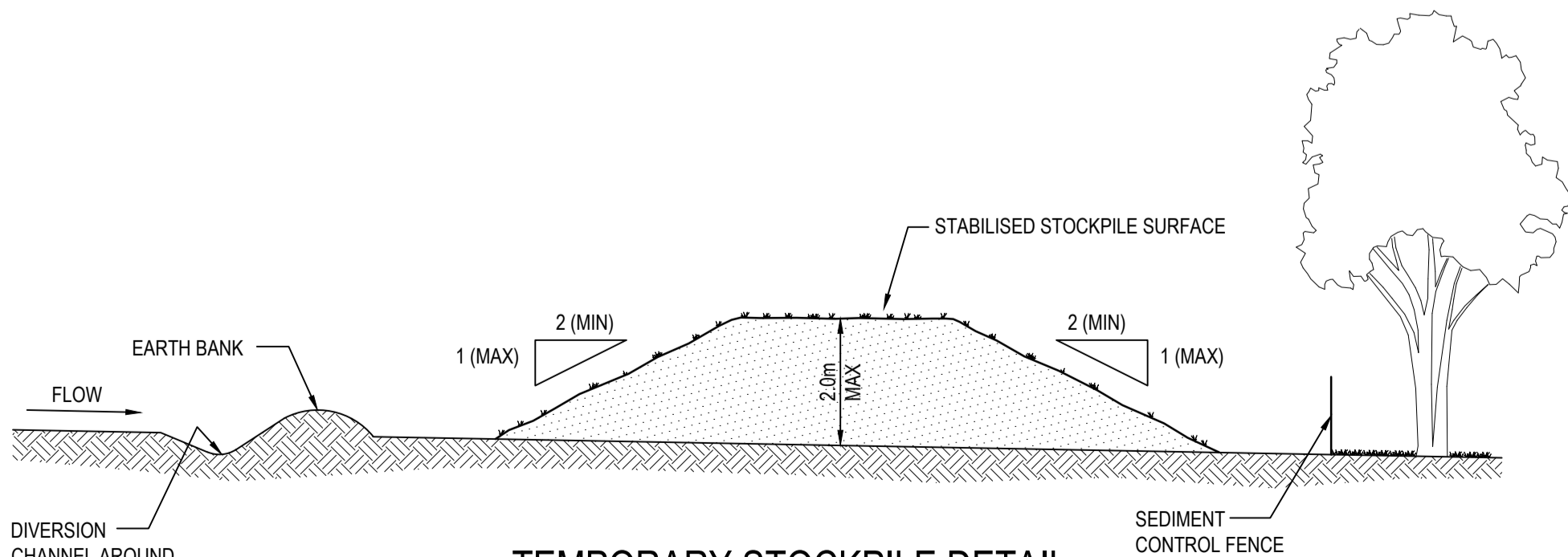

TEMPORARY STOCKPILE DETAIL

N.T.S.
IN ACCORDANCE WITH LANDCOM 'BLUE BOOK'
SD4-1 STOCKPILES

PROJECT
**MAITLAND CITY COUNCIL
ADMINISTRATION BUILDING**

CLIENT
MAITLAND CITY COUNCIL

LEGEND

- EXISTING CONTOUR
- SEDIMENT CONTROL FENCE, REFER TO DETAIL
- STABILISED SITE ACCESS, REFER TO DETAIL
- SB SANDBAG INLET SEDIMENT TRAP, REFER TO DETAIL
- SG SAUSAGE INLET SEDIMENT TRAP, REFER TO DETAIL
- SP TEMPORARY STOCKPILE, REFER TO DETAIL
- EXISTING ELECTRICAL SERVICE
- EXISTING GAS SERVICE
- EXISTING SEWER SERVICE
- EXISTING TELSTRA SERVICE
- EXISTING WATER SERVICE
- BOUNDARY LINE
- EXISTING FENCE
- EXISTING TREE

NOTES

THE ARRANGEMENT OF SOIL & WATER MANAGEMENT MEASURES SHOWN ARE INDICATIVE ONLY AND RELATE TO A PARTICULAR STAGE OF THE CONSTRUCTION WORKS. IT SHALL BE THE CONTRACTOR'S RESPONSIBILITY TO DESIGN, CONSTRUCT AND MAINTAIN ANY ADDITIONAL MEASURES THAT MAY BE REQUIRED FOR THE CONTRACTOR'S CONSTRUCTION METHODOLOGIES, IN ORDER TO MEET ALL CONDITIONS AND REQUIREMENTS IMPOSED BY ANY STATUTORY AUTHORITY.

THE POSITION OF ALL EXISTING SERVICES SHOWN SHOULD BE REGARDED AS APPROXIMATE AND NOT NECESSARILY COMPREHENSIVE. IT IS THE CONTRACTOR'S RESPONSIBILITY TO DETERMINE THE EXACT LOCATIONS OF ALL SERVICES WHETHER SHOWN ON THE DRAWING OR NOT AND INFORM ALL RELEVANT AUTHORITIES PRIOR TO ANY EXCAVATION.

CONTRACTOR TO VERIFY SETOUT BEFORE COMMENCING EARTHWORKS. REFER ANY DISCREPANCIES TO ENGINEER.

ALL EXPOSED/DISTURBED AREAS TO BE TREATED IN ACCORDANCE WITH ARCHITECTS REQUIREMENTS.

EXISTING CONTOURS ARE SHOWN AT 0.20m INTERVALS.

| | | | | |
|-----|----------|------------------------|------|------|
| A | 26/03/19 | ISSUED FOR DA APPROVAL | A.V. | A.T. |
| REV | DATE | DRAWING STATUS | DRN | APP |

**SOIL & WATER MANAGEMENT
PLAN & DETAILS**

| DRAWING STATUS | | | SHEET SIZE | |
|----------------|------------|-------------|------------|--|
| FOR APPROVAL | | | A1 | |
| DRAWN | DESIGNED | APPROVED | SCALE | |
| A.Vizl | A.Thompson | B.Rodgers | 1:500 | |
| PROJECT No. | | DRAWING No. | REVISION | |

NOT FOR CONSTRUCTION

14676 DA-0002 A

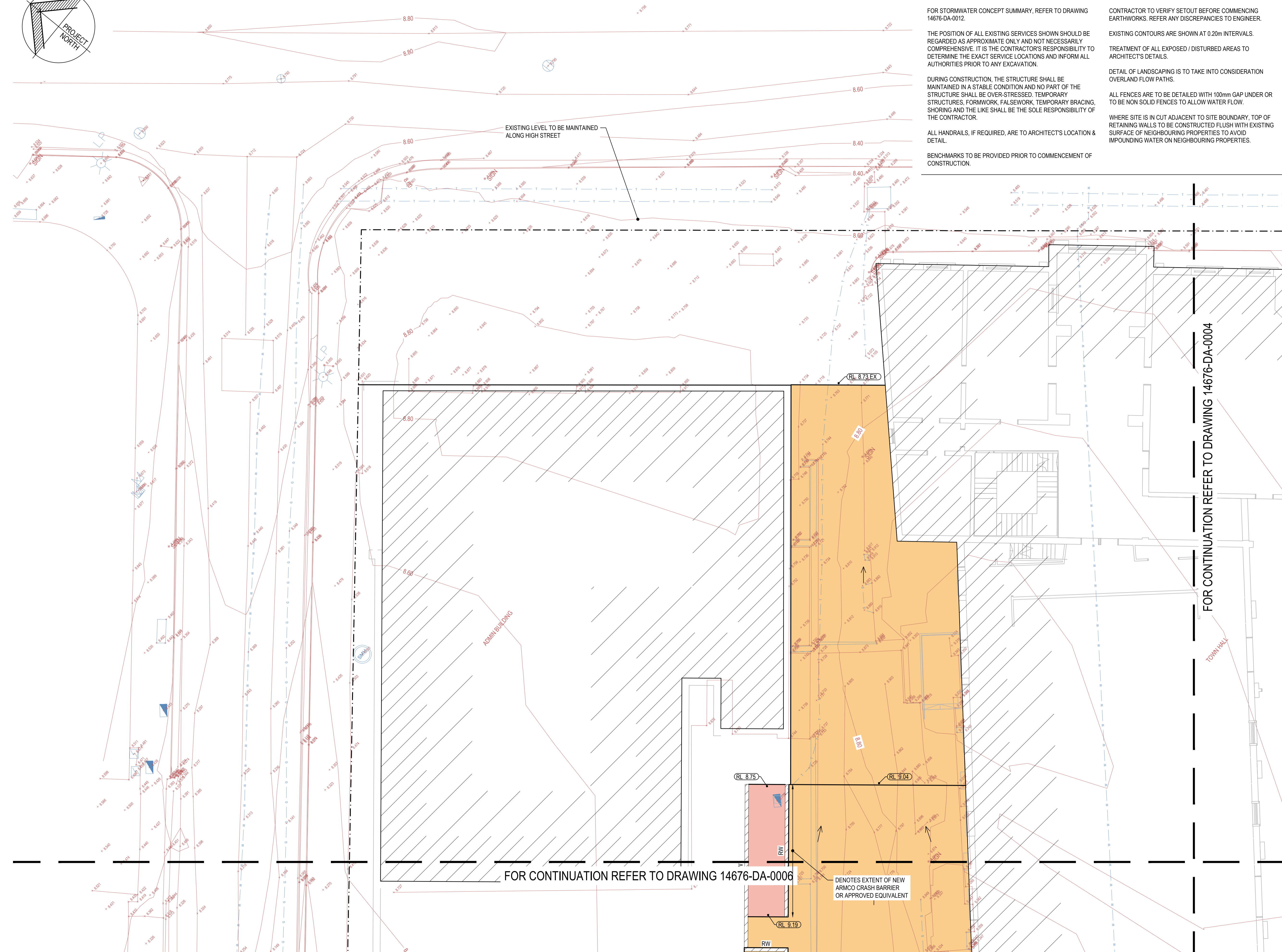

BENCHMARKS TO BE PROVIDED PRIOR TO COMMENCEMENT OF CONSTRUCTION.

| | | |
|-------|---------|---|
| 14676 | DA-0003 | B |
|-------|---------|---|

| | |
|-------|---------|
| 14676 | DA-0003 |
|-------|---------|

DO NOT SCALE - THIS DRAWING MAY BE A REDUCED COPY

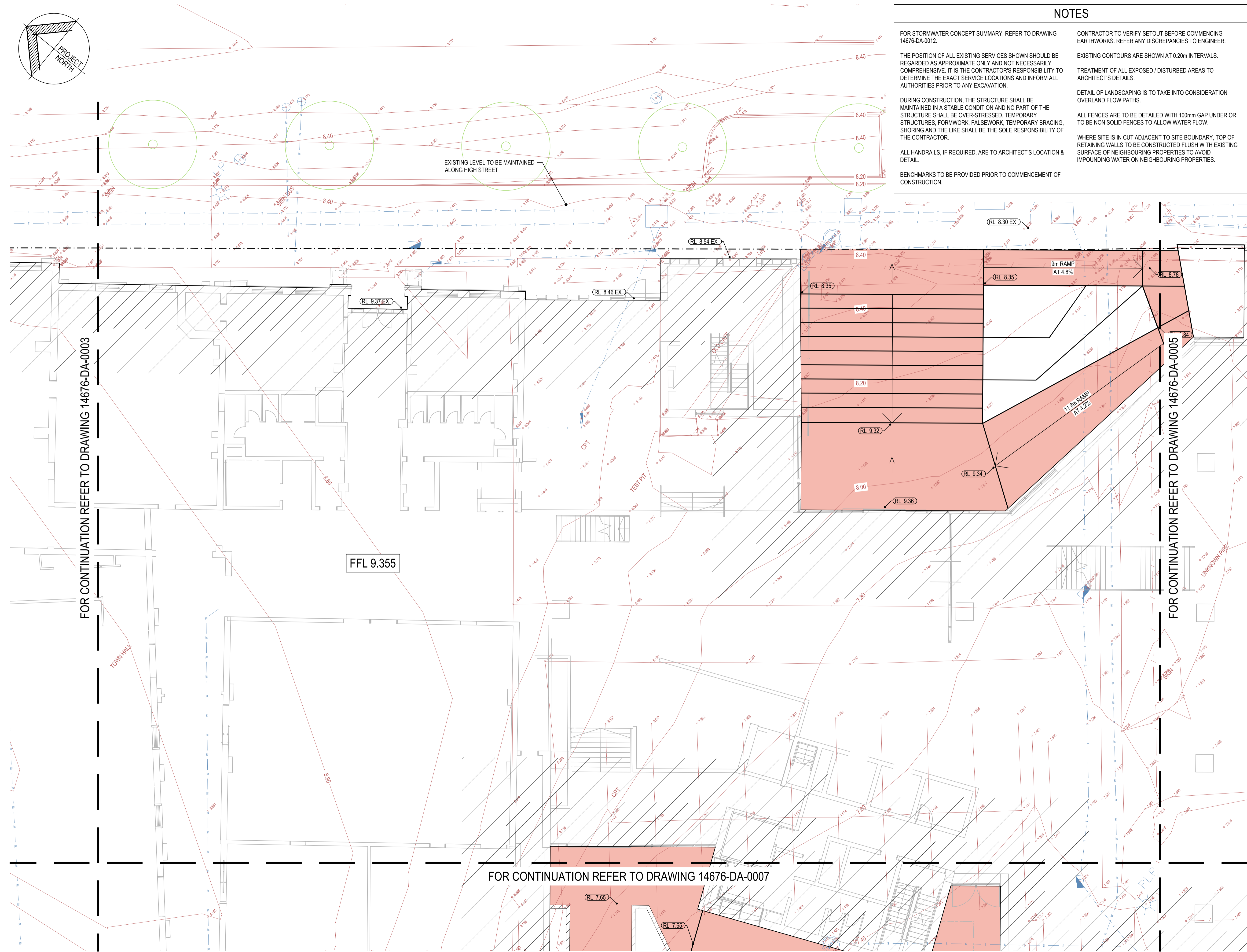
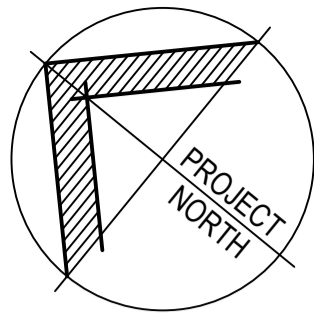

NOTES

FOR STORMWATER CONCEPT SUMMARY, REFER TO DRAWING 14676-DA-0012.

THE POSITION OF ALL EXISTING SERVICES SHOWN SHOULD BE REGARDED AS APPROXIMATE ONLY AND NOT NECESSARILY COMPREHENSIVE. IT IS THE CONTRACTOR'S RESPONSIBILITY TO DETERMINE THE EXACT SERVICE LOCATIONS AND INFORM ALL AUTHORITIES PRIOR TO ANY EXCAVATION.

DURING CONSTRUCTION, THE STRUCTURE SHALL BE MAINTAINED IN A STABLE CONDITION AND NO PART OF THE STRUCTURE SHALL BE OVER-STRESSED. TEMPORARY STRUCTURES, FORMWORK, FALSEWORK, TEMPORARY BRACING, SHORING AND THE LIKE SHALL BE THE SOLE RESPONSIBILITY OF THE CONTRACTOR.

ALL HANDRAILS, IF REQUIRED, ARE TO ARCHITECT'S LOCATION & DETAIL.

BENCHMARKS TO BE PROVIDED PRIOR TO COMMENCEMENT OF CONSTRUCTION.

CONTRACTOR TO VERIFY SETOUT BEFORE COMMENCING EARTHWORKS. REFER ANY DISCREPANCIES TO ENGINEER.

EXISTING CONTOURS ARE SHOWN AT 0.20m INTERVALS.

TREATMENT OF ALL EXPOSED / DISTURBED AREAS TO ARCHITECT'S DETAILS.

DETAIL OF LANDSCAPING IS TO TAKE INTO CONSIDERATION OVERLAND FLOW PATHS.

ALL FENCES ARE TO BE DETAILED WITH 100mm GAP UNDER OR TO BE NON SOLID FENCES TO ALLOW WATER FLOW.

WHERE SITE IS IN CUT ADJACENT TO SITE BOUNDARY, TOP OF RETAINING WALLS TO BE CONSTRUCTED FLUSH WITH EXISTING SURFACE OF NEIGHBOURING PROPERTIES TO AVOID IMPOUNDING WATER ON NEIGHBOURING PROPERTIES.



Sydney | Perth | **Newcastle** | Central Coast

Suite 2 Ground Floor 47 Darby Street Cooks Hill NSW 2300
T: +61 2 49419900 E: mail@lindsaydynan.com.au

PROJECT
MAITLAND CITY COUNCIL
ADMINISTRATION BUILDING

CLIENT
MAITLAND CITY COUNCIL

LEGEND

- 8.00 EXISTING CONTOUR
- EXISTING SPOTLEVEL
- RL 7.00 DESIGN SPOTLEVEL
- NEW STORMWATER DRAINAGE PIT, INSTALLED TO MANUFACTURER'S SPECIFICATIONS
- NEW PVC STORMWATER DRAINAGE PIPE LAID AT 1.0% MIN FALL (U.N.O.) IN ACCORDANCE WITH MANUFACTURER'S SPECIFICATIONS
- Ø100 SUBSOIL DRAINAGE PIPE C/W FILTER SOCK, LAID AT 1.0% MIN FALL TO OUTLET
- GRATED DRAIN 150 MIN. (WIDE) x 150 MIN. (DEEP), 1% MIN FALL TO OUTLET
- NEW OPEN DRAINAGE SWALE, REFER TO PLAN FOR FURTHER DETAILS
- OVERLAND FLOW PATH
- DIRECTION OF SURFACE FALL
- NEW ASPHALT CARPARK PAVEMENT, DETAILS TO BE PROVIDED AT CC STAGE
- NEW CONCRETE FOOTPATH PAVEMENT, DETAILS TO BE PROVIDED AT CC STAGE
- NEW ASPHALT ROAD PAVEMENT, DETAILS TO BE PROVIDED AT CC STAGE
- NEW RETAINING WALL
- EXISTING ELECTRICAL SERVICE
- EXISTING GAS SERVICE
- EXISTING SEWER SERVICE
- EXISTING TELSTRA SERVICE
- EXISTING WATER SERVICE
- BOUNDARY LINE
- EXISTING FENCE
- EXISTING TREE

| | | | | |
|-------|----------|------------------------|------|------|
| B | 26/03/19 | ISSUED FOR DA APPROVAL | A.V. | A.T. |
| A | 21/03/19 | ISSUED FOR INFORMATION | A.V. | A.T. |
| REV | DATE | DRAWING STATUS | DRN | APP |
| TITLE | | | | |

STORMWATER DRAINAGE PLAN SHEET 2

| DRAWING STATUS | | | SHEET SIZE | |
|----------------|------------|-------------|------------|--|
| FOR APPROVAL | | | A1 | |
| DRAWN | DESIGNED | APPROVED | SCALE | |
| A.Vizl | A.Thompson | B.Rodgers | 1:100 | |
| PROJECT No. | | DRAWING No. | REVISION | |

14676 DA-0004 B

STORMWATER DRAINAGE PLAN - SHEET 2

SCALE 1:100

NOT FOR CONSTRUCTION

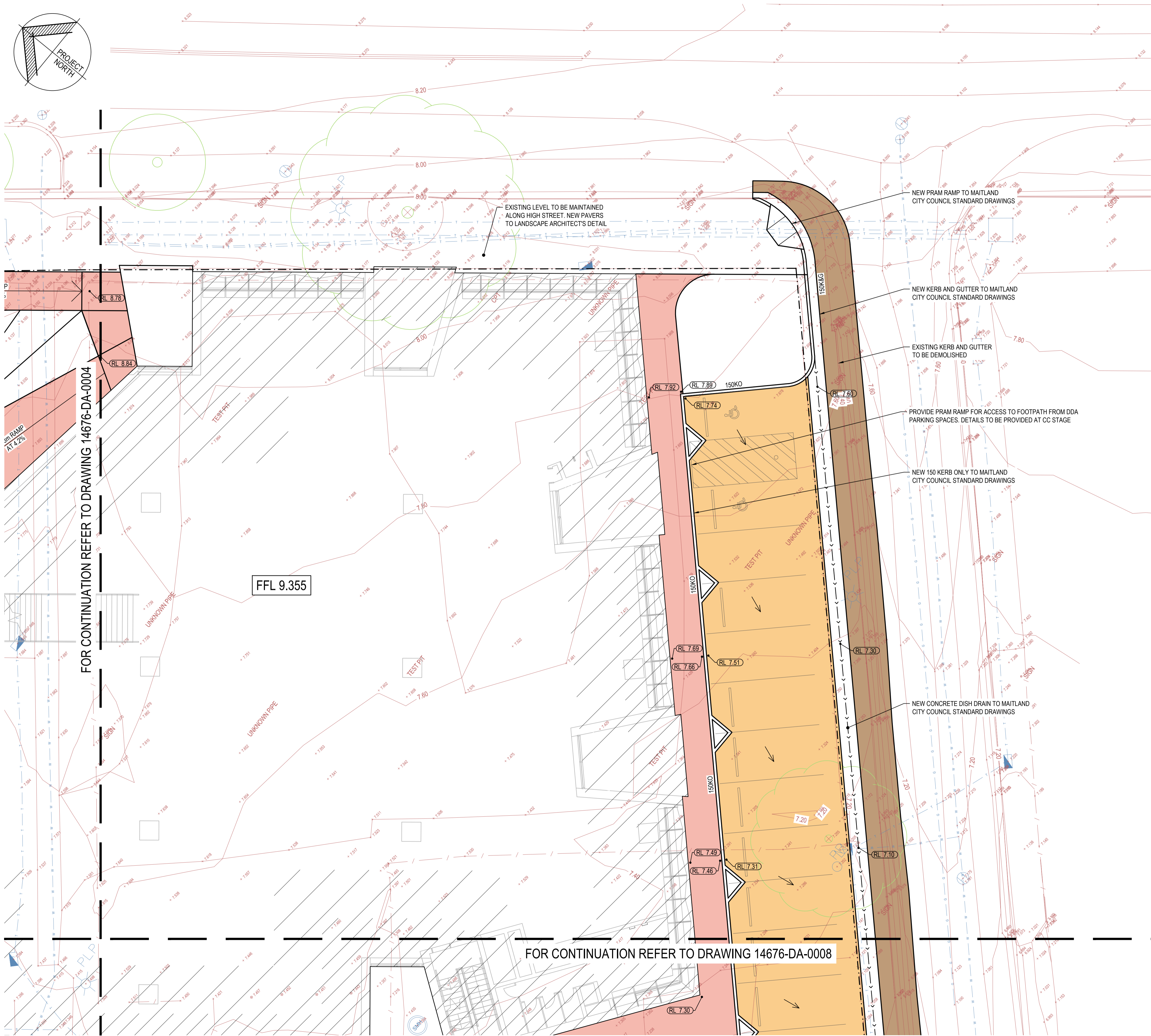
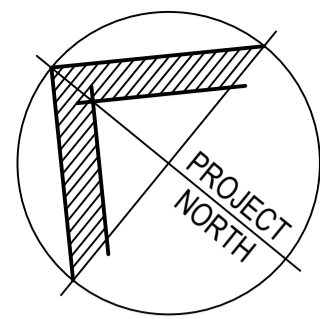

NOTES

FOR STORMWATER CONCEPT SUMMARY, REFER TO DRAWING 14676-DA-0012.

THE POSITION OF ALL EXISTING SERVICES SHOWN SHOULD BE REGARDED AS APPROXIMATE ONLY AND NOT NECESSARILY COMPREHENSIVE. IT IS THE CONTRACTOR'S RESPONSIBILITY TO DETERMINE THE EXACT SERVICE LOCATIONS AND INFORM ALL AUTHORITIES PRIOR TO ANY EXCAVATION.

DURING CONSTRUCTION, THE STRUCTURE SHALL BE MAINTAINED IN A STABLE CONDITION AND NO PART OF THE STRUCTURE SHALL BE OVER-STRESSED. TEMPORARY STRUCTURES, FORMWORK, FALSEWORK, TEMPORARY BRACING, SHORING AND THE LIKE SHALL BE THE SOLE RESPONSIBILITY OF THE CONTRACTOR.

ALL HANDRAILS, IF REQUIRED, ARE TO ARCHITECT'S LOCATION & DETAIL.

BENCHMARKS TO BE PROVIDED PRIOR TO COMMENCEMENT OF CONSTRUCTION.

CONTRACTOR TO VERIFY SETOUT BEFORE COMMENCING EARTHWORKS. REFER ANY DISCREPANCIES TO ENGINEER.

EXISTING CONTOURS ARE SHOWN AT 0.20m INTERVALS.

TREATMENT OF ALL EXPOSED / DISTURBED AREAS TO ARCHITECT'S DETAILS.

DETAIL OF LANDSCAPING IS TO TAKE INTO CONSIDERATION OVERLAND FLOW PATHS.

ALL FENCES ARE TO BE DETAILED WITH 100mm GAP UNDER OR TO BE NON SOLID FENCES TO ALLOW WATER FLOW.

WHERE SITE IS IN CUT ADJACENT TO SITE BOUNDARY, TOP OF RETAINING WALLS TO BE CONSTRUCTED FLUSH WITH EXISTING SURFACE OF NEIGHBOURING PROPERTIES TO AVOID IMPOUNDING WATER ON NEIGHBOURING PROPERTIES.



Sydney | Perth | Newcastle | Central Coast

Suite 2 Ground Floor 47 Darby Street Cooks Hill NSW 2300
T: +61 2 49419900 E: mail@lindsaydynan.com.au

PROJECT

MAITLAND CITY COUNCIL
ADMINISTRATION BUILDING

CLIENT

MAITLAND CITY COUNCIL

LEGEND

- EXISTING CONTOUR
- EXISTING SPOTLEVEL
- DESIGN SPOTLEVEL
- NEW STORMWATER DRAINAGE PIT, INSTALLED TO MANUFACTURER'S SPECIFICATIONS
- NEW PVC STORMWATER DRAINAGE PIPE LAID AT 1.0% MIN FALL (U.N.O.) IN ACCORDANCE WITH MANUFACTURER'S SPECIFICATIONS
- Ø100 SUBSOIL DRAINAGE PIPE C/W FILTER SOCK, LAID AT 1.0% MIN FALL TO OUTLET
- GRATED DRAIN 150 MIN. (WIDE) x 150 MIN. (DEEP), 1% MIN FALL TO OUTLET
- NEW OPEN DRAINAGE SWALE, REFER TO PLAN FOR FURTHER DETAILS
- OVERLAND FLOW PATH
- DIRECTION OF SURFACE FALL
- NEW ASPHALT CARPARK PAVEMENT, DETAILS TO BE PROVIDED AT CC STAGE
- NEW CONCRETE FOOTPATH PAVEMENT, DETAILS TO BE PROVIDED AT CC STAGE
- NEW ASPHALT ROAD PAVEMENT, DETAILS TO BE PROVIDED AT CC STAGE
- NEW RETAINING WALL
- EXISTING ELECTRICAL SERVICE
- EXISTING GAS SERVICE
- EXISTING SEWER SERVICE
- EXISTING TELSTRA SERVICE
- EXISTING WATER SERVICE
- BOUNDARY LINE
- EXISTING FENCE
- EXISTING TREE

| | | | | |
|-------|----------|------------------------|------|------|
| B | 26/03/19 | ISSUED FOR DA APPROVAL | A.V. | A.T. |
| A | 21/03/19 | ISSUED FOR INFORMATION | A.V. | A.T. |
| REV | DATE | DRAWING STATUS | DRN | APP |
| TITLE | | | | |

STORMWATER DRAINAGE PLAN
SHEET 3

| | | | |
|-----------------|------------------------|-----------------------|----------------|
| DRAWING STATUS | | | SHEET SIZE |
| FOR APPROVAL | | | A1 |
| DRAWN A.Vizl | DESIGNED A.Thompson | APPROVED B.Rodgers | SCALE 1:100 |
| PROJECT No. | | DRAWING No. | REVISION |

14676 DA-0005 B

STORMWATER DRAINAGE PLAN - SHEET 3

SCALE 1:100

NOT FOR CONSTRUCTION



| | | |
|-------|---------|---|
| 14676 | DA-0006 | B |
|-------|---------|---|

NOTES

FOR STORMWATER CONCEPT SUMMARY, REFER TO DRAWING 14676-DA-0012.

THE POSITION OF ALL EXISTING SERVICES SHOWN SHOULD BE REGARDED AS APPROXIMATE ONLY AND NOT NECESSARILY COMPREHENSIVE. IT IS THE CONTRACTOR'S RESPONSIBILITY TO DETERMINE THE EXACT SERVICE LOCATIONS AND INFORM ALL AUTHORITIES PRIOR TO ANY EXCAVATION.

DURING CONSTRUCTION, THE STRUCTURE SHALL BE MAINTAINED IN A STABLE CONDITION AND NO PART OF THE STRUCTURE SHALL BE OVER-STRESSED. TEMPORARY STRUCTURES, FORMWORK, FALSEWORK, TEMPORARY BRACING, SHORING AND THE LIKE SHALL BE THE SOLE RESPONSIBILITY OF THE CONTRACTOR.

ALL HANDRAILS, IF REQUIRED, ARE TO ARCHITECT'S LOCATION & DETAIL.

BENCHMARKS TO BE PROVIDED PRIOR TO COMMENCEMENT OF CONSTRUCTION.

CONTRACTOR TO VERIFY SETOUT BEFORE COMMENCING EARTHWORKS. REFER ANY DISCREPANCIES TO ENGINEER.

EXISTING CONTOURS ARE SHOWN AT 0.20m INTERVALS.

TREATMENT OF ALL EXPOSED / DISTURBED AREAS TO ARCHITECT'S DETAILS.

DETAIL OF LANDSCAPING IS TO TAKE INTO CONSIDERATION OVERLAND FLOW PATHS.

ALL FENCES ARE TO BE DETAILED WITH 100mm GAP UNDER OR TO BE NON SOLID FENCES TO ALLOW WATER FLOW.

WHERE SITE IS IN CUT ADJACENT TO SITE BOUNDARY, TOP OF RETAINING WALLS TO BE CONSTRUCTED FLUSH WITH EXISTING SURFACE OF NEIGHBOURING PROPERTIES TO AVOID IMPOUNDING WATER ON NEIGHBOURING PROPERTIES.

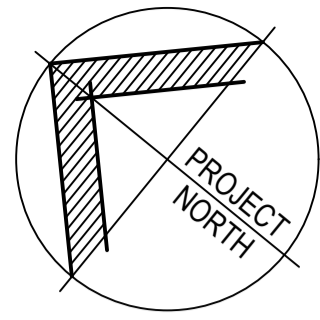

FOR CONTINUATION REFER TO DRAWING 14676-DA-0004

FOR CONTINUATION REFER TO DRAWING 14676-DA-0010

STORMWATER DRAINAGE PLAN - SHEET 5

SCALE 1:100



Sydney | Perth | **Newcastle** | Central Coast

Suite 2 Ground Floor 47 Darby Street Cooks Hill NSW 2300
T: +61 2 49419900 E: mail@lindsaydynan.com.au

PROJECT
**MAITLAND CITY COUNCIL
ADMINISTRATION BUILDING**

CLIENT
MAITLAND CITY COUNCIL

LEGEND

- EXISTING CONTOUR
- EXISTING SPOTLEVEL
- DESIGN SPOTLEVEL
- NEW STORMWATER DRAINAGE PIT, INSTALLED TO MANUFACTURER'S SPECIFICATIONS
- NEW PVC STORMWATER DRAINAGE PIPE LAID AT 1.0% MIN FALL (U.N.O.) IN ACCORDANCE WITH MANUFACTURER'S SPECIFICATIONS
- Ø100 SUBSOIL DRAINAGE PIPE C/W FILTER SOCK, LAID AT 1.0% MIN FALL TO OUTLET
- GRATED DRAIN 150 MIN. (WIDE) x 150 MIN. (DEEP), 1% MIN FALL TO OUTLET
- NEW OPEN DRAINAGE SWALE, REFER TO PLAN FOR FURTHER DETAILS
- OVERLAND FLOW PATH
- DIRECTION OF SURFACE FALL
- NEW ASPHALT CARPARK PAVEMENT, DETAILS TO BE PROVIDED AT CC STAGE
- NEW CONCRETE FOOTPATH PAVEMENT, DETAILS TO BE PROVIDED AT CC STAGE
- NEW ASPHALT ROAD PAVEMENT, DETAILS TO BE PROVIDED AT CC STAGE
- NEW RETAINING WALL
- EXISTING ELECTRICAL SERVICE
- EXISTING GAS SERVICE
- EXISTING SEWER SERVICE
- EXISTING TELSTRA SERVICE
- EXISTING WATER SERVICE
- BOUNDARY LINE
- EXISTING FENCE
- EXISTING TREE

| | | | | |
|---|----------|---------------------------|------|------|
| C | 27/03/19 | RE-ISSUED FOR DA APPROVAL | A.T. | A.T. |
| B | 26/03/19 | ISSUED FOR DA APPROVAL | A.V. | A.T. |
| A | 21/03/19 | ISSUED FOR INFORMATION | A.V. | A.T. |

| REV | DATE | DRAWING STATUS | DRN | APP |
|-----|------|----------------|-----|-----|
|-----|------|----------------|-----|-----|

TITLE

STORMWATER DRAINAGE PLAN SHEET 5

DRAWING STATUS

FOR APPROVAL

DRAWN

DESIGNED

APPROVED

PROJECT No.

DRAWING No.

REVISION

SCALE

1:100

14676 DA-0007 C

NOT FOR CONSTRUCTION

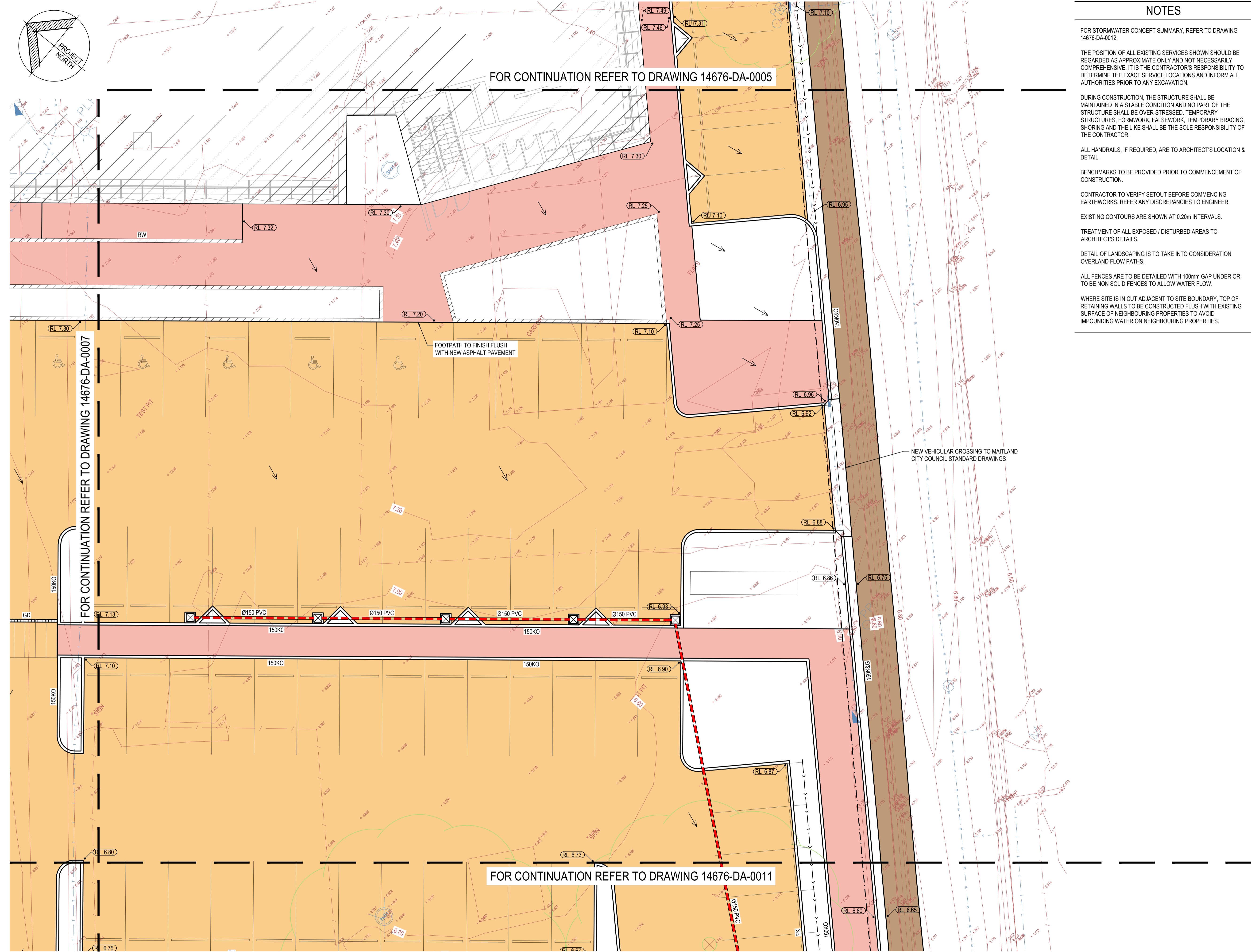

NOTES

FOR STORMWATER CONCEPT SUMMARY, REFER TO DRAWING 14676-DA-0012.

THE POSITION OF ALL EXISTING SERVICES SHOWN SHOULD BE REGARDED AS APPROXIMATE ONLY AND NOT NECESSARILY COMPREHENSIVE. IT IS THE CONTRACTOR'S RESPONSIBILITY TO DETERMINE THE EXACT SERVICE LOCATIONS AND INFORM ALL AUTHORITIES PRIOR TO ANY EXCAVATION.

DURING CONSTRUCTION, THE STRUCTURE SHALL BE MAINTAINED IN A STABLE CONDITION AND NO PART OF THE STRUCTURE SHALL BE OVER-STRESSED. TEMPORARY STRUCTURES, FORMWORK, FALSEWORK, TEMPORARY BRACING, SHORING AND THE LIKE SHALL BE THE SOLE RESPONSIBILITY OF THE CONTRACTOR.

ALL HANDRAILS, IF REQUIRED, ARE TO ARCHITECT'S LOCATION & DETAIL.

BENCHMARKS TO BE PROVIDED PRIOR TO COMMENCEMENT OF CONSTRUCTION.

CONTRACTOR TO VERIFY SETOUT BEFORE COMMENCING EARTHWORKS. REFER ANY DISCREPANCIES TO ENGINEER.

EXISTING CONTOURS ARE SHOWN AT 0.20m INTERVALS.

TREATMENT OF ALL EXPOSED / DISTURBED AREAS TO ARCHITECT'S DETAILS.

DETAIL OF LANDSCAPING IS TO TAKE INTO CONSIDERATION OVERLAND FLOW PATHS.

ALL FENCES ARE TO BE DETAILED WITH 100mm GAP UNDER OR TO BE NON SOLID FENCES TO ALLOW WATER FLOW.

WHERE SITE IS IN CUT ADJACENT TO SITE BOUNDARY, TOP OF RETAINING WALLS TO BE CONSTRUCTED FLUSH WITH EXISTING SURFACE OF NEIGHBOURING PROPERTIES TO AVOID IMPOUNDING WATER ON NEIGHBOURING PROPERTIES.



Sydney | Perth | Newcastle | Central Coast

Suite 2 Ground Floor 47 Darby Street Cooks Hill NSW 2300
T: +61 2 49419900 E: mail@lindsaydynan.com.au

PROJECT

MAITLAND CITY COUNCIL
ADMINISTRATION BUILDING

CLIENT

MAITLAND CITY COUNCIL

LEGEND

- EXISTING CONTOUR
- EXISTING SPOTLEVEL
- DESIGN SPOTLEVEL
- NEW STORMWATER DRAINAGE PIT, INSTALLED TO MANUFACTURER'S SPECIFICATIONS
- NEW PVC STORMWATER DRAINAGE PIPE LAID AT 1.0% MIN FALL (U.N.O.) IN ACCORDANCE WITH MANUFACTURER'S SPECIFICATIONS
- Ø100 SUBSOIL DRAINAGE PIPE C/W FILTER SOCK, LAID AT 1.0% MIN FALL TO OUTLET
- GRATED DRAIN 150 MIN. (WIDE) x 150 MIN. (DEEP), 1% MIN FALL TO OUTLET
- NEW OPEN DRAINAGE SWALE, REFER TO PLAN FOR FURTHER DETAILS
- OVERLAND FLOW PATH
- DIRECTION OF SURFACE FALL
- NEW ASPHALT CARPARK PAVEMENT, DETAILS TO BE PROVIDED AT CC STAGE
- NEW CONCRETE FOOTPATH PAVEMENT, DETAILS TO BE PROVIDED AT CC STAGE
- NEW ASPHALT ROAD PAVEMENT, DETAILS TO BE PROVIDED AT CC STAGE
- NEW RETAINING WALL
- EXISTING ELECTRICAL SERVICE
- EXISTING GAS SERVICE
- EXISTING SEWER SERVICE
- EXISTING TELSTRA SERVICE
- EXISTING WATER SERVICE
- BOUNDARY LINE
- EXISTING FENCE
- EXISTING TREE

| | | | | |
|-------|----------|------------------------|------|------|
| B | 26/03/19 | ISSUED FOR DA APPROVAL | A.V. | A.T. |
| A | 21/03/19 | ISSUED FOR INFORMATION | A.V. | A.T. |
| REV | DATE | DRAWING STATUS | DRN | APP |
| TITLE | | | | |

STORMWATER DRAINAGE PLAN SHEET 6

| | | | |
|----------------|-------------|-----------|------------|
| DRAWING STATUS | | | SHEET SIZE |
| FOR APPROVAL | | | A1 |
| DRAWN | DESIGNED | APPROVED | SCALE |
| A.Vizl | A.Thompson | B.Rodgers | 1:100 |
| PROJECT No. | DRAWING No. | REVISION | |

14676 DA-0008 B

STORMWATER DRAINAGE PLAN - SHEET 6

SCALE 1:100

NOT FOR CONSTRUCTION

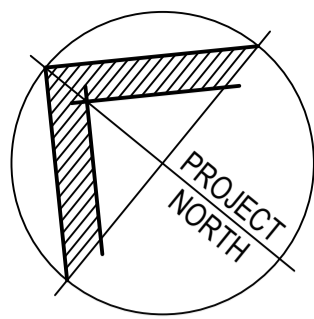

PROJECT
**MAITLAND CITY COUNCIL
ADMINISTRATION BUILDING**

CLIENT
MAITLAND CITY COUNCIL

LEGEND

- 8.00 EXISTING CONTOUR
- EXISTING SPOTLEVEL
- RL 7.00 DESIGN SPOTLEVEL
- NEW STORMWATER DRAINAGE PIT, INSTALLED TO MANUFACTURER'S SPECIFICATIONS
- NEW PVC STORMWATER DRAINAGE PIPE LAID AT 1.0% MIN FALL (U.N.O.) IN ACCORDANCE WITH MANUFACTURER'S SPECIFICATIONS
- Ø100 SUBSOIL DRAINAGE PIPE C/W FILTER SOCK, LAID AT 1.0% MIN FALL TO OUTLET
- GD GRATED DRAIN 150 MIN. (WIDE) x 150 MIN. (DEEP), 1% MIN FALL TO OUTLET
- NEW OPEN DRAINAGE SWALE, REFER TO PLAN FOR FURTHER DETAILS
- OVERLAND FLOW PATH
- DIRECTION OF SURFACE FALL
- NEW ASPHALT CARPARK PAVEMENT, DETAILS TO BE PROVIDED AT CC STAGE
- NEW CONCRETE FOOTPATH PAVEMENT, DETAILS TO BE PROVIDED AT CC STAGE
- NEW ASPHALT ROAD PAVEMENT, DETAILS TO BE PROVIDED AT CC STAGE
- RW NEW RETAINING WALL
- EXISTING ELECTRICAL SERVICE
- EXISTING GAS SERVICE
- EXISTING SEWER SERVICE
- EXISTING TELSTRA SERVICE
- EXISTING WATER SERVICE
- BOUNDARY LINE
- EXISTING FENCE
- EXISTING TREE

NOTES

FOR STORMWATER CONCEPT SUMMARY, REFER TO DRAWING 14676-DA-0012.

THE POSITION OF ALL EXISTING SERVICES SHOWN SHOULD BE REGARDED AS APPROXIMATE ONLY AND NOT NECESSARILY COMPREHENSIVE. IT IS THE CONTRACTOR'S RESPONSIBILITY TO DETERMINE THE EXACT SERVICE LOCATIONS AND INFORM ALL AUTHORITIES PRIOR TO ANY EXCAVATION.

DURING CONSTRUCTION, THE STRUCTURE SHALL BE MAINTAINED IN A STABLE CONDITION AND NO PART OF THE STRUCTURE SHALL BE OVER-STRESSED. TEMPORARY STRUCTURES, FORMWORK, FALSEWORK, TEMPORARY BRACING, SHORING AND THE LIKE SHALL BE THE SOLE RESPONSIBILITY OF THE CONTRACTOR.

ALL HANDRAILS, IF REQUIRED, ARE TO ARCHITECT'S LOCATION & DETAIL.

BENCHMARKS TO BE PROVIDED PRIOR TO COMMENCEMENT OF CONSTRUCTION.

CONTRACTOR TO VERIFY SETOUT BEFORE COMMENCING EARTHWORKS. REFER ANY DISCREPANCIES TO ENGINEER.

EXISTING CONTOURS ARE SHOWN AT 0.20m INTERVALS.

TREATMENT OF ALL EXPOSED / DISTURBED AREAS TO ARCHITECT'S DETAILS.

DETAIL OF LANDSCAPING IS TO TAKE INTO CONSIDERATION OVERLAND FLOW PATHS.

ALL FENCES ARE TO BE DETAILED WITH 100mm GAP UNDER OR TO BE NON SOLID FENCES TO ALLOW WATER FLOW.

WHERE SITE IS IN CUT ADJACENT TO SITE BOUNDARY, TOP OF RETAINING WALLS TO BE CONSTRUCTED FLUSH WITH EXISTING SURFACE OF NEIGHBOURING PROPERTIES TO AVOID IMPOUNDING WATER ON NEIGHBOURING PROPERTIES.

FOR CONTINUATION REFER TO DRAWING 14676-DA-0006

FOR CONTINUATION REFER TO DRAWING 14676-DA-0010

STORMWATER DRAINAGE PLAN - SHEET 7

SCALE 1:100

NOT FOR CONSTRUCTION

| | | | | |
|-----|----------|---------------------------|------|------|
| C | 23/03/19 | RE-ISSUED FOR DA APPROVAL | A.T. | A.T. |
| B | 26/03/19 | ISSUED FOR DA APPROVAL | A.V. | A.T. |
| A | 21/03/19 | ISSUED FOR INFORMATION | A.V. | A.T. |
| REV | DATE | DRAWING STATUS | DRN | APP |

**STORMWATER DRAINAGE PLAN
SHEET 7**

| | | | | |
|----------------|------------|-------------|------------|--|
| DRAWING STATUS | | | SHEET SIZE | |
| FOR APPROVAL | | | A1 | |
| DRAWN | DESIGNED | APPROVED | SCALE | |
| A.Vizl | A.Thompson | B.Rodgers | 1:100 | |
| PROJECT No. | | DRAWING No. | REVISION | |
| 14676 | | DA-0009 | C | |

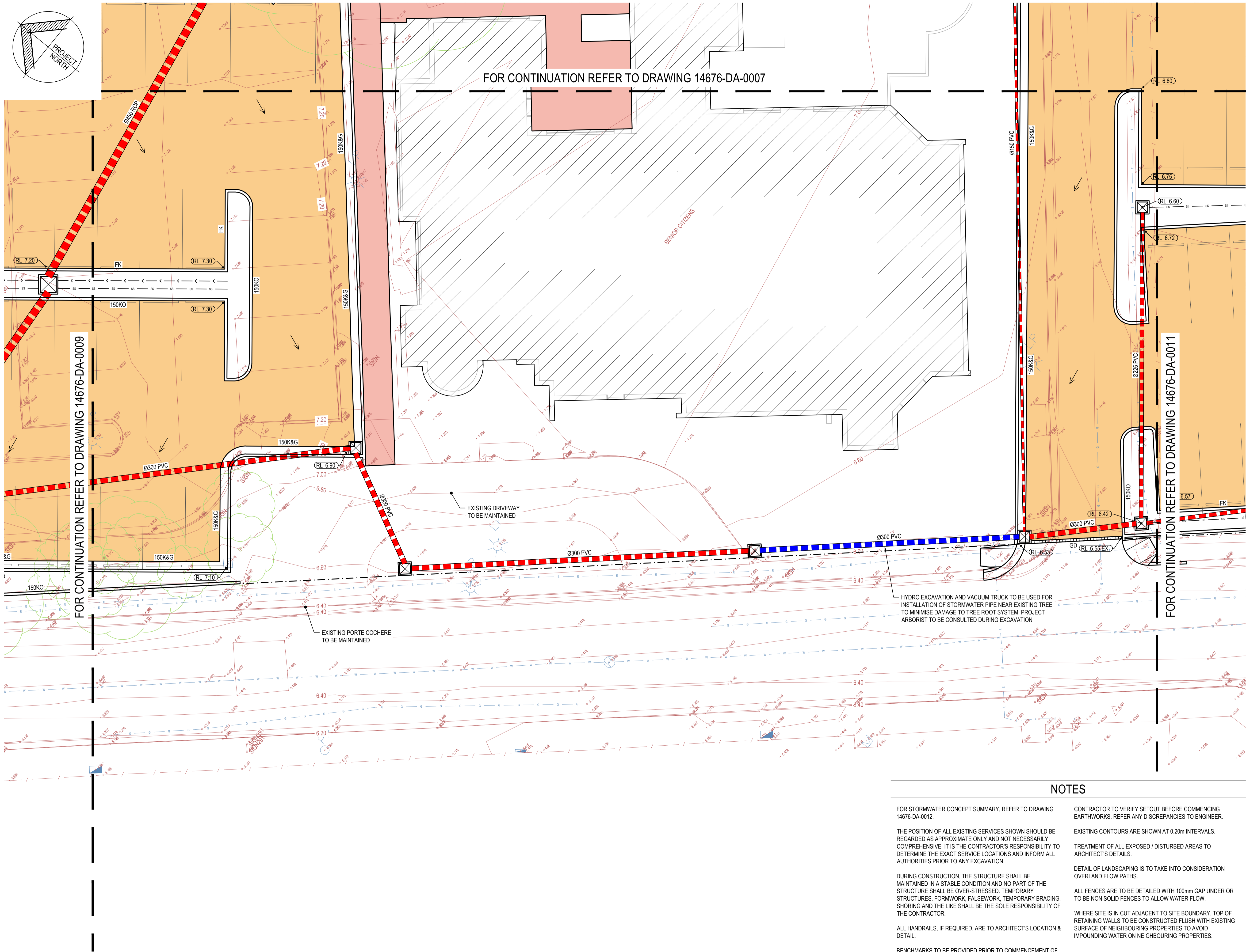
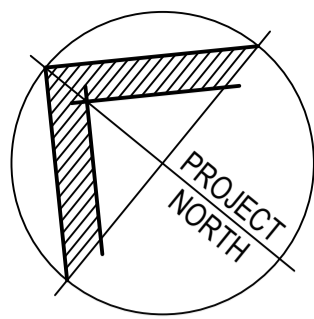

LEGEND

- 8.00 EXISTING CONTOUR
- EXISTING SPOTLEVEL
- RL 7.00 DESIGN SPOTLEVEL
- NEW STORMWATER DRAINAGE PIT, INSTALLED TO MANUFACTURER'S SPECIFICATIONS
- NEW PVC STORMWATER DRAINAGE PIPE LAID AT 1.0% MIN FALL (U.N.O.) IN ACCORDANCE WITH MANUFACTURER'S SPECIFICATIONS
- Ø100 SUBSOIL DRAINAGE PIPE C/W FILTER SOCK, LAID AT 1.0% MIN FALL TO OUTLET
- GD GRATED DRAIN 150 MIN. (WIDE) x 150 MIN. (DEEP), 1% MIN FALL TO OUTLET
- NEW OPEN DRAINAGE SWALE, REFER TO PLAN FOR FURTHER DETAILS
- OVERLAND FLOW PATH
- DIRECTION OF SURFACE FALL
- NEW ASPHALT CARPARK PAVEMENT, DETAILS TO BE PROVIDED AT CC STAGE
- NEW CONCRETE FOOTPATH PAVEMENT, DETAILS TO BE PROVIDED AT CC STAGE
- NEW ASPHALT ROAD PAVEMENT, DETAILS TO BE PROVIDED AT CC STAGE
- RW NEW RETAINING WALL
- EXISTING ELECTRICAL SERVICE
- EXISTING GAS SERVICE
- EXISTING SEWER SERVICE
- EXISTING TELSTRA SERVICE
- EXISTING WATER SERVICE
- BOUNDARY LINE
- EXISTING FENCE
- EXISTING TREE

NOTES

FOR STORMWATER CONCEPT SUMMARY, REFER TO DRAWING 14676-DA-0012.

THE POSITION OF ALL EXISTING SERVICES SHOWN SHOULD BE REGARDED AS APPROXIMATE ONLY AND NOT NECESSARILY COMPREHENSIVE. IT IS THE CONTRACTOR'S RESPONSIBILITY TO DETERMINE THE EXACT SERVICE LOCATIONS AND INFORM ALL AUTHORITIES PRIOR TO ANY EXCAVATION.

DURING CONSTRUCTION, THE STRUCTURE SHALL BE MAINTAINED IN A STABLE CONDITION AND NO PART OF THE STRUCTURE SHALL BE OVER-STRESSED. TEMPORARY STRUCTURES, FORMWORK, FALSEWORK, TEMPORARY BRACING, SHORING AND THE LIKE SHALL BE THE SOLE RESPONSIBILITY OF THE CONTRACTOR.

ALL HANDRAILS, IF REQUIRED, ARE TO ARCHITECT'S LOCATION & DETAIL.

BENCHMARKS TO BE PROVIDED PRIOR TO COMMENCEMENT OF CONSTRUCTION.

CONTRACTOR TO VERIFY SETOUT BEFORE COMMENCING EARTHWORKS. REFER ANY DISCREPANCIES TO ENGINEER.

EXISTING CONTOURS ARE SHOWN AT 0.20m INTERVALS.

TREATMENT OF ALL EXPOSED / DISTURBED AREAS TO ARCHITECT'S DETAILS.

DETAIL OF LANDSCAPING IS TO TAKE INTO CONSIDERATION OVERLAND FLOW PATHS.

ALL FENCES ARE TO BE DETAILED WITH 100mm GAP UNDER OR TO BE NON SOLID FENCES TO ALLOW WATER FLOW.

WHERE SITE IS IN CUT ADJACENT TO SITE BOUNDARY, TOP OF RETAINING WALLS TO BE CONSTRUCTED FLUSH WITH EXISTING SURFACE OF NEIGHBOURING PROPERTIES TO AVOID IMPOUNDING WATER ON NEIGHBOURING PROPERTIES.

| | | | | |
|-------|----------|------------------------|------|------|
| B | 26/03/19 | ISSUED FOR DA APPROVAL | A.V. | A.T. |
| A | 21/03/19 | ISSUED FOR INFORMATION | A.V. | A.T. |
| REV | DATE | DRAWING STATUS | DRN | APP |
| TITLE | | | | |

**STORMWATER DRAINAGE PLAN
SHEET 8**

| | | | | |
|----------------|------------|-------------|------------|--|
| DRAWING STATUS | | | SHEET SIZE | |
| FOR APPROVAL | | | A1 | |
| DRAWN | DESIGNED | APPROVED | SCALE | |
| A.Vizl | A.Thompson | B.Rodgers | 1:100 | |
| PROJECT No. | | DRAWING No. | REVISION | |

14676 DA-0010 B

STORMWATER DRAINAGE PLAN - SHEET 8

SCALE 1:100

NOT FOR CONSTRUCTION

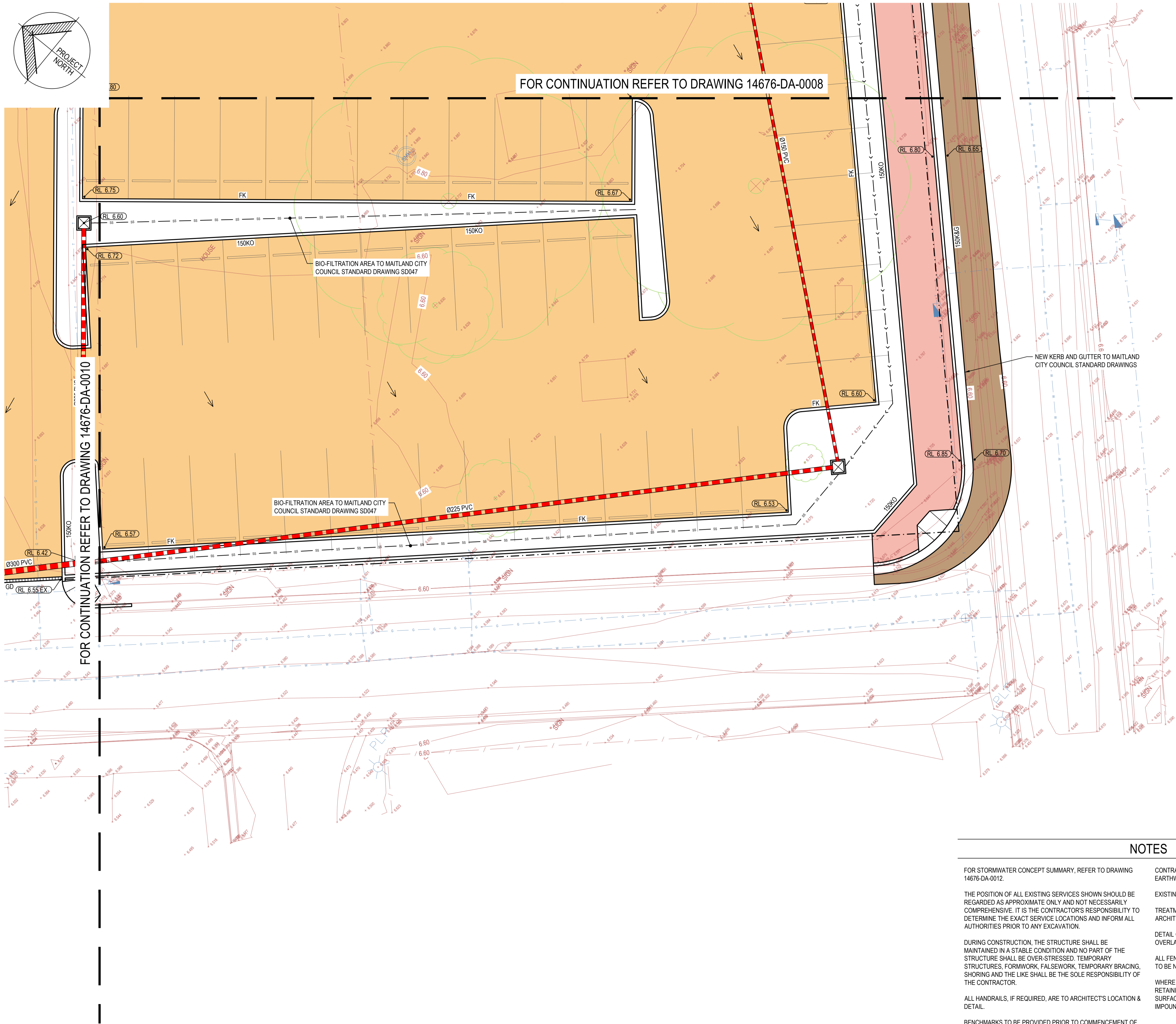
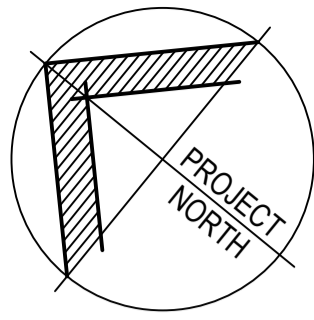

Sydney | Perth | **Newcastle** | Central Coast

Suite 2 Ground Floor 47 Darby Street Cooks Hill NSW 2300
T: +61 2 49419900 E: mail@lindsaydynan.com.au

PROJECT
**MAITLAND CITY COUNCIL
ADMINISTRATION BUILDING**

CLIENT
MAITLAND CITY COUNCIL

LEGEND

- 8.00 EXISTING CONTOUR
- EXISTING SPOTLEVEL
- RL 7.00 DESIGN SPOTLEVEL
- NEW STORMWATER DRAINAGE PIT, INSTALLED TO MANUFACTURER'S SPECIFICATIONS
- NEW PVC STORMWATER DRAINAGE PIPE LAID AT 1.0% MIN FALL (U.N.O.) IN ACCORDANCE WITH MANUFACTURER'S SPECIFICATIONS
- Ø100 SUBSOIL DRAINAGE PIPE C/W FILTER SOCK, LAID AT 1.0% MIN FALL TO OUTLET
- GD GRATED DRAIN 150 MIN. (WIDE) x 150 MIN. (DEEP), 1% MIN FALL TO OUTLET
- NEW OPEN DRAINAGE SWALE, REFER TO PLAN FOR FURTHER DETAILS
- OVERLAND FLOW PATH
- DIRECTION OF SURFACE FALL
- NEW ASPHALT CARPARK PAVEMENT, DETAILS TO BE PROVIDED AT CC STAGE
- NEW CONCRETE FOOTPATH PAVEMENT, DETAILS TO BE PROVIDED AT CC STAGE
- NEW ASPHALT ROAD PAVEMENT, DETAILS TO BE PROVIDED AT CC STAGE
- RW NEW RETAINING WALL
- EXISTING ELECTRICAL SERVICE
- EXISTING GAS SERVICE
- EXISTING SEWER SERVICE
- EXISTING TELSTRA SERVICE
- EXISTING WATER SERVICE
- BOUNDARY LINE
- EXISTING FENCE
- EXISTING TREE

NOTES

FOR STORMWATER CONCEPT SUMMARY, REFER TO DRAWING 14676-DA-0012.

THE POSITION OF ALL EXISTING SERVICES SHOWN SHOULD BE REGARDED AS APPROXIMATE ONLY AND NOT NECESSARILY COMPREHENSIVE. IT IS THE CONTRACTOR'S RESPONSIBILITY TO DETERMINE THE EXACT SERVICE LOCATIONS AND INFORM ALL AUTHORITIES PRIOR TO ANY EXCAVATION.

DURING CONSTRUCTION, THE STRUCTURE SHALL BE MAINTAINED IN A STABLE CONDITION AND NO PART OF THE STRUCTURE SHALL BE OVER-STRESSED. TEMPORARY STRUCTURES, FORMWORK, FALSEWORK, TEMPORARY BRACING, SHORING AND THE LIKE SHALL BE THE SOLE RESPONSIBILITY OF THE CONTRACTOR.

ALL HANDRAILS, IF REQUIRED, ARE TO ARCHITECT'S LOCATION & DETAIL.

BENCHMARKS TO BE PROVIDED PRIOR TO COMMENCEMENT OF CONSTRUCTION.

CONTRACTOR TO VERIFY SETOUT BEFORE COMMENCING EARTHWORKS. REFER ANY DISCREPANCIES TO ENGINEER.

EXISTING CONTOURS ARE SHOWN AT 0.20m INTERVALS.

TREATMENT OF ALL EXPOSED / DISTURBED AREAS TO ARCHITECT'S DETAILS.

DETAIL OF LANDSCAPING IS TO TAKE INTO CONSIDERATION OVERLAND FLOW PATHS.

ALL FENCES ARE TO BE DETAILED WITH 100mm GAP UNDER OR TO BE NON SOLID FENCES TO ALLOW WATER FLOW.

WHERE SITE IS IN CUT ADJACENT TO SITE BOUNDARY, TOP OF RETAINING WALLS TO BE CONSTRUCTED FLUSH WITH EXISTING SURFACE OF NEIGHBOURING PROPERTIES TO AVOID IMPOUNDING WATER ON NEIGHBOURING PROPERTIES.

| | | | | |
|-------|----------|------------------------|------|------|
| B | 26/03/19 | ISSUED FOR DA APPROVAL | A.V. | A.T. |
| A | 21/03/19 | ISSUED FOR INFORMATION | A.V. | A.T. |
| REV | DATE | DRAWING STATUS | DRN | APP |
| TITLE | | | | |

STORMWATER DRAINAGE PLAN SHEET 9

| | | | | |
|----------------|------------|-------------|------------|--|
| DRAWING STATUS | | | SHEET SIZE | |
| FOR APPROVAL | | | A1 | |
| DRAWN | DESIGNED | APPROVED | SCALE | |
| A.Vizl | A.Thompson | B.Rodgers | 1:100 | |
| PROJECT No. | | DRAWING No. | REVISION | |

14676 DA-0011 B

STORMWATER DRAINAGE PLAN - SHEET 9

SCALE 1:100

NOT FOR CONSTRUCTION

CONCEPT SUMMARY

THE PROPOSED DEVELOPMENT IS LOCATED AT 263-283 HIGH STREET MAITLAND AND WILL CONSIST OF THE CONSTRUCTION OF THE NEW CITY ADMINISTRATION CENTRE ALONG WITH A NEW CARPARK AND ASSOCIATED LANDSCAPING.

ALL RUNOFF FROM NEW ROOF AREAS WILL BE DIRECTED TO A BELOW GROUND OSD SYSTEM VIA CHARGED DOWNPIPES.

THE NEW OSD SYSTEM HAS BEEN DESIGNED LIMIT PEAK DISCHARGE TO PRE DEVELOPMENT DISCHARGE FOR ALL STORM EVENTS UP TO AND INCLUDING THE 1% AEP EVENT AND WILL OUTLET VIA A HIGH AND LOW FLOW SYSTEM TO THE NEW PIT AND PIPE NETWORK PROVIDED IN THE CARPARK.

MINOR FLOWS GENERATED ACROSS THE CARPARK UP TO AND INCLUDING THE 10% AEP WILL BE DIRECTED TO A SERIES OF BIORETENTION BASINS AND SWALES WHERE POSSIBLE AND CAPTURED BY A NETWORK OF PITS AND PIPES.

THE PIT AND PIPE NETWORK WILL DISCHARGE TO THE PROPOSED STORMWATER NETWORK ON GRANT STREET VIA A SUBSURFACE PIPE.

FOR ALL STORMWATER CALCULATIONS PLEASE REFER TO THE ATTACHED DRAINS MODEL.



SCALE 1:20



SCALE 1:20



SCALE 1:20



SCALE 1:2



SCALE 1:20



SCALE 1:10



SCALE 1:10



SCALE 1:10



SCALE 1:10



SCALE 1:20

STORMWATER DRAINAGE DETAILS

| | | |
|-------|---------|---|
| 14676 | DA-0012 | A |
|-------|---------|---|

NOT FOR CONSTRUCTION

14676

DA-0012

A

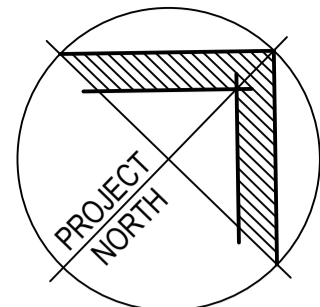

PROJECT
**MAITLAND CITY COUNCIL
ADMINISTRATION BUILDING**

CLIENT
MAITLAND CITY COUNCIL

LEGEND

- RL 7.10** DESIGN SPOTLEVEL
- NEW STORMWATER DRAINAGE PIT, INSTALLED TO MANUFACTURER'S SPECIFICATIONS
- NEW PVC STORMWATER DRAINAGE PIPE LAID AT 1.0% MIN FALL (U.N.O.) IN ACCORDANCE WITH MANUFACTURER'S SPECIFICATIONS
- Ø100 SUBSOIL DRAINAGE PIPE C/W FILTER SOCK, LAID AT 1.0% MIN FALL TO OUTLET
- NEW OPEN DRAINAGE SWALE, REFER TO PLAN FOR FURTHER DETAILS
- DIRECTION OF SURFACE FALL
- NEW ASPHALT CARPARK PAVEMENT, DETAILS TO BE PROVIDED AT CC STAGE
- NEW FOOTPATH PAVEMENT, DETAILS TO BE PROVIDED AT CC STAGE
- NEW ASPHALT ROAD PAVEMENT, DETAILS TO BE PROVIDED AT CC STAGE
- EXISTING GAS SERVICE
- EXISTING TELSTRA SERVICE
- EXISTING WATER SERVICE
- BOUNDARY LINE
- EXISTING FENCE
- EXISTING TREE

NOTES

- THE POSITION OF ALL EXISTING SERVICES SHOWN SHOULD BE REGARDED AS APPROXIMATE ONLY AND NOT NECESSARILY COMPREHENSIVE. IT IS THE CONTRACTOR'S RESPONSIBILITY TO DETERMINE THE EXACT SERVICE LOCATIONS AND INFORM ALL AUTHORITIES PRIOR TO ANY EXCAVATION.
- DURING CONSTRUCTION, THE STRUCTURE SHALL BE MAINTAINED IN A STABLE CONDITION AND NO PART OF THE STRUCTURE SHALL BE OVER-STRESSED. TEMPORARY STRUCTURES, FORMWORK, FALSEWORK, TEMPORARY BRACING, SHORING AND THE LIKE SHALL BE THE SOLE RESPONSIBILITY OF THE CONTRACTOR.
- ALL HANDRAILS, IF REQUIRED, ARE TO ARCHITECT'S LOCATION & DETAIL.
- BENCHMARKS TO BE PROVIDED PRIOR TO COMMENCEMENT OF CONSTRUCTION.
- CONTRACTOR TO VERIFY SETOUT BEFORE COMMENCING EARTHWORKS. REFER ANY DISCREPANCIES TO ENGINEER.
- EXISTING CONTOURS ARE SHOWN AT 0.20m INTERVALS.
- TREATMENT OF ALL EXPOSED / DISTURBED AREAS TO ARCHITECT'S DETAILS.
- DETAIL OF LANDSCAPING IS TO TAKE INTO CONSIDERATION OVERLAND FLOW PATHS.
- ALL FENCES ARE TO BE DETAILED WITH 100mm GAP UNDER OR TO BE NON SOLID FENCES TO ALLOW WATER FLOW.
- WHERE SITE IS IN CUT ADJACENT TO SITE BOUNDARY, TOP OF RETAINING WALLS TO BE CONSTRUCTED FLUSH WITH EXISTING SURFACE OF NEIGHBOURING PROPERTIES TO AVOID IMPOUNDING WATER ON NEIGHBOURING PROPERTIES.

| | | | | |
|-------|----------|------------------------|------|------|
| A | 26/03/19 | ISSUED FOR DA APPROVAL | A.V. | A.T. |
| REV | DATE | DRAWING STATUS | DRN | APP |
| TITLE | | | | |

EXTERNAL WORKS PLAN

| | | | | |
|----------------|------------|-------------|------------|--|
| DRAWING STATUS | | | SHEET SIZE | |
| FOR APPROVAL | | | A1 | |
| DRAWN | DESIGNED | APPROVED | SCALE | |
| A.Vizl | A.Thompson | B.Rodgers | 1:100 | |
| PROJECT No. | | DRAWING No. | REVISION | |
| 14676 | | DA-0020 | A | |

NOT FOR CONSTRUCTION

EXTERNAL WORKS PLAN - PART A

SCALE 1:100

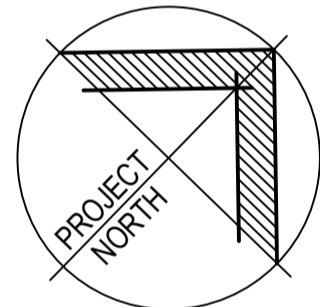

FOR CONTINUATION REFER TO ABOVE

EXTERNAL WORKS PLAN - PART B

SCALE 1:100